

⊕ "Loctite 222"  
 ● "Loctite 270"

⊕ 13 / 18	*	1.4Nm
31 / 18	↻	10Nm
31 / 24	↻	10Nm
⊕ 28 / 11	↻	35Nm
28 / 25	↻	35Nm
35 / 30	↻	35Nm
⊕ 1 / 11	↻	25Nm
● 32 / 34 - 42	↻	11Nm

⬅ Tightening direction  
 Sens de serrage  
 Sentido de apriete  
 Anziehrichtung  
 Senso di serraggio  
 Sentido de aperto  
 Kiristysuunta  
 Atdragningsriktning  
 Tilstrammingsretning  
 Tilspændingsretning  
 Schroefrichting  
 Φορά σύφιξης

H	mm
H maxi	6.6
H mini	5.6

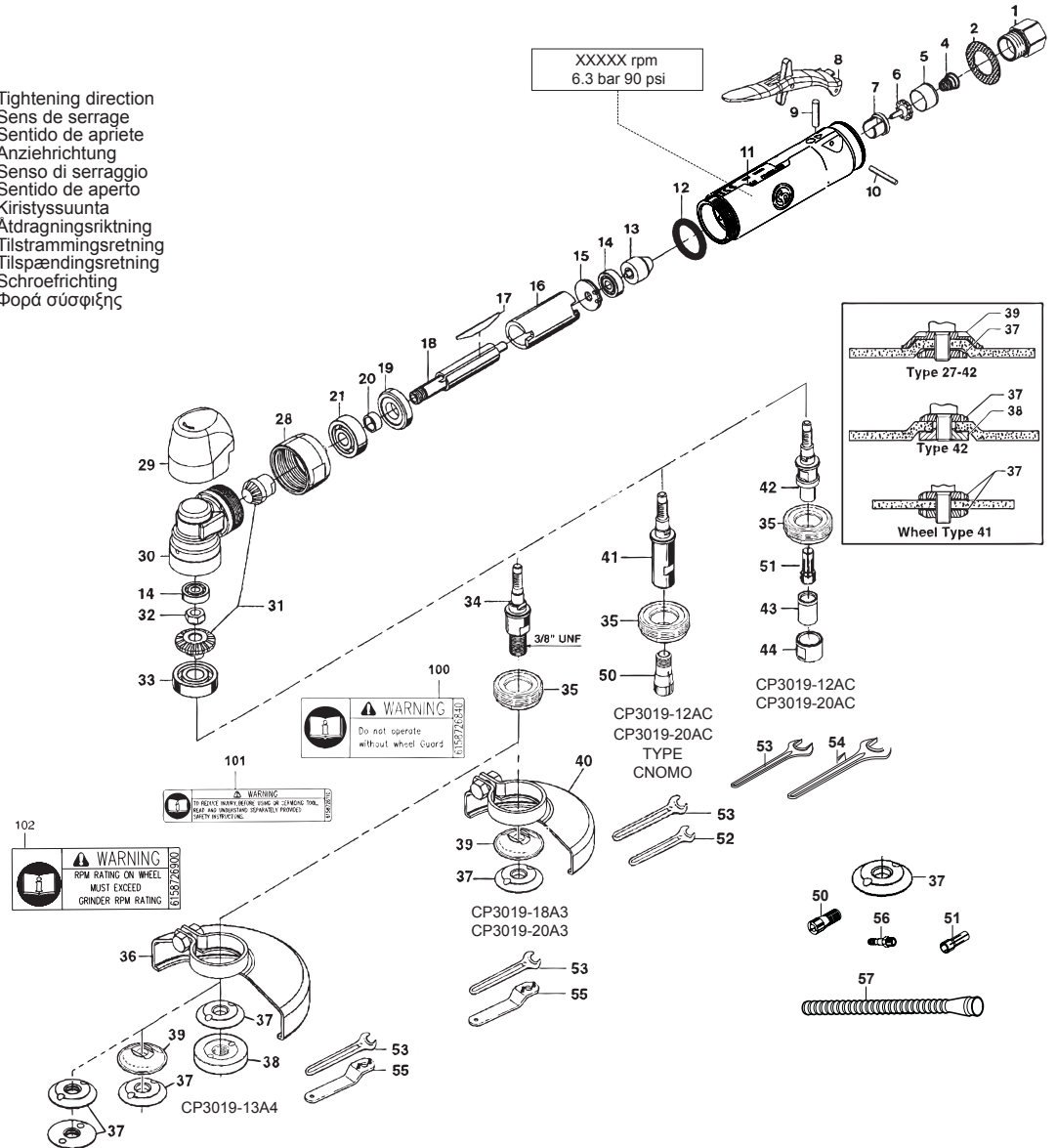

Item	Part No	Description	Qty
<b>A</b>	2050542053	<b>AIR INLET KIT</b>	
1	-	Adapter complete 1/4"	1
2	-	Silencer	1
<b>B</b>	2050542063	<b>THROTTLE KIT</b>	
4	-	Spring valve	1
5	-	Tube inlet	1
6	-	Throttle valve	1
7	-	Seat valve	1
<b>C</b>	2050542073	<b>LEVER KIT</b>	
8	-	Throttle lever	1
9	-	Pin	1
10	-	Pin	1
<b>D</b>	2050542083	<b>REAR PLATE KIT</b>	
14	758.63	Ball bearing	1
15	-	Rear end plate	1
<b>E</b>	2050542093	<b>FRONT PLATE KIT</b>	
19	-	Front end plate	1
21	758.113	Ball bearing CP3019-..	1
20	-	Collar rotor	1
<b>F</b>	2050542103	<b>MOTOR KIT</b>	
12	-	O-Ring	1
<b>D</b>	2050542083	<b>REAR PLATE KIT</b>	
<b>E</b>	2050542093	<b>FRONT PLATE KIT</b>	
16	400.134	Cylinder	1
17	434.55	Blade	3
18	426.92	Rotor	1
<b>G</b>	2050541693	<b>COLLET CLAMP KIT</b>	
43	-	Cap (CP3019-..AC)	1
44	-	Nut (CP3019-..AC)	1

Item	Part No	Description	Qty
<b>H</b>	2050541313	<b>BEVEL GEAR KIT</b>	
14	758.63	Ball bearing	1
31	-	Gear-bevel	1
32	-	Nut	1
33	758.117	Ball bearing	1
<b>I</b>	2050541323	<b>ANGLE HEAD KIT CP3019-..A3, A4</b>	
<b>H</b>	2050541313	<b>BEVEL GEAR KIT</b>	
29	6155704290	Sleeve protection	1
30	595.230	Housing angle	1
34	-	Spindle-wheel 3/8" (CP3019-..A3, CP3019-..A4)	1
35	-	Cap-angle housing	1
<b>J</b>	2050541333	<b>ANGLE HEAD KIT CP3019-..AC</b>	
<b>H</b>	2050541313	<b>BEVEL GEAR KIT</b>	
<b>G</b>	2050541413	<b>COLLET CLAMP KIT</b>	
29	6155704290	Sleeve protection	1
30	595.230	Housing angle	1
35	-	Cap-angle housing	1
42	2050541433	Spindle-Collet (CP3019-..AC)	1
51	6155260590	Serie 300 resilient collet ø1/4"	1
<b>K</b>	2050559713	<b>ANGLE HEAD KIT CP3019 Cnomo</b>	
<b>H</b>	2050541313	<b>BEVEL GEAR KIT</b>	
<b>G</b>	2050541413	<b>COLLET CLAMP KIT</b>	
29	6155704290	Sleeve protection	1
30	595.230	Housing angle	1
35	-	Cap-angle housing	1
41	6155011040	CNOMO collet holder	1
50	6155260460	Collet ø633 for CP3019 Cnomo	1

Item	Part No	Description	Qty
11	2050542193	Motor housing Kit	1
13	457.30	Governor CP3019-20AC, CP3019-20A3	1
13	457.29	Governor CP3019-12AC	1
13	457.25	Governor CP3019-13A4	1
13	457.31	Governor CP3019-18A3	1
21	758.113	Ball bearing	1
28	730.179	Sleeve alignment	1
36	6155041600	Wheel guard 4" (CP3019-..A4)	1
37	6155020640	Flange (CP3019-..A3)	1
37	6155020640	Flange (CP3019-..A4)	2
38	6156065150	Rear flange (CP3019-..A4)	1
39	6155031440	Rear flange	1
40	6155041550	Wheel guard 3" (CP3019-..A3)	1
52	6158010020	Flat Wrench 3/8" for Cnomo tools	1
53	6158010030	Flat Wrench 11/16"	1
54	6158010320	Flat wrench 11/16"	1
55	6158020080	Pin wrench	1
56	6157040190	Air hose nipple 1/4" for 5/6" ID hose	1
57	6158751060	Exhaust hose L=31"	1
100	6158726840	Warning guard label	1
101	6158726110	Warning instruction label	1
102	6158726900	Warning wheel speed label	1
<b>TUNE UP KIT</b>			
	2050542133	Including Part No. 2, 12, 17, 9, 10, 21, 33	1

	<b>2050541913</b>	<b>Operator's manual</b>
	<b>6159948750</b>	<b>Safety instructions die-grinder</b>
	<b>6159948760</b>	<b>Safety instructions grinder</b>
	<b>2050541103</b>	<b>EC declaration die-grinder</b>
	<b>2050541213</b>	<b>EC declaration grinder</b>