

WARNING
 TO AVOID RISK OF BLASTING FORCE AND OVERHEATING
 ALWAYS WEAR PROTECTIVE GEAR AND USE TOOL
 TO AVOID BLASTING USE RECOMMENDED GRADE
 OF PARTICLES ON WHEEL. ALWAYS EXHAUST OUTSIDE!
 Chicago Pneumatic

* Tightening direction
 Sens de serrage
 Sentido de apriete
 Anziehrichtung
 Senso di serraggio
 Sentido de aperto
 Kiristysuunta
 Atdragningsriktning
 Tilstrammingsretning
 Tilspændingsretning
 Schroefrichting
 Φορά σύσφιξης
 上紧方向
 Meghúzás iránya
 Pievilkšanas virziens
 Kierunek dokręcania
 Směr utahování
 Smer zatesnjevanja
 Sukimo kryptis
 Направление затяжки

b) 50 / 32		60 Nm
b) 33 / 32		3 Nm
c) 20 / 25		2 Nm
a) 13 / 6		3 Nm
d) 1 / 32		30 Nm
46 / 41		30 Nm
46 / 42		30 Nm
46 / 43		30 Nm
38 / 25		30 Nm

a) : "Loctite 222"
 b) : "Loctite 243"
 c) : "Loctite 641"
 d) : "Loctite 270"

	mm
H maxi	10.85
H mini	9.8

	rpm
CP3650-135AC4SE	13500
CP3650-120AAE	12000
CP3650-085AAE	8500
CP3650-085AB	8500
CP3650-075AAE	7500

Index No.	Part No.	Description	Qty.	Index No.	Part No.	Description	Qty.
A	2050556023	Silencer Kit		G	6153933290	Housing Complete Kit 7500RPM	
2		Silencer	1	32		Housing	1
3		O-Ring	1	33		Stopfinger Complete	1
5		Valve	1	53		Greaser	1
B	6153967360	Bushing Complete		31		Insulator 7500RPM	1
14		Bushing	1	37		External cover	1
15		O-Ring	1	51		Left side brand name plate	1
16		Pin	1	52		Warning label	1
17		O-Ring	1	36		Cover	1
C	2050556033	Valve Kit		1		Adaptater	1
8		Spring Conical	1	39	396.001	Grease Kit - 5g	1
9		Ball	1	H	399.480	Bevel Gear paired set (120AAE/135AC4SE)	
10		Valve seat	1	38		Bevel gear	1
11		O-Ring	1	39		Grease Kit - 5g	1
D	2050556043	Rear Endplate Kit		H	6153971710	Bevel Gear paired set (075AAE/085AAE)	
21		Bearing	1	38		Bevel gear	1
22		Rear Endplate	1	39		Grease Kit - 5g	1
E	2050556063	Blades Kit		I	2050556083	Output Bearing Kit	
24		Blade	4	40		Bearing	1
F	2050556053	Front Endplate Kit		46		Nut	1
27		Front Endplate	1	47		Deflecotr	1
28		Plate Spacer	1	48		Bearing	1
29		O-Ring	1	J	2050556073	Motor Bearing Kit	
30		Bearing	1	30		Bearing	1
G	6153933330	Housing Complete Kit 13500RPM		21		Bearing	1
32		Housing	1	L	2050556013	Small parts kit	
33		Stopfinger Complete	1	46		Nut	1
53		Greaser	1	47		Deflector	1
31		Insulator 13500RPM	1	23		Pin	1
37		External cover	1	19		Pin	1
51		Left side brand name plate	1	4		Spring Cylindrical	1
52		Warning label	1	1	6153967390	Adapter	1
36		Cover	1	6	6154300330	Inlet	1
1		Adaptater	1	7	6156452290	Disc Spring	1
39	396.001	Grease Kit - 5g	1	12	6155960040	Lever Bracket	1
G	6153933320	Housing Complete Kit 12000RPM		18	6153967350	Safety lever	1
32		Housing	1	20	6154570500	Governor 15K (for 075AAE)	1
33		Stopfinger Complete	1	20	6154570540	Governor 17K (for 085AAE / 085AB)	1
53		Greaser	1	20	6154570490	Governor 19K (for 120AAE)	1
31		Insulator 12000RPM	1	20	6154570520	Governor 21K (for 135AC4SE)	1
37		External cover	1	25	6154261200	Rotor	1
51		Left side brand name plate	1	26	6154001480	Cylinder	1
52		Warning label	1	42	507.87	Shaft M14	1
36		Cover	1	43	501.88	Shaft 5/8"	1
1		Adaptater	1	46	605.86	Nut	1
39	396.001	Grease Kit - 5g	1	50	673.98	Plug	1
G	6153933300	Housing Complete Kit 8500RPM		K	2050556003	Tune Up Kit	
32		Housing	1	2050556063		Blade Kit	1
33	6153974060	Stopfinger Complete	1	3		O-Ring	1
53		Greaser	1	11		O-Ring	1
31		Insulator 8500RPM	1	15		O-Ring	1
37		External cover	1	17		O-Ring	1
51		Left side brand name plate	1	29		O-Ring	1
52		Warning label	1				
36		Cover	1				
1		Adaptater	1				
39	396.001	Grease Kit - 5g	1				
					6159948770	SAFETY INSTRUCTIONS SANDERS	
					2050554963	OPERATOR'S MANUAL	
					2050554993	EC DECLARATION SANDER	

ACCESSORIES INCLUDED

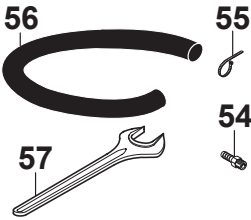
CP3650 - 120AAE CP3650 - 075AAE CP3650 - 085AAE CP3650 - 135AC4SE	Item	Part no.	Qty	Description
	54	6157040270	1	3/8" air hose nipple for 1/2" (13mm) ID hose
	55	6152630240	2	Hose clamp
	56	6158751130	1	Exhaust hose (-7dB)
	57	6158010320	1	Spanner wrench 17mm

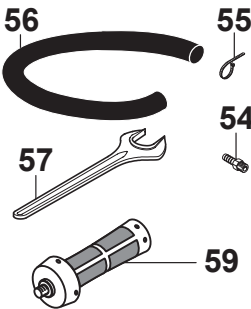
CP3650	Item	Part no.	Qty	Description
	54	6157040270	1	3/8" air hose nipple for 1/2" (13mm) ID hose
	55	6152630240	2	Hose clamp
	56	6158751130	1	Exhaust hose
	57	6158010320	1	Spanner wrench 17mm
	59	6155760660	1	Vibration-damping side handle

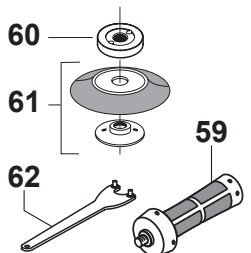
CP3650-135AC4SE	Item	Part no.	Qty	Description
	59	6155760660	1	Vibration-damping side handle
	60	6156065150	1	Flange
	61	6159901670	1	Backing with nut
	62	6158020080	1	Pin wrench

OPTIONAL ACCESSORIES

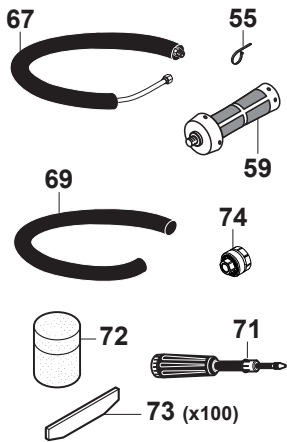

Item	Part no.	Qty	Description
55	6152630240	1	Hose clamp
59	6155760660	2	Vibration-damping side handle
67	6153961660	1	Silencer kit with hose clamp (55) (-11 dB)
69	6158751160	1	Reinforced cloth-lined exhaust hose L=30"
71	6159901490	1	Grease gun included (24g)
72	6159901480	1	Grease for bevel gear (1kg)
73	6154340640	1	Blades kit (x100)
74	6153969570	1	Clippable silencer (-6 dB)

Dust extraction kit Ø5" (125mm) for composite (non metal and metal sanding)

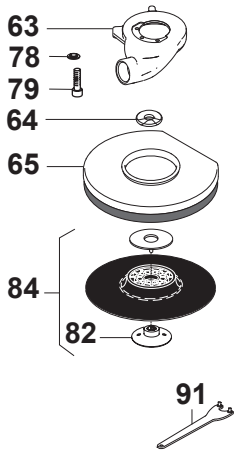

Item	Part no.	Qty	Description
	6153978280	1	Complete kit
63	6155041940	1	Suction cap
64	6156430880	1	Spacer 15mm (5/8")
64	6156430870	1	Spacer 15mm (M14)
65	6155702340	1	Skirt with brush 5"
78	6156451420	2	Washer
79	616.99	2	Screw
84	6159901270	1	Ventilated backing pad 5" with nut M14 & 5/8" (82) (max. speed 12000rpm)
91	6158020670	1	Pin wrench 1-3/8"
82	6156060450	1	Nut (5/8")
82	6156060460	1	Nut (M14)

Dust extraction kit for diamond disc Ø5" (125mm)

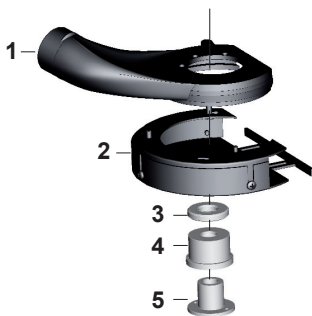

Item	Part no.	Qty	Description
	6153978300	1	Complete kit
1	6155042170	1	Manifold cutting with screws
2	6155042180	1	Goble cover plate complete
3	6156430920	1	Spacer 6mm - Hole 14mm
3	6156430910	1	Spacer 6mm - Hole 16mm
4	6156430890	1	Spacer for M14 spindle
4	6156430900	1	Spacer for 5/8" spindle
5	6156060460	1	Flange nut M14
5	6156060450	1	Flange nut 5/8"
.	6158020670	1	Pin key

Sanding kit for standard abrasive disc Ø5" (125mm) - for CE version only - CP3650-135AC4SE/ CP3650-120AAE / CP3650-075AAE / CP3650-085AAE

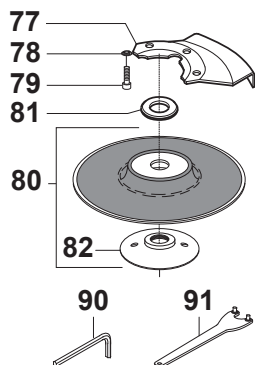

Item	Part no.	Qty	Description
	6153960720	1	Complete kit
77	6155041450	1	Finger guard
78	6156451420	1	Washer
79	616.99	1	Screw
80	6159901270	1	Ventilated backing pad 5" with nut M14 & 5/8" (82) (max. speed 12000rpm)
81	6156410270	2	M14 washer
81	6156420500	2	5/8" washer
82	606.22	1	Nut M14
82	608.29	1	Nut 5/8"
90	6158020610	1	Hex key 5/16"
91	6158020100	1	Pin wrench 1-3/8"

Sanding kit for semi-rigid disc Ø5" (125mm) - for CE version only - CP3650-135AC4SE/ CP3650-120AAE / CP3650-075AAE / CP3650-085AAE

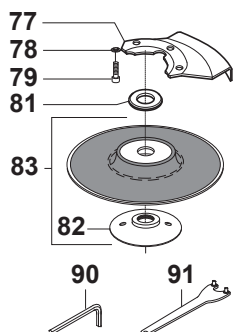

Item	Part no.	Qty	Description
	6153960750	1	Complete kit
77	6155041450	1	Finger guard
78	6156451420	1	Washer
79	616.99	1	Screw
81	6156410270	2	M14 washer
82	606.22	1	Nut M14
83	6159901290	1	Complete backing pad 5" with nut M14 (82) (max. speed 12000rpm)
90	6158020610	1	Hex key 5/16"
91	6158020100	1	Pin wrench 1-3/8"

Semi-hard backing pad Ø5" (125mm) with nut M14 & 5/8"

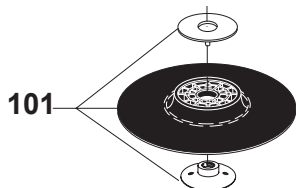

Item	Part no.	Qty	Description
101	6158040740	1	Semi-hard backing pad Ø5" (125mm) with nut M14 & 5/8" (max speed 12000rpm)

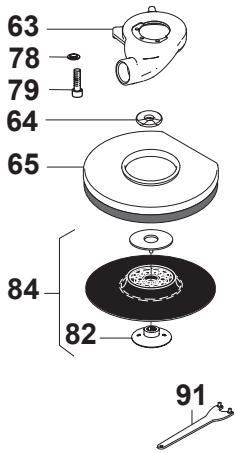
Dust extraction kit Ø7" (180mm) for composite (non metal and metal sanding)

Item	Part no.	Qty	Description
	6153978290	1	Complete kit
63	6155041940	1	Suction cap
64	6156430880	1	Spacer 15mm (5/8")
64	6156430870	1	Spacer 15mm (M14)
65	6155702310	1	Skirt with brush 7"
78	6156451420	2	Washer
79	616.99	2	Screw
84	6159901340	1	Rigid backing pad 7" with nut M14 & 5/8" (82) (max. speed 8500rpm)
91	6158020670	1	Pin wrench 1-3/8"
82	6156060450	1	Nut (5/8")
82	6156060460	1	Nut (M14)

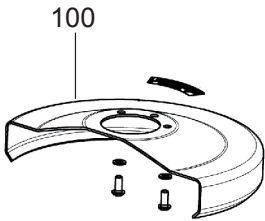
Sanding guard Ø7" (180mm)

Item	Part no.	Qty	Description
100	6155042050	1	Sanding guard 7" kit
		2	Screw hex button M5x12
		2	Washer tooth Dec 5
		1	Warning label for sanding
		1	Guard 7"

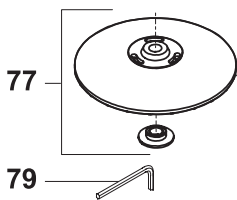
Sanding with spiracool pad Ø7" (180mm)

Item	Part no.	Qty	Description
77	S091836	1	Spiracool pad (max speed 8500rpm)
79	6158020610	1	Hex key 5/16"

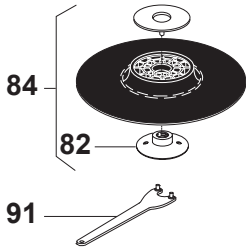
Backing pad M14 & 5/8"

Item	Part no.	Qty	Description
84	6159901330	1	Soft backing pad 7" with nut M14 & 5/8" (max speed 8500rpm)
84	6159901340	1	Rigid backing pad 7" with nut M14 & 5/8" (max speed 8500rpm)
82	606.22	1	Nut M14
82	608.29	1	Nut 5/8"
91	6158020100	2	Pin wrench 1-3/8"

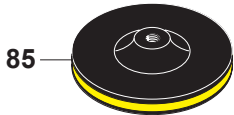
M14

Item	Part no.	Qty	Description
85	6159901450	1	Rigid velcro-backed backing pad 7" (max speed 8500rpm)
85	6159901370	1	Rigid velcro-backed backing pad 6" (max speed 10000rpm)

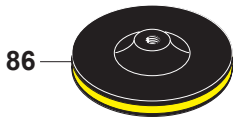
5/8"

Item	Part no.	Qty	Description
86	6159901460	1	Rigid velcro-backed backing pad 7" (max speed 8500rpm)
86	6159901380	1	Rigid velcro-backed backing pad 6" (max speed 10000rpm)