

SR No.	NAME	DIMENSIONS	METRIC [mm]	IMPERIAL [inch]																																																																																																																																																																										
00	ALUMINIUM TUBE		<table border="1"> <thead> <tr> <th>D1</th> <th>Part Number</th> <th>T</th> <th>L</th> <th>Kg.</th> </tr> </thead> <tbody> <tr><td>20</td><td>2811 1000 10</td><td>1,3</td><td>5700</td><td>1,16</td></tr> <tr><td>25</td><td>2811 2000 10</td><td>1,35</td><td>5700</td><td>1,52</td></tr> <tr><td>40</td><td>2811 4000 05</td><td>1,8</td><td>5700</td><td>3,27</td></tr> <tr><td>50</td><td>2811 5000 04</td><td>2</td><td>5700</td><td>4,57</td></tr> <tr><td>63</td><td>2811 6000 03</td><td>2,1</td><td>5700</td><td>6,08</td></tr> <tr><td>80</td><td>2811 7000 02</td><td>2,6</td><td>5700</td><td>9,57</td></tr> <tr><td>100</td><td>2811 8000 00</td><td>3</td><td>5700</td><td>13,29</td></tr> <tr><td>158</td><td>2811 9000 06</td><td>3,75</td><td>5700</td><td>27,36</td></tr> <tr><td>20</td><td>2811 1061 05</td><td>1,3</td><td>2850</td><td>1,16</td></tr> <tr><td>25</td><td>2811 2061 05</td><td>1,35</td><td>2850</td><td>1,52</td></tr> <tr><td>20</td><td>2811 1063 10</td><td>1,3</td><td>2850</td><td>0,58</td></tr> <tr><td>25</td><td>2811 2063 10</td><td>1,35</td><td>2850</td><td>0,76</td></tr> <tr><td>40</td><td>2811 4063 05</td><td>1,8</td><td>2850</td><td>1,64</td></tr> <tr><td>50</td><td>2811 5063 04</td><td>2</td><td>2850</td><td>2,29</td></tr> <tr><td>63</td><td>2811 6063 03</td><td>2,1</td><td>2850</td><td>3,04</td></tr> <tr><td>80</td><td>2811 7063 02</td><td>2,6</td><td>2850</td><td>4,78</td></tr> </tbody> </table>	D1	Part Number	T	L	Kg.	20	2811 1000 10	1,3	5700	1,16	25	2811 2000 10	1,35	5700	1,52	40	2811 4000 05	1,8	5700	3,27	50	2811 5000 04	2	5700	4,57	63	2811 6000 03	2,1	5700	6,08	80	2811 7000 02	2,6	5700	9,57	100	2811 8000 00	3	5700	13,29	158	2811 9000 06	3,75	5700	27,36	20	2811 1061 05	1,3	2850	1,16	25	2811 2061 05	1,35	2850	1,52	20	2811 1063 10	1,3	2850	0,58	25	2811 2063 10	1,35	2850	0,76	40	2811 4063 05	1,8	2850	1,64	50	2811 5063 04	2	2850	2,29	63	2811 6063 03	2,1	2850	3,04	80	2811 7063 02	2,6	2850	4,78	<table border="1"> <thead> <tr> <th>D1</th> <th>Part Number</th> <th>T</th> <th>L</th> <th>lb</th> </tr> </thead> <tbody> <tr><td>3/4</td><td>2811 1000 10</td><td>0,051</td><td>224,4</td><td>2,56</td></tr> <tr><td>1</td><td>2811 2000 10</td><td>0,053</td><td>224,4</td><td>3,35</td></tr> <tr><td>1 1/2</td><td>2811 4000 05</td><td>0,071</td><td>224,4</td><td>7,21</td></tr> <tr><td>2</td><td>2811 5000 04</td><td>0,079</td><td>224,4</td><td>10,08</td></tr> <tr><td>2 1/2</td><td>2811 6000 03</td><td>0,083</td><td>224,4</td><td>13,40</td></tr> <tr><td>3</td><td>2811 7000 02</td><td>0,102</td><td>224,4</td><td>21,10</td></tr> <tr><td>4</td><td>2811 8000 00</td><td>0,118</td><td>224,4</td><td>30,40</td></tr> <tr><td>6</td><td>2811 9000 06</td><td>0,148</td><td>224,4</td><td>60,32</td></tr> <tr><td>3/4</td><td>2811 1061 05</td><td>0,051</td><td>224,4</td><td>2,56</td></tr> <tr><td>1</td><td>2811 2061 05</td><td>0,053</td><td>224,4</td><td>3,35</td></tr> <tr><td>3/4</td><td>2811 1063 10</td><td>0,051</td><td>112,2</td><td>1,28</td></tr> <tr><td>1</td><td>2811 2063 10</td><td>0,053</td><td>112,2</td><td>1,68</td></tr> <tr><td>1 1/2</td><td>2811 4063 05</td><td>0,071</td><td>112,2</td><td>3,62</td></tr> <tr><td>2</td><td>2811 5063 04</td><td>0,079</td><td>112,2</td><td>5,05</td></tr> <tr><td>2 1/2</td><td>2811 6063 03</td><td>0,083</td><td>112,2</td><td>6,70</td></tr> <tr><td>3</td><td>2811 7063 02</td><td>0,102</td><td>112,2</td><td>10,54</td></tr> </tbody> </table>	D1	Part Number	T	L	lb	3/4	2811 1000 10	0,051	224,4	2,56	1	2811 2000 10	0,053	224,4	3,35	1 1/2	2811 4000 05	0,071	224,4	7,21	2	2811 5000 04	0,079	224,4	10,08	2 1/2	2811 6000 03	0,083	224,4	13,40	3	2811 7000 02	0,102	224,4	21,10	4	2811 8000 00	0,118	224,4	30,40	6	2811 9000 06	0,148	224,4	60,32	3/4	2811 1061 05	0,051	224,4	2,56	1	2811 2061 05	0,053	224,4	3,35	3/4	2811 1063 10	0,051	112,2	1,28	1	2811 2063 10	0,053	112,2	1,68	1 1/2	2811 4063 05	0,071	112,2	3,62	2	2811 5063 04	0,079	112,2	5,05	2 1/2	2811 6063 03	0,083	112,2	6,70	3	2811 7063 02	0,102	112,2	10,54
			D1	Part Number	T	L	Kg.																																																																																																																																																																							
20	2811 1000 10	1,3	5700	1,16																																																																																																																																																																										
25	2811 2000 10	1,35	5700	1,52																																																																																																																																																																										
40	2811 4000 05	1,8	5700	3,27																																																																																																																																																																										
50	2811 5000 04	2	5700	4,57																																																																																																																																																																										
63	2811 6000 03	2,1	5700	6,08																																																																																																																																																																										
80	2811 7000 02	2,6	5700	9,57																																																																																																																																																																										
100	2811 8000 00	3	5700	13,29																																																																																																																																																																										
158	2811 9000 06	3,75	5700	27,36																																																																																																																																																																										
20	2811 1061 05	1,3	2850	1,16																																																																																																																																																																										
25	2811 2061 05	1,35	2850	1,52																																																																																																																																																																										
20	2811 1063 10	1,3	2850	0,58																																																																																																																																																																										
25	2811 2063 10	1,35	2850	0,76																																																																																																																																																																										
40	2811 4063 05	1,8	2850	1,64																																																																																																																																																																										
50	2811 5063 04	2	2850	2,29																																																																																																																																																																										
63	2811 6063 03	2,1	2850	3,04																																																																																																																																																																										
80	2811 7063 02	2,6	2850	4,78																																																																																																																																																																										
D1	Part Number	T	L	lb																																																																																																																																																																										
3/4	2811 1000 10	0,051	224,4	2,56																																																																																																																																																																										
1	2811 2000 10	0,053	224,4	3,35																																																																																																																																																																										
1 1/2	2811 4000 05	0,071	224,4	7,21																																																																																																																																																																										
2	2811 5000 04	0,079	224,4	10,08																																																																																																																																																																										
2 1/2	2811 6000 03	0,083	224,4	13,40																																																																																																																																																																										
3	2811 7000 02	0,102	224,4	21,10																																																																																																																																																																										
4	2811 8000 00	0,118	224,4	30,40																																																																																																																																																																										
6	2811 9000 06	0,148	224,4	60,32																																																																																																																																																																										
3/4	2811 1061 05	0,051	224,4	2,56																																																																																																																																																																										
1	2811 2061 05	0,053	224,4	3,35																																																																																																																																																																										
3/4	2811 1063 10	0,051	112,2	1,28																																																																																																																																																																										
1	2811 2063 10	0,053	112,2	1,68																																																																																																																																																																										
1 1/2	2811 4063 05	0,071	112,2	3,62																																																																																																																																																																										
2	2811 5063 04	0,079	112,2	5,05																																																																																																																																																																										
2 1/2	2811 6063 03	0,083	112,2	6,70																																																																																																																																																																										
3	2811 7063 02	0,102	112,2	10,54																																																																																																																																																																										
01	DOUBLE S-BEND		<table border="1"> <thead> <tr> <th>D1</th> <th>Part Number</th> <th>T</th> <th>L</th> <th>H</th> <th>Kg.</th> </tr> </thead> <tbody> <tr><td>20</td><td>2811 1067 05</td><td>1,3</td><td>440</td><td>150</td><td>0,10</td></tr> <tr><td>25</td><td>2811 2067 05</td><td>1,35</td><td>460</td><td>150</td><td>0,13</td></tr> </tbody> </table>	D1	Part Number	T	L	H	Kg.	20	2811 1067 05	1,3	440	150	0,10	25	2811 2067 05	1,35	460	150	0,13	<table border="1"> <thead> <tr> <th>D1</th> <th>Part Number</th> <th>T</th> <th>L</th> <th>H</th> <th>lb</th> </tr> </thead> <tbody> <tr><td>3/4</td><td>2811 1067 05</td><td>0,051</td><td>17,32</td><td>5,90</td><td>0,22</td></tr> <tr><td>1</td><td>2811 2067 05</td><td>0,053</td><td>18,11</td><td>5,90</td><td>0,28</td></tr> </tbody> </table>	D1	Part Number	T	L	H	lb	3/4	2811 1067 05	0,051	17,32	5,90	0,22	1	2811 2067 05	0,053	18,11	5,90	0,28																																																																																																																																						
			D1	Part Number	T	L	H	Kg.																																																																																																																																																																						
20	2811 1067 05	1,3	440	150	0,10																																																																																																																																																																									
25	2811 2067 05	1,35	460	150	0,13																																																																																																																																																																									
D1	Part Number	T	L	H	lb																																																																																																																																																																									
3/4	2811 1067 05	0,051	17,32	5,90	0,22																																																																																																																																																																									
1	2811 2067 05	0,053	18,11	5,90	0,28																																																																																																																																																																									
02	EQUAL SOCKET		<table border="1"> <thead> <tr> <th>D1</th> <th>Part Number</th> <th>L</th> <th>W</th> <th>H</th> <th>S</th> <th>B</th> <th>D</th> <th>Kg.</th> </tr> </thead> <tbody> <tr><td>20</td><td>2811 1002 80</td><td>127,6</td><td>37,5</td><td>-</td><td>39</td><td>50</td><td>-</td><td>0,07</td></tr> <tr><td>25</td><td>2811 2002 80</td><td>139,1</td><td>43,5</td><td>-</td><td>44</td><td>50</td><td>-</td><td>0,1</td></tr> <tr><td>40</td><td>2811 4002 80</td><td>209,8</td><td>67,8</td><td>-</td><td>63</td><td>80</td><td>-</td><td>0,35</td></tr> <tr><td>50</td><td>2811 5002 80</td><td>239</td><td>83,9</td><td>-</td><td>78</td><td>80</td><td>-</td><td>0,63</td></tr> <tr><td>63</td><td>2811 6002 80*</td><td>160</td><td>89</td><td>-</td><td>78,6</td><td>-</td><td>-</td><td>0,78</td></tr> <tr><td>25</td><td>2811 7002 80*</td><td>198</td><td>113</td><td>-</td><td>96,8</td><td>-</td><td>-</td><td>1,55</td></tr> <tr><td>100</td><td>2810 8802 00**</td><td>98</td><td>132,5</td><td>162,3</td><td>46,5</td><td>-</td><td>M10</td><td>1,471</td></tr> <tr><td>158</td><td>2810 9002 00***</td><td>115</td><td>192,0</td><td>227,5</td><td>55</td><td>-</td><td>M12</td><td>3,43</td></tr> </tbody> </table>	D1	Part Number	L	W	H	S	B	D	Kg.	20	2811 1002 80	127,6	37,5	-	39	50	-	0,07	25	2811 2002 80	139,1	43,5	-	44	50	-	0,1	40	2811 4002 80	209,8	67,8	-	63	80	-	0,35	50	2811 5002 80	239	83,9	-	78	80	-	0,63	63	2811 6002 80*	160	89	-	78,6	-	-	0,78	25	2811 7002 80*	198	113	-	96,8	-	-	1,55	100	2810 8802 00**	98	132,5	162,3	46,5	-	M10	1,471	158	2810 9002 00***	115	192,0	227,5	55	-	M12	3,43	<table border="1"> <thead> <tr> <th>D1</th> <th>Part Number</th> <th>L</th> <th>W</th> <th>H</th> <th>S</th> <th>B</th> <th>D</th> <th>lb</th> </tr> </thead> <tbody> <tr><td>1/2</td><td>2811 1002 80</td><td>5,02</td><td>1,47</td><td>-</td><td>1,53</td><td>1,96</td><td>-</td><td>0,15</td></tr> <tr><td>1</td><td>2811 2002 80</td><td>9,41</td><td>3,3</td><td>-</td><td>1,73</td><td>1,96</td><td>-</td><td>0,21</td></tr> <tr><td>1 1/2</td><td>2811 4002 80</td><td>8,22</td><td>2,67</td><td>-</td><td>2,48</td><td>3,15</td><td>-</td><td>0,77</td></tr> <tr><td>2</td><td>2811 5002 80</td><td>9,41</td><td>3,3</td><td>-</td><td>3,07</td><td>3,15</td><td>-</td><td>1,39</td></tr> <tr><td>2 1/2</td><td>2811 6002 80*</td><td>6,29</td><td>3,5</td><td>-</td><td>3,09</td><td>-</td><td>-</td><td>1,72</td></tr> <tr><td>3</td><td>2811 7002 80*</td><td>7,79</td><td>4,44</td><td>-</td><td>3,81</td><td>-</td><td>-</td><td>3,41</td></tr> <tr><td>4</td><td>2810 8802 00**</td><td>3,86</td><td>5,22</td><td>6,4</td><td>1,8</td><td>-</td><td>M10</td><td>3,2</td></tr> <tr><td>6</td><td>2810 9002 00***</td><td>4,52</td><td>7,59</td><td>8,95</td><td>2,16</td><td>-</td><td>M12</td><td>7,56</td></tr> </tbody> </table>	D1	Part Number	L	W	H	S	B	D	lb	1/2	2811 1002 80	5,02	1,47	-	1,53	1,96	-	0,15	1	2811 2002 80	9,41	3,3	-	1,73	1,96	-	0,21	1 1/2	2811 4002 80	8,22	2,67	-	2,48	3,15	-	0,77	2	2811 5002 80	9,41	3,3	-	3,07	3,15	-	1,39	2 1/2	2811 6002 80*	6,29	3,5	-	3,09	-	-	1,72	3	2811 7002 80*	7,79	4,44	-	3,81	-	-	3,41	4	2810 8802 00**	3,86	5,22	6,4	1,8	-	M10	3,2	6	2810 9002 00***	4,52	7,59	8,95	2,16	-	M12	7,56								
			D1	Part Number	L	W	H	S	B	D	Kg.																																																																																																																																																																			
20	2811 1002 80	127,6	37,5	-	39	50	-	0,07																																																																																																																																																																						
25	2811 2002 80	139,1	43,5	-	44	50	-	0,1																																																																																																																																																																						
40	2811 4002 80	209,8	67,8	-	63	80	-	0,35																																																																																																																																																																						
50	2811 5002 80	239	83,9	-	78	80	-	0,63																																																																																																																																																																						
63	2811 6002 80*	160	89	-	78,6	-	-	0,78																																																																																																																																																																						
25	2811 7002 80*	198	113	-	96,8	-	-	1,55																																																																																																																																																																						
100	2810 8802 00**	98	132,5	162,3	46,5	-	M10	1,471																																																																																																																																																																						
158	2810 9002 00***	115	192,0	227,5	55	-	M12	3,43																																																																																																																																																																						
D1	Part Number	L	W	H	S	B	D	lb																																																																																																																																																																						
1/2	2811 1002 80	5,02	1,47	-	1,53	1,96	-	0,15																																																																																																																																																																						
1	2811 2002 80	9,41	3,3	-	1,73	1,96	-	0,21																																																																																																																																																																						
1 1/2	2811 4002 80	8,22	2,67	-	2,48	3,15	-	0,77																																																																																																																																																																						
2	2811 5002 80	9,41	3,3	-	3,07	3,15	-	1,39																																																																																																																																																																						
2 1/2	2811 6002 80*	6,29	3,5	-	3,09	-	-	1,72																																																																																																																																																																						
3	2811 7002 80*	7,79	4,44	-	3,81	-	-	3,41																																																																																																																																																																						
4	2810 8802 00**	3,86	5,22	6,4	1,8	-	M10	3,2																																																																																																																																																																						
6	2810 9002 00***	4,52	7,59	8,95	2,16	-	M12	7,56																																																																																																																																																																						
03	ELBOW 90°		<table border="1"> <thead> <tr> <th>D1</th> <th>Part Number</th> <th>L</th> <th>W</th> <th>L1</th> <th>Kg.</th> </tr> </thead> <tbody> <tr><td>20</td><td>2811 1003 80</td><td>82,5</td><td>37,5</td><td>25</td><td>0,07</td></tr> <tr><td>25</td><td>2811 2003 80</td><td>95,7</td><td>43,5</td><td>30</td><td>0,1</td></tr> <tr><td>40</td><td>2811 4003 80</td><td>148,3</td><td>67,8</td><td>50</td><td>0,36</td></tr> <tr><td>50</td><td>2811 5003 80</td><td>186,1</td><td>83,9</td><td>65</td><td>0,70</td></tr> <tr><td>63</td><td>2811 6003 80*</td><td>157,5</td><td>89</td><td>-</td><td>0,97</td></tr> <tr><td>80</td><td>2811 7003 80*</td><td>196,8</td><td>113</td><td>-</td><td>1,966</td></tr> <tr><td>100</td><td>2810 8003 00**</td><td>252</td><td>-</td><td>202</td><td>1,23</td></tr> <tr><td>158</td><td>2810 9003 00***</td><td>248,25</td><td>-</td><td>170</td><td>2,51</td></tr> </tbody> </table>	D1	Part Number	L	W	L1	Kg.	20	2811 1003 80	82,5	37,5	25	0,07	25	2811 2003 80	95,7	43,5	30	0,1	40	2811 4003 80	148,3	67,8	50	0,36	50	2811 5003 80	186,1	83,9	65	0,70	63	2811 6003 80*	157,5	89	-	0,97	80	2811 7003 80*	196,8	113	-	1,966	100	2810 8003 00**	252	-	202	1,23	158	2810 9003 00***	248,25	-	170	2,51	<table border="1"> <thead> <tr> <th>D1</th> <th>Part Number</th> <th>L</th> <th>W</th> <th>L1</th> <th>lb</th> </tr> </thead> <tbody> <tr><td>1/2</td><td>2811 1003 80</td><td>3,24</td><td>1,47</td><td>0,98</td><td>0,15</td></tr> <tr><td>1</td><td>2811 2003 80</td><td>3,76</td><td>1,67</td><td>1,18</td><td>0,21</td></tr> <tr><td>1 1/2</td><td>2811 4003 80</td><td>5,84</td><td>2,67</td><td>1,97</td><td>0,79</td></tr> <tr><td>2</td><td>2811 5003 80</td><td>7,33</td><td>3,3</td><td>2,56</td><td>1,54</td></tr> <tr><td>2 1/2</td><td>2811 6003 80*</td><td>6,2</td><td>4,2</td><td>-</td><td>2,14</td></tr> <tr><td>3</td><td>2811 7003 80*</td><td>7,74</td><td>4,4</td><td>-</td><td>4,32</td></tr> <tr><td>4</td><td>2810 8003 00**</td><td>9,92</td><td>-</td><td>7,95</td><td>2,71</td></tr> <tr><td>6</td><td>2810 9003 00***</td><td>9,78</td><td>-</td><td>6,69</td><td>5,53</td></tr> </tbody> </table>	D1	Part Number	L	W	L1	lb	1/2	2811 1003 80	3,24	1,47	0,98	0,15	1	2811 2003 80	3,76	1,67	1,18	0,21	1 1/2	2811 4003 80	5,84	2,67	1,97	0,79	2	2811 5003 80	7,33	3,3	2,56	1,54	2 1/2	2811 6003 80*	6,2	4,2	-	2,14	3	2811 7003 80*	7,74	4,4	-	4,32	4	2810 8003 00**	9,92	-	7,95	2,71	6	2810 9003 00***	9,78	-	6,69	5,53																																																														
			D1	Part Number	L	W	L1	Kg.																																																																																																																																																																						
20	2811 1003 80	82,5	37,5	25	0,07																																																																																																																																																																									
25	2811 2003 80	95,7	43,5	30	0,1																																																																																																																																																																									
40	2811 4003 80	148,3	67,8	50	0,36																																																																																																																																																																									
50	2811 5003 80	186,1	83,9	65	0,70																																																																																																																																																																									
63	2811 6003 80*	157,5	89	-	0,97																																																																																																																																																																									
80	2811 7003 80*	196,8	113	-	1,966																																																																																																																																																																									
100	2810 8003 00**	252	-	202	1,23																																																																																																																																																																									
158	2810 9003 00***	248,25	-	170	2,51																																																																																																																																																																									
D1	Part Number	L	W	L1	lb																																																																																																																																																																									
1/2	2811 1003 80	3,24	1,47	0,98	0,15																																																																																																																																																																									
1	2811 2003 80	3,76	1,67	1,18	0,21																																																																																																																																																																									
1 1/2	2811 4003 80	5,84	2,67	1,97	0,79																																																																																																																																																																									
2	2811 5003 80	7,33	3,3	2,56	1,54																																																																																																																																																																									
2 1/2	2811 6003 80*	6,2	4,2	-	2,14																																																																																																																																																																									
3	2811 7003 80*	7,74	4,4	-	4,32																																																																																																																																																																									
4	2810 8003 00**	9,92	-	7,95	2,71																																																																																																																																																																									
6	2810 9003 00***	9,78	-	6,69	5,53																																																																																																																																																																									
04	ELBOW 45°		<table border="1"> <thead> <tr> <th>D1</th> <th>Part Number</th> <th>L</th> <th>W</th> <th>V</th> <th>Kg.</th> </tr> </thead> <tbody> <tr><td>20</td><td>2811 1004 80</td><td>109,1</td><td>37,5</td><td>20</td><td>0,07</td></tr> <tr><td>25</td><td>2811 2004 80</td><td>127,9</td><td>43,5</td><td>25</td><td>0,09</td></tr> <tr><td>40</td><td>2811 4004 80</td><td>194,6</td><td>67,8</td><td>40</td><td>0,35</td></tr> <tr><td>50</td><td>2811 5004 80</td><td>240,8</td><td>83,9</td><td>50</td><td>0,66</td></tr> <tr><td>63</td><td>2811 6004 80*</td><td>201,9</td><td>89</td><td>-</td><td>0,99</td></tr> <tr><td>80</td><td>2811 7004 80*</td><td>246,1</td><td>112,5</td><td>-</td><td>1,816</td></tr> <tr><td>100</td><td>2810 8004 00**</td><td>287</td><td>-</td><td>147,5</td><td>1,27</td></tr> <tr><td>158</td><td>2810 9004 00***</td><td>285</td><td>-</td><td>134,5</td><td>2,23</td></tr> </tbody> </table>	D1	Part Number	L	W	V	Kg.	20	2811 1004 80	109,1	37,5	20	0,07	25	2811 2004 80	127,9	43,5	25	0,09	40	2811 4004 80	194,6	67,8	40	0,35	50	2811 5004 80	240,8	83,9	50	0,66	63	2811 6004 80*	201,9	89	-	0,99	80	2811 7004 80*	246,1	112,5	-	1,816	100	2810 8004 00**	287	-	147,5	1,27	158	2810 9004 00***	285	-	134,5	2,23	<table border="1"> <thead> <tr> <th>D1</th> <th>Part Number</th> <th>L</th> <th>W</th> <th>V</th> <th>lb</th> </tr> </thead> <tbody> <tr><td>1/2</td><td>2811 1004 80</td><td>4,29</td><td>1,47</td><td>0,78</td><td>0,15</td></tr> <tr><td>1</td><td>2811 2004 80</td><td>5,03</td><td>1,71</td><td>0,98</td><td>0,21</td></tr> <tr><td>1 1/2</td><td>2811 4004 80</td><td>7,66</td><td>2,67</td><td>1,57</td><td>0,77</td></tr> <tr><td>2</td><td>2811 5004 80</td><td>9,48</td><td>3,3</td><td>1,97</td><td>1,46</td></tr> <tr><td>2 1/2</td><td>2811 6004 80*</td><td>7,95</td><td>3,5</td><td>-</td><td>2,18</td></tr> <tr><td>3</td><td>2811 7004 80*</td><td>9,68</td><td>4,42</td><td>-</td><td>4,00</td></tr> <tr><td>4</td><td>2810 8004 00**</td><td>11,29</td><td>-</td><td>5,80</td><td>2,81</td></tr> <tr><td>6</td><td>2810 9004 00***</td><td>11,22</td><td>-</td><td>5,29</td><td>4,91</td></tr> </tbody> </table>	D1	Part Number	L	W	V	lb	1/2	2811 1004 80	4,29	1,47	0,78	0,15	1	2811 2004 80	5,03	1,71	0,98	0,21	1 1/2	2811 4004 80	7,66	2,67	1,57	0,77	2	2811 5004 80	9,48	3,3	1,97	1,46	2 1/2	2811 6004 80*	7,95	3,5	-	2,18	3	2811 7004 80*	9,68	4,42	-	4,00	4	2810 8004 00**	11,29	-	5,80	2,81	6	2810 9004 00***	11,22	-	5,29	4,91																																																														
			D1	Part Number	L	W	V	Kg.																																																																																																																																																																						
20	2811 1004 80	109,1	37,5	20	0,07																																																																																																																																																																									
25	2811 2004 80	127,9	43,5	25	0,09																																																																																																																																																																									
40	2811 4004 80	194,6	67,8	40	0,35																																																																																																																																																																									
50	2811 5004 80	240,8	83,9	50	0,66																																																																																																																																																																									
63	2811 6004 80*	201,9	89	-	0,99																																																																																																																																																																									
80	2811 7004 80*	246,1	112,5	-	1,816																																																																																																																																																																									
100	2810 8004 00**	287	-	147,5	1,27																																																																																																																																																																									
158	2810 9004 00***	285	-	134,5	2,23																																																																																																																																																																									
D1	Part Number	L	W	V	lb																																																																																																																																																																									
1/2	2811 1004 80	4,29	1,47	0,78	0,15																																																																																																																																																																									
1	2811 2004 80	5,03	1,71	0,98	0,21																																																																																																																																																																									
1 1/2	2811 4004 80	7,66	2,67	1,57	0,77																																																																																																																																																																									
2	2811 5004 80	9,48	3,3	1,97	1,46																																																																																																																																																																									
2 1/2	2811 6004 80*	7,95	3,5	-	2,18																																																																																																																																																																									
3	2811 7004 80*	9,68	4,42	-	4,00																																																																																																																																																																									
4	2810 8004 00**	11,29	-	5,80	2,81																																																																																																																																																																									
6	2810 9004 00***	11,22	-	5,29	4,91																																																																																																																																																																									
05	EQUAL TEE		<table border="1"> <thead> <tr> <th>D1</th> <th>Part Number</th> <th>L</th> <th>H</th> <th>W</th> <th>S</th> <th>T</th> <th>Y</th> <th>Kg.</th> </tr> </thead> <tbody> <tr><td>20</td><td>2811 1005 80</td><td>127,6</td><td>62,6</td><td>37,5</td><td>39</td><td>25</td><td>0,10</td></tr> <tr><td>25</td><td>2811 2005 80</td><td>147,9</td><td>67,8</td><td>43,5</td><td>44</td><td>30</td><td>0,14</td></tr> <tr><td>40</td><td>2811 4005 80</td><td>228,8</td><td>148,3</td><td>67,8</td><td>63</td><td>50</td><td>0,53</td></tr> <tr><td>50</td><td>2811 5005 80</td><td>289</td><td>186,1</td><td>83,9</td><td>78</td><td>65</td><td>1,02</td></tr> <tr><td>63</td><td>2811 6005 80*</td><td>226</td><td>157,1</td><td>89</td><td>78,6</td><td>-</td><td>1,33</td></tr> <tr><td>80</td><td>2811 7005 80*</td><td>280,7</td><td>196,8</td><td>113</td><td>96,8</td><td>-</td><td>2,68</td></tr> <tr><td>100</td><td>2810 8005 00**</td><td>304</td><td>202</td><td>-</td><td>-</td><td>152</td><td>1,42</td></tr> <tr><td>158</td><td>2810 9005 00***</td><td>320</td><td>238,6</td><td>-</td><td>-</td><td>160</td><td>3,54</td></tr> </tbody> </table>	D1	Part Number	L	H	W	S	T	Y	Kg.	20	2811 1005 80	127,6	62,6	37,5	39	25	0,10	25	2811 2005 80	147,9	67,8	43,5	44	30	0,14	40	2811 4005 80	228,8	148,3	67,8	63	50	0,53	50	2811 5005 80	289	186,1	83,9	78	65	1,02	63	2811 6005 80*	226	157,1	89	78,6	-	1,33	80	2811 7005 80*	280,7	196,8	113	96,8	-	2,68	100	2810 8005 00**	304	202	-	-	152	1,42	158	2810 9005 00***	320	238,6	-	-	160	3,54	<table border="1"> <thead> <tr> <th>D1</th> <th>Part Number</th> <th>L</th> <th>H</th> <th>W</th> <th>S</th> <th>T</th> <th>lb</th> </tr> </thead> <tbody> <tr><td>1/2</td><td>2811 1005 80</td><td>5,02</td><td>3,25</td><td>1,41</td><td>-</td><td>1,53</td><td>0,98</td><td>0,22</td></tr> <tr><td>1</td><td>2811 2005 80</td><td>5,82</td><td>3,26</td><td>1,71</td><td>-</td><td>1,73</td><td>1,18</td><td>0,31</td></tr> <tr><td>1 1/2</td><td>2811 4005 80</td><td>9</td><td>5,84</td><td>2,67</td><td>2,48</td><td>1,97</td><td>1,17</td></tr> <tr><td>2</td><td>2811 5005 80</td><td>11,98</td><td>7,33</td><td>3,3</td><td>3,07</td><td>2,56</td><td>2,25</td></tr> <tr><td>2 1/2</td><td>2811 6005 80*</td><td>8,89</td><td>6,18</td><td>3,50</td><td>3,09</td><td>-</td><td>2,93</td></tr> <tr><td>3</td><td>2811 7005 80*</td><td>11,05</td><td>7,74</td><td>4,44</td><td>3,81</td><td>-</td><td>5,90</td></tr> <tr><td>4</td><td>2810 8005 00**</td><td>11,97</td><td>7,95</td><td>-</td><td>-</td><td>5,98</td><td>3,13</td></tr> <tr><td>6</td><td>2810 9005 00***</td><td>12,59</td><td>9,40</td><td>-</td><td>-</td><td>6,29</td><td>7,81</td></tr> </tbody> </table>	D1	Part Number	L	H	W	S	T	lb	1/2	2811 1005 80	5,02	3,25	1,41	-	1,53	0,98	0,22	1	2811 2005 80	5,82	3,26	1,71	-	1,73	1,18	0,31	1 1/2	2811 4005 80	9	5,84	2,67	2,48	1,97	1,17	2	2811 5005 80	11,98	7,33	3,3	3,07	2,56	2,25	2 1/2	2811 6005 80*	8,89	6,18	3,50	3,09	-	2,93	3	2811 7005 80*	11,05	7,74	4,44	3,81	-	5,90	4	2810 8005 00**	11,97	7,95	-	-	5,98	3,13	6	2810 9005 00***	12,59	9,40	-	-	6,29	7,81																							
			D1	Part Number	L	H	W	S	T	Y	Kg.																																																																																																																																																																			
20	2811 1005 80	127,6	62,6	37,5	39	25	0,10																																																																																																																																																																							
25	2811 2005 80	147,9	67,8	43,5	44	30	0,14																																																																																																																																																																							
40	2811 4005 80	228,8	148,3	67,8	63	50	0,53																																																																																																																																																																							
50	2811 5005 80	289	186,1	83,9	78	65	1,02																																																																																																																																																																							
63	2811 6005 80*	226	157,1	89	78,6	-	1,33																																																																																																																																																																							
80	2811 7005 80*	280,7	196,8	113	96,8	-	2,68																																																																																																																																																																							
100	2810 8005 00**	304	202	-	-	152	1,42																																																																																																																																																																							
158	2810 9005 00***	320	238,6	-	-	160	3,54																																																																																																																																																																							
D1	Part Number	L	H	W	S	T	lb																																																																																																																																																																							
1/2	2811 1005 80	5,02	3,25	1,41	-	1,53	0,98	0,22																																																																																																																																																																						
1	2811 2005 80	5,82	3,26	1,71	-	1,73	1,18	0,31																																																																																																																																																																						
1 1/2	2811 4005 80	9	5,84	2,67	2,48	1,97	1,17																																																																																																																																																																							
2	2811 5005 80	11,98	7,33	3,3	3,07	2,56	2,25																																																																																																																																																																							
2 1/2	2811 6005 80*	8,89	6,18	3,50	3,09	-	2,93																																																																																																																																																																							
3	2811 7005 80*	11,05	7,74	4,44	3,81	-	5,90																																																																																																																																																																							
4	2810 8005 00**	11,97	7,95	-	-	5,98	3,13																																																																																																																																																																							
6	2810 9005 00***	12,59	9,40	-	-	6,29	7,81																																																																																																																																																																							

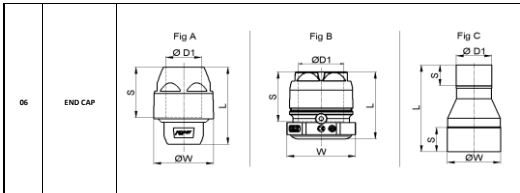

D1	Part Number	L	W	S	Kg.
20	2811 1006 80	58,8	37,5	39	0,63
25	2811 2006 80	89	43,5	44	0,95
40	2811 4006 80	99,4	67,8	63	0,17
50	2811 5006 80	119,5	83,9	78	0,32
63	2811 6006 80*	104	96	78,5	0,66
80	2811 7006 80**	109	115	86,8	0,816
100	2810 9816 00***	270	158	65	2,20
158	2810 9816 00***	270	158	55	2,20

(*) Refer Fig. B for dimensions.
 (**) Refer Fig. C for dimensions + add equal sockets 2810 8002 00
 (***) Refer Fig. C for dimensions + add equal sockets 2810 9002 00

D1	Part Number	L	W	S	lb
%	2811 1006 80	2,31	1,47	1,53	0,07
1	2811 2006 80	2,71	1,71	1,73	0,11
1%	2811 4006 80	3,91	2,67	2,48	0,38
2	2811 5006 80	4,7	3,3	3,07	0,71
2%	2811 6006 80*	4,09	3,77	3,09	1,45
3	2811 7006 80**	4,29	4,63	3,81	2,06
4	2810 9816 00***	10,59	5,90	2,55	4,43
6	2810 9816 00***	10,59	5,90	2,16	4,43

(*) Refer Fig. B for dimensions.
 (**) Refer Fig. C for dimensions + add equal sockets 2810 8002 00
 (***) Refer Fig. C for dimensions + add equal sockets 2810 9002 00

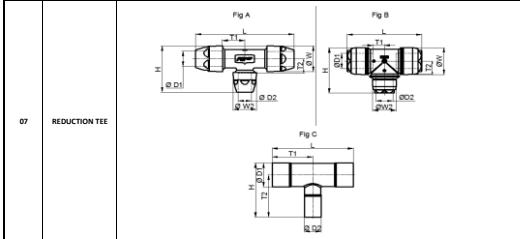

D1	Part Number	D2	L	H	W	W2	T1	T2	Kg.
25	2811 2107 80	20	148	90,5	67,8	43,5	30,08	30	0,13
40	2811 4107 80	20	228,8	112,7	67,8	37,5	50	40	0,4
40	2811 4207 80	25	228,8	117,9	67,8	43,5	50	40	0,41
50	2811 5107 80	20	289	130,6	83,9	37,5	65	50	0,73
50	2811 5207 80	25	289	135,9	83,9	43,5	65	50	0,74
50	2811 5407 80	40	289	151,3	83,9	67,8	65	45	0,84
63	2811 6507 81*	50	226	231	89	83,9	84,4	108	1,53
80	2811 7607 80**	63	281	193	113	89	83,5	85,8	2,01
100	2810 8507 00**	50	304	227	-	-	152	177	1,25
100	2810 8607 00**	63	304	227	-	-	152	177	1,25
100	2810 8707 00**	80	304	252	-	-	152	202	1,42
158	2810 9707 00***	80	320	310,3	-	-	160	231,5	3,29
158	2810 9807 00***	100	320	280,8	-	-	160	202	3,33

(*) Refer Fig. B for dimensions.
 (**) Refer Fig. C for dimensions and always add 2 equal sockets 2810 8002 00 and 1 fitting on dropline.
 (***) Refer Fig. C for dimensions and always add 2 equal sockets 2810 9002 00 and 1 fitting on dropline.

D1	Part Number	D2	L	H	W	W2	T1	T2	lb	
%	2811 2107 80	%	5,82	3,56	2,66	1,71	1,18	1,18	0,28	
1%	2811 4107 80	%	9	4,43	2,66	1,47	1,96	1,57	0,88	
1%	2811 4207 80	1	9	4,64	2,66	1,71	1,96	1,57	0,90	
2	2811 5107 80	%	11,37	5,14	3,30	1,47	2,55	1,96	1,63	
2	2811 5207 80	1	11,37	5,35	3,30	1,71	2,55	1,96	1,63	
2	2811 5407 80	1%	11,89	5,96	3,30	2,07	2,56	1,77	1,83	
2%	2811 6507 81*	2	8,89	9,17	3,50	3,30	1,35	4,25	3,37	
3	2811 7607 80**	3%	11,06	2,5	4,44	3,50	1,71	2,19	5,78	
4	2810 8507 00**	2	11,97	8,94	-	-	-	-	2,76	
4	2810 8607 00**	2%	11,97	8,94	-	-	-	-	2,76	
4	2810 8707 00**	3	11,97	9,92	-	-	-	-	3,13	
6	2810 9707 00***	3	12,59	12,21	-	-	-	6,29	9,11	7,26
6	2810 9807 00***	4	12,59	11,05	-	-	-	6,29	7,95	7,34

(*) Refer Fig. B for dimensions.
 (**) Refer Fig. C for dimensions and always add 2 equal sockets 2810 8002 00 and 1 fitting on dropline.
 (***) Refer Fig. C for dimensions and always add 2 equal sockets 2810 9002 00 and 1 fitting on dropline.

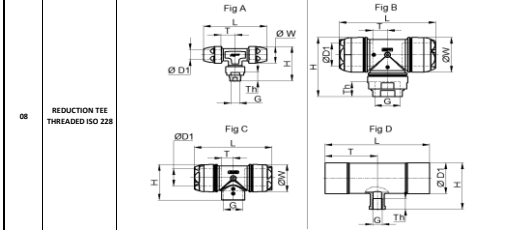

D1	Part Number	G	L	Th	H	W	T	Kg.
20	2811 0008 80	G3/8	127,6	28	86,4	37,5	25	0,14
20	2811 1008 80	G1/2	127,6	28	86,4	37,5	25	0,13
25	2811 2008 80	G1/2	148	28	94,8	43,5	30	0,19
25	2811 2108 80	G1/2	148	28	94,8	43,5	30	0,17
40	2811 4208 80	G1	228,8	30	138,9	67,8	50	0,60
50	2811 5208 80	G1	289	30	142	83,9	65	0,81
63	2811 6508 80**	G2	226	32	116	89	34,4	1,967
80	2811 7608 80**	G2%	281	48	193	113	43,5	2,79
80	2811 7708 80**	G3	281	35	140	113	43,5	2,25
100	2810 8208 00***	G1	304	35	150,5	-	152	1,14
158	2810 9208 00***	G1	320	35	206,3	-	160	2,77

(*) Refer Fig. B for dimensions.
 (**) Refer Fig. C for dimensions.
 (***) Refer Fig. D for dimensions and always add 2 equal sockets 2810 8002 00 for each Equal Tee.
 (****) Refer Fig. D for dimensions and always add 2 equal sockets 2810 9002 00 for each Equal Tee.

D1	Part Number	G	L	Th	H	W	T	lb	
%	2811 0008 80	G3/8	5,02	1,10	3,40	1,47	0,98	0,30	
%	2811 1008 80	G1/2	5,02	1,10	3,40	1,47	0,98	0,28	
1	2811 2008 80	G1/2	5,82	1,10	3,73	1,71	1,18	0,41	
1	2811 2108 80	G1/2	5,82	1,10	3,73	1,71	1,18	0,38	
1%	2811 4208 80	G1	9,01	1,38	5,47	2,07	1,32	1,32	
2	2811 5208 80	G1	11,38	1,38	5,59	3,3	2,56	2,01	
2%	2811 6508 80**	G2	8,89	1,25	4,56	3,50	1,35	2,34	
3	2811 7608 80**	G2%	11,06	1,88	7,55	4,44	1,73	6,13	
3	2811 7708 80**	G3	11,06	1,38	5,51	4,44	1,73	4,95	
4	2810 8208 00***	G1	11,97	1,38	5,93	-	-	5,97	2,58
6	2810 9208 00***	G1	12,59	1,38	8,12	-	-	6,29	6,10

(*) Refer Fig. B for dimensions.
 (**) Refer Fig. D for dimensions and always add 2 equal sockets 2810 8002 00 for each Equal Tee.
 (***) Refer Fig. D for dimensions and always add 2 equal sockets 2810 9002 00 for each Equal Tee.

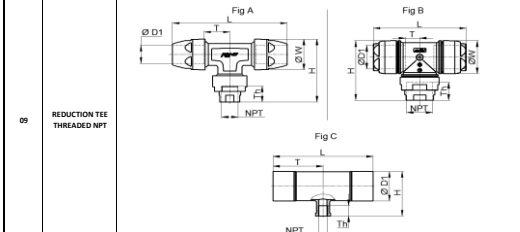

D1	Part Number	NPT	L	Th	H	W	T	Kg.
20	2811 0009 80	NPT3/8	127,6	25	86,4	37,5	25	0,14
20	2811 1009 80	NPT1/2	127,6	25	86,4	37,5	25	0,13
25	2811 2009 80	NPT1/2	148	28	94,8	43,5	30	0,19
25	2811 2109 80	NPT1/2	148	28	94,8	43,5	30	0,17
40	2811 4209 80	NPT1	228,8	30	138,9	67,8	50	0,60
50	2811 5209 80	NPT1	289	30	142	83,9	65	0,81
63	2811 6509 80*	NPT2	226	48	161	89	34,4	1,45
80	2811 7609 80**	NPT2%	281	48	192	113	43,5	2,89
80	2811 7709 80**	NPT3	281	42	189	113	43,5	2,71
100	2810 8209 00**	NPT1	304	31,5	150,5	-	152	1,14
158	2810 9209 00***	NPT1	320	25	206,3	-	160	2,78

(*) Refer Fig. B for dimensions.
 (**) Refer Fig. C for dimensions and always add 2 equal sockets 2810 8002 00 for each Equal Tee.
 (***) Refer Fig. C for dimensions and always add 2 equal sockets 2810 9002 00 for each Equal Tee.

D1	Part Number	NPT	L	Th	H	W	T	lb	
%	2811 0009 80	NPT3/8	5,02	0,98	3,40	1,47	0,98	0,31	
%	2811 1009 80	NPT1/2	5,02	0,98	3,40	1,47	0,98	0,28	
1	2811 2009 80	NPT1/2	5,82	1,10	3,73	1,71	1,18	0,41	
1	2811 2109 80	NPT1/2	5,82	1,10	3,73	1,71	1,18	0,38	
1%	2811 4209 80	NPT1	9,01	1,18	5,47	2,07	1,97	1,32	
2	2811 5209 80	NPT1	11,38	1,18	5,59	3,3	2,56	2,0	
2%	2811 6509 80*	NPT2	8,89	1,88	6,33	3,5	1,35	3,19	
3	2811 7609 80**	NPT2%	11,06	4,06	7,55	4,4	1,71	6,35	
3	2811 7709 80**	NPT3	11,06	1,65	7,83	4,4	1,71	5	
4	2810 8209 00**	NPT1	11,97	1,24	5,93	-	-	5,98	2,51
6	2810 9209 00***	NPT1	12,59	0,98	8,12	-	-	6,29	2,78

(*) Refer Fig. B for dimensions.
 (**) Refer Fig. C for dimensions and always add 2 equal sockets 2810 8002 00 for each Equal Tee.
 (***) Refer Fig. C for dimensions and always add 2 equal sockets 2810 9002 00 for each Equal Tee.

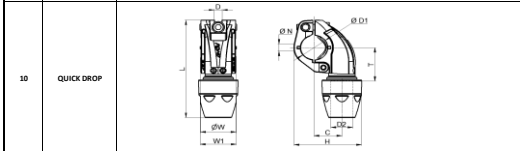

D1	Part Number	D2	L	H	W1	W	D	N	S	T	C	Kg.
25	2811 2110 80	20	103	64	37,5	37,5	M6	15	-	35	26,5	0,10
40	2811 4110 80	20	119	78	48	37,5	M6	25	-	45	31	0,13
40	2811 4210 80	25	125	83	48	43,5	M6	25	-	45	32,5	0,15
50	2811 5110 80	20	131	89	46,5	37,5	M6	25	-	50	37	0,14
50	2811 5210 80	25	136	94	46,5	43,5	M6	25	-	50	39	0,16
63	2811 6110 80	20	143	106	48	43,5	M6	25	-	57	43,5	0,17
63	2811 6210 80	25	148	110	48,6	43,5	M6	25	-	57	46	0,19
80	2811 7110 80	20	163	121	48,5	37,5	M6	25	-	67	52	0,19
80	2811 7210 80	25	168	127	48,5	43,5	M6	25	-	67	54,5	0,21

(*) Refer Fig. B for dimensions.

D1	Part Number	D2	L	H	W1	W	D	N	S	T	C	lb
%	2811 2110 80	%	4,05	2,51	1,47	1,47	UNC1/8	0,59	-	1,37	1,04	0,21
1%	2811 4110 80	%	4,68	3,07	1,88	1,47	UNC1/8	0,98	-	1,77	1,22	0,27
1%	2811 4210 80	1	4,92	3,26	1,88	1,71	UNC1/8	0,98	-	1,77	1,27	0,31
2	2811 5110 80	%	5,15	3,50	1,83	1,47	UNC1/8	0,98	-	1,96	1,45	0,30
2	2811 5210 80	1	5,35	3,70	1,83	1,71	UNC1/8	0,98	-	1,96	1,53	0,34
2%	2811 6110 80	%	5,62	4,06	1,91	1,47	UNC1/8	0,98	-	2,24	1,71	0,36
2%	2811 6210 80	1	5,82	4,33	1,91	1,71	UNC1/8	0,98	-	2,24	1,81	0,41
3	2811 7110 80	%	6,41	4,76	1,90	1,47	UNC1/8	0,98	-	2,63	2,04	0,42
3	2811 7210 80	1	6,61	5	1,90	1,71	UNC1/8	0,98	-	2,63	2,14	0,46

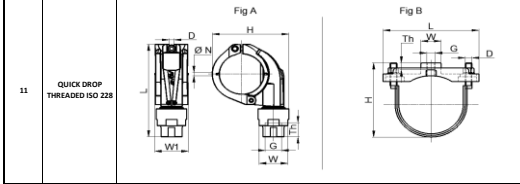

D1	Part Number	G	Th	L	H	W1	W	D	N	S	T	C	Kg.
25	2811 2011 80	G1/2	25	107	65	38	36	M6	15				

<p>12</p> <p>QUICK DROP THREADED NPT</p>		<table border="1"> <thead> <tr> <th>D1</th> <th>Part Number</th> <th>NPT</th> <th>Th</th> <th>L</th> <th>H</th> <th>W1</th> <th>W</th> <th>D</th> <th>N</th> <th>Kg.</th> </tr> </thead> <tbody> <tr><td>25</td><td>2811 2012 80</td><td>NPT½</td><td>25</td><td>107</td><td>65</td><td>38</td><td>36</td><td>M6</td><td>15</td><td>0,12</td></tr> <tr><td>40</td><td>2811 4012 80</td><td>NPT¾</td><td>25</td><td>124</td><td>79</td><td>48</td><td>36</td><td>M6</td><td>25</td><td>0,15</td></tr> <tr><td>50</td><td>2811 5012 80</td><td>NPT1</td><td>25</td><td>135</td><td>90</td><td>46,5</td><td>36</td><td>M6</td><td>25</td><td>0,17</td></tr> <tr><td>50</td><td>2811 5112 80</td><td>NPT¾</td><td>25</td><td>135</td><td>95</td><td>46,5</td><td>41</td><td>M6</td><td>25</td><td>0,19</td></tr> <tr><td>63</td><td>2811 6012 80</td><td>NPT1½</td><td>25</td><td>148</td><td>105</td><td>48</td><td>36</td><td>M6</td><td>25</td><td>0,19</td></tr> <tr><td>63</td><td>2811 6112 80</td><td>NPT1</td><td>25</td><td>148</td><td>105</td><td>48,6</td><td>41</td><td>M6</td><td>25</td><td>0,21</td></tr> <tr><td>80</td><td>2811 7012 80</td><td>NPT2</td><td>25</td><td>167</td><td>122</td><td>48,5</td><td>36</td><td>M6</td><td>25</td><td>0,22</td></tr> <tr><td>80</td><td>2811 7112 80</td><td>NPT1½</td><td>25</td><td>167</td><td>127</td><td>48,5</td><td>41</td><td>M6</td><td>25</td><td>0,24</td></tr> </tbody> </table>	D1	Part Number	NPT	Th	L	H	W1	W	D	N	Kg.	25	2811 2012 80	NPT½	25	107	65	38	36	M6	15	0,12	40	2811 4012 80	NPT¾	25	124	79	48	36	M6	25	0,15	50	2811 5012 80	NPT1	25	135	90	46,5	36	M6	25	0,17	50	2811 5112 80	NPT¾	25	135	95	46,5	41	M6	25	0,19	63	2811 6012 80	NPT1½	25	148	105	48	36	M6	25	0,19	63	2811 6112 80	NPT1	25	148	105	48,6	41	M6	25	0,21	80	2811 7012 80	NPT2	25	167	122	48,5	36	M6	25	0,22	80	2811 7112 80	NPT1½	25	167	127	48,5	41	M6	25	0,24	<table border="1"> <thead> <tr> <th>D1</th> <th>Part Number</th> <th>NPT</th> <th>Th</th> <th>L</th> <th>H</th> <th>W1</th> <th>W</th> <th>D</th> <th>N</th> <th>ib</th> </tr> </thead> <tbody> <tr><td>1</td><td>2811 2012 80</td><td>NPT½</td><td>0,98</td><td>4,21</td><td>2,55</td><td>1,49</td><td>1,41</td><td>UNC1/8</td><td>0,59</td><td>0,26</td></tr> <tr><td>1½</td><td>2811 4012 80</td><td>NPT¾</td><td>0,98</td><td>4,88</td><td>3,11</td><td>1,88</td><td>1,41</td><td>UNC1/8</td><td>0,98</td><td>0,33</td></tr> <tr><td>1½</td><td>2811 4112 80</td><td>NPT¾</td><td>0,98</td><td>4,88</td><td>3,26</td><td>1,88</td><td>1,61</td><td>UNC1/8</td><td>0,98</td><td>0,38</td></tr> <tr><td>2</td><td>2811 5012 80</td><td>NPT1</td><td>0,98</td><td>5,31</td><td>39,54</td><td>1,83</td><td>1,41</td><td>UNC1/8</td><td>0,98</td><td>0,37</td></tr> <tr><td>2</td><td>2811 5112 80</td><td>NPT¾</td><td>0,98</td><td>5,31</td><td>3,74</td><td>1,83</td><td>1,61</td><td>UNC1/8</td><td>0,98</td><td>0,41</td></tr> <tr><td>2½</td><td>2811 6012 80</td><td>NPT1½</td><td>0,98</td><td>5,83</td><td>4,13</td><td>1,91</td><td>1,41</td><td>UNC1/8</td><td>0,98</td><td>0,19</td></tr> <tr><td>2½</td><td>2811 6112 80</td><td>NPT1</td><td>0,98</td><td>5,82</td><td>4,33</td><td>1,91</td><td>1,61</td><td>UNC1/8</td><td>0,98</td><td>0,46</td></tr> <tr><td>3</td><td>2811 7012 80</td><td>NPT2</td><td>0,98</td><td>6,57</td><td>4,80</td><td>1,90</td><td>1,41</td><td>UNC1/8</td><td>0,98</td><td>0,49</td></tr> <tr><td>3</td><td>2811 7112 80</td><td>NPT1½</td><td>0,98</td><td>6,57</td><td>5</td><td>1,90</td><td>1,61</td><td>UNC1/8</td><td>0,98</td><td>0,53</td></tr> </tbody> </table>	D1	Part Number	NPT	Th	L	H	W1	W	D	N	ib	1	2811 2012 80	NPT½	0,98	4,21	2,55	1,49	1,41	UNC1/8	0,59	0,26	1½	2811 4012 80	NPT¾	0,98	4,88	3,11	1,88	1,41	UNC1/8	0,98	0,33	1½	2811 4112 80	NPT¾	0,98	4,88	3,26	1,88	1,61	UNC1/8	0,98	0,38	2	2811 5012 80	NPT1	0,98	5,31	39,54	1,83	1,41	UNC1/8	0,98	0,37	2	2811 5112 80	NPT¾	0,98	5,31	3,74	1,83	1,61	UNC1/8	0,98	0,41	2½	2811 6012 80	NPT1½	0,98	5,83	4,13	1,91	1,41	UNC1/8	0,98	0,19	2½	2811 6112 80	NPT1	0,98	5,82	4,33	1,91	1,61	UNC1/8	0,98	0,46	3	2811 7012 80	NPT2	0,98	6,57	4,80	1,90	1,41	UNC1/8	0,98	0,49	3	2811 7112 80	NPT1½	0,98	6,57	5	1,90	1,61	UNC1/8	0,98	0,53																									
D1	Part Number	NPT	Th	L	H	W1	W	D	N	Kg.																																																																																																																																																																																																																																			
25	2811 2012 80	NPT½	25	107	65	38	36	M6	15	0,12																																																																																																																																																																																																																																			
40	2811 4012 80	NPT¾	25	124	79	48	36	M6	25	0,15																																																																																																																																																																																																																																			
50	2811 5012 80	NPT1	25	135	90	46,5	36	M6	25	0,17																																																																																																																																																																																																																																			
50	2811 5112 80	NPT¾	25	135	95	46,5	41	M6	25	0,19																																																																																																																																																																																																																																			
63	2811 6012 80	NPT1½	25	148	105	48	36	M6	25	0,19																																																																																																																																																																																																																																			
63	2811 6112 80	NPT1	25	148	105	48,6	41	M6	25	0,21																																																																																																																																																																																																																																			
80	2811 7012 80	NPT2	25	167	122	48,5	36	M6	25	0,22																																																																																																																																																																																																																																			
80	2811 7112 80	NPT1½	25	167	127	48,5	41	M6	25	0,24																																																																																																																																																																																																																																			
D1	Part Number	NPT	Th	L	H	W1	W	D	N	ib																																																																																																																																																																																																																																			
1	2811 2012 80	NPT½	0,98	4,21	2,55	1,49	1,41	UNC1/8	0,59	0,26																																																																																																																																																																																																																																			
1½	2811 4012 80	NPT¾	0,98	4,88	3,11	1,88	1,41	UNC1/8	0,98	0,33																																																																																																																																																																																																																																			
1½	2811 4112 80	NPT¾	0,98	4,88	3,26	1,88	1,61	UNC1/8	0,98	0,38																																																																																																																																																																																																																																			
2	2811 5012 80	NPT1	0,98	5,31	39,54	1,83	1,41	UNC1/8	0,98	0,37																																																																																																																																																																																																																																			
2	2811 5112 80	NPT¾	0,98	5,31	3,74	1,83	1,61	UNC1/8	0,98	0,41																																																																																																																																																																																																																																			
2½	2811 6012 80	NPT1½	0,98	5,83	4,13	1,91	1,41	UNC1/8	0,98	0,19																																																																																																																																																																																																																																			
2½	2811 6112 80	NPT1	0,98	5,82	4,33	1,91	1,61	UNC1/8	0,98	0,46																																																																																																																																																																																																																																			
3	2811 7012 80	NPT2	0,98	6,57	4,80	1,90	1,41	UNC1/8	0,98	0,49																																																																																																																																																																																																																																			
3	2811 7112 80	NPT1½	0,98	6,57	5	1,90	1,61	UNC1/8	0,98	0,53																																																																																																																																																																																																																																			
<p>13</p> <p>ADAPTER UNION FEMALE ISO 228</p>		<table border="1"> <thead> <tr> <th>D1</th> <th>Part Number</th> <th>G</th> <th>Th</th> <th>L</th> <th>W</th> <th>N</th> <th>N</th> <th>Kg.</th> </tr> </thead> <tbody> <tr><td>20</td><td>2811 1118 80</td><td>G½</td><td>25</td><td>131,8</td><td>44</td><td>41</td><td>0,11</td></tr> <tr><td>25</td><td>2811 2218 80</td><td>G1</td><td>30</td><td>164,1</td><td>68,5</td><td>39</td><td>0,27</td></tr> <tr><td>40</td><td>2811 4418 80</td><td>G1½</td><td>40</td><td>219,4</td><td>67,8</td><td>75</td><td>0,60</td></tr> <tr><td>50</td><td>2811 5518 80</td><td>G2</td><td>35</td><td>234,6</td><td>83,9</td><td>75</td><td>0,69</td></tr> <tr><td>63</td><td>2811 6618 80*</td><td>G2½</td><td>26</td><td>176</td><td>89</td><td>109</td><td>1,59</td></tr> <tr><td>80</td><td>2811 7718 80*</td><td>G3</td><td>34</td><td>196</td><td>113</td><td>126</td><td>3,42</td></tr> </tbody> </table> <p>(*) Refer Fig. B for dimensions.</p>	D1	Part Number	G	Th	L	W	N	N	Kg.	20	2811 1118 80	G½	25	131,8	44	41	0,11	25	2811 2218 80	G1	30	164,1	68,5	39	0,27	40	2811 4418 80	G1½	40	219,4	67,8	75	0,60	50	2811 5518 80	G2	35	234,6	83,9	75	0,69	63	2811 6618 80*	G2½	26	176	89	109	1,59	80	2811 7718 80*	G3	34	196	113	126	3,42	<table border="1"> <thead> <tr> <th>D1</th> <th>Part Number</th> <th>G</th> <th>Th</th> <th>L</th> <th>W</th> <th>N</th> <th>ib</th> </tr> </thead> <tbody> <tr><td>½</td><td>2811 1118 80</td><td>G½</td><td>0,98</td><td>5,18</td><td>1,73</td><td>1,61</td><td>0,24</td></tr> <tr><td>1</td><td>2811 2218 80</td><td>G1</td><td>1,18</td><td>6,46</td><td>2,69</td><td>1,53</td><td>0,59</td></tr> <tr><td>1½</td><td>2811 4418 80</td><td>G1½</td><td>1,57</td><td>8,64</td><td>2,67</td><td>2,95</td><td>1,33</td></tr> <tr><td>2</td><td>2811 5518 80</td><td>G2</td><td>1,37</td><td>9,24</td><td>3,3</td><td>2,95</td><td>1,52</td></tr> <tr><td>2½</td><td>2811 6618 80*</td><td>G2½</td><td>1,06</td><td>7,16</td><td>3,50</td><td>4,44</td><td>5,43</td></tr> <tr><td>3</td><td>2811 7718 80*</td><td>G3</td><td>1,33</td><td>7,71</td><td>4,44</td><td>4,96</td><td>7,52</td></tr> </tbody> </table> <p>(*) Refer Fig. B for dimensions.</p>	D1	Part Number	G	Th	L	W	N	ib	½	2811 1118 80	G½	0,98	5,18	1,73	1,61	0,24	1	2811 2218 80	G1	1,18	6,46	2,69	1,53	0,59	1½	2811 4418 80	G1½	1,57	8,64	2,67	2,95	1,33	2	2811 5518 80	G2	1,37	9,24	3,3	2,95	1,52	2½	2811 6618 80*	G2½	1,06	7,16	3,50	4,44	5,43	3	2811 7718 80*	G3	1,33	7,71	4,44	4,96	7,52																																																																																																																									
D1	Part Number	G	Th	L	W	N	N	Kg.																																																																																																																																																																																																																																					
20	2811 1118 80	G½	25	131,8	44	41	0,11																																																																																																																																																																																																																																						
25	2811 2218 80	G1	30	164,1	68,5	39	0,27																																																																																																																																																																																																																																						
40	2811 4418 80	G1½	40	219,4	67,8	75	0,60																																																																																																																																																																																																																																						
50	2811 5518 80	G2	35	234,6	83,9	75	0,69																																																																																																																																																																																																																																						
63	2811 6618 80*	G2½	26	176	89	109	1,59																																																																																																																																																																																																																																						
80	2811 7718 80*	G3	34	196	113	126	3,42																																																																																																																																																																																																																																						
D1	Part Number	G	Th	L	W	N	ib																																																																																																																																																																																																																																						
½	2811 1118 80	G½	0,98	5,18	1,73	1,61	0,24																																																																																																																																																																																																																																						
1	2811 2218 80	G1	1,18	6,46	2,69	1,53	0,59																																																																																																																																																																																																																																						
1½	2811 4418 80	G1½	1,57	8,64	2,67	2,95	1,33																																																																																																																																																																																																																																						
2	2811 5518 80	G2	1,37	9,24	3,3	2,95	1,52																																																																																																																																																																																																																																						
2½	2811 6618 80*	G2½	1,06	7,16	3,50	4,44	5,43																																																																																																																																																																																																																																						
3	2811 7718 80*	G3	1,33	7,71	4,44	4,96	7,52																																																																																																																																																																																																																																						
<p>14</p> <p>ADAPTER UNION FEMALE NPT</p>		<table border="1"> <thead> <tr> <th>D1</th> <th>Part Number</th> <th>NPT</th> <th>Th</th> <th>L</th> <th>W</th> <th>N</th> <th>Kg.</th> </tr> </thead> <tbody> <tr><td>20</td><td>2811 1114 80</td><td>NPT¾</td><td>25</td><td>131,8</td><td>44</td><td>34</td><td>0,11</td></tr> <tr><td>25</td><td>2811 2214 80</td><td>NPT1</td><td>30</td><td>164,1</td><td>68,5</td><td>39</td><td>0,27</td></tr> <tr><td>40</td><td>2811 4414 80</td><td>NPT1½</td><td>40</td><td>219,4</td><td>67,8</td><td>75</td><td>0,60</td></tr> <tr><td>50</td><td>2811 5514 80</td><td>NPT2</td><td>35</td><td>234,6</td><td>83,9</td><td>75</td><td>0,69</td></tr> <tr><td>63</td><td>2811 6614 80*</td><td>NPT2½</td><td>26</td><td>176</td><td>89</td><td>109</td><td>1,59</td></tr> <tr><td>80</td><td>2811 7714 80*</td><td>NPT3</td><td>29</td><td>189</td><td>113</td><td>123</td><td>3,20</td></tr> </tbody> </table> <p>(*) Refer Fig. B for dimensions.</p>	D1	Part Number	NPT	Th	L	W	N	Kg.	20	2811 1114 80	NPT¾	25	131,8	44	34	0,11	25	2811 2214 80	NPT1	30	164,1	68,5	39	0,27	40	2811 4414 80	NPT1½	40	219,4	67,8	75	0,60	50	2811 5514 80	NPT2	35	234,6	83,9	75	0,69	63	2811 6614 80*	NPT2½	26	176	89	109	1,59	80	2811 7714 80*	NPT3	29	189	113	123	3,20	<table border="1"> <thead> <tr> <th>D1</th> <th>Part Number</th> <th>G</th> <th>Th</th> <th>L</th> <th>W</th> <th>N</th> <th>ib</th> </tr> </thead> <tbody> <tr><td>¾</td><td>2811 1114 80</td><td>NPT¾</td><td>0,98</td><td>5,18</td><td>1,73</td><td>1,33</td><td>0,24</td></tr> <tr><td>1</td><td>2811 2214 80</td><td>NPT1</td><td>1,18</td><td>6,46</td><td>2,69</td><td>1,53</td><td>0,59</td></tr> <tr><td>1½</td><td>2811 4414 80</td><td>NPT1½</td><td>1,57</td><td>8,64</td><td>2,67</td><td>2,95</td><td>1,33</td></tr> <tr><td>2</td><td>2811 5514 80</td><td>NPT2</td><td>1,37</td><td>9,24</td><td>3,3</td><td>2,95</td><td>1,52</td></tr> <tr><td>2½</td><td>2811 6614 80*</td><td>NPT2½</td><td>1,03</td><td>6,92</td><td>3,50</td><td>4,29</td><td>5,69</td></tr> <tr><td>3</td><td>2811 7714 80*</td><td>NPT3</td><td>1,14</td><td>7,44</td><td>4,44</td><td>4,84</td><td>7,04</td></tr> </tbody> </table> <p>(*) Refer Fig. B for dimensions.</p>	D1	Part Number	G	Th	L	W	N	ib	¾	2811 1114 80	NPT¾	0,98	5,18	1,73	1,33	0,24	1	2811 2214 80	NPT1	1,18	6,46	2,69	1,53	0,59	1½	2811 4414 80	NPT1½	1,57	8,64	2,67	2,95	1,33	2	2811 5514 80	NPT2	1,37	9,24	3,3	2,95	1,52	2½	2811 6614 80*	NPT2½	1,03	6,92	3,50	4,29	5,69	3	2811 7714 80*	NPT3	1,14	7,44	4,44	4,84	7,04																																																																																																																										
D1	Part Number	NPT	Th	L	W	N	Kg.																																																																																																																																																																																																																																						
20	2811 1114 80	NPT¾	25	131,8	44	34	0,11																																																																																																																																																																																																																																						
25	2811 2214 80	NPT1	30	164,1	68,5	39	0,27																																																																																																																																																																																																																																						
40	2811 4414 80	NPT1½	40	219,4	67,8	75	0,60																																																																																																																																																																																																																																						
50	2811 5514 80	NPT2	35	234,6	83,9	75	0,69																																																																																																																																																																																																																																						
63	2811 6614 80*	NPT2½	26	176	89	109	1,59																																																																																																																																																																																																																																						
80	2811 7714 80*	NPT3	29	189	113	123	3,20																																																																																																																																																																																																																																						
D1	Part Number	G	Th	L	W	N	ib																																																																																																																																																																																																																																						
¾	2811 1114 80	NPT¾	0,98	5,18	1,73	1,33	0,24																																																																																																																																																																																																																																						
1	2811 2214 80	NPT1	1,18	6,46	2,69	1,53	0,59																																																																																																																																																																																																																																						
1½	2811 4414 80	NPT1½	1,57	8,64	2,67	2,95	1,33																																																																																																																																																																																																																																						
2	2811 5514 80	NPT2	1,37	9,24	3,3	2,95	1,52																																																																																																																																																																																																																																						
2½	2811 6614 80*	NPT2½	1,03	6,92	3,50	4,29	5,69																																																																																																																																																																																																																																						
3	2811 7714 80*	NPT3	1,14	7,44	4,44	4,84	7,04																																																																																																																																																																																																																																						
<p>17</p> <p>NIPPLE SOCKET ALU THREADED MALE ISO 7-R</p>		<table border="1"> <thead> <tr> <th>D1</th> <th>Part Number</th> <th>ISO-7-R</th> <th>Th</th> <th>L</th> <th>W</th> <th>N</th> <th>S</th> <th>Kg.</th> </tr> </thead> <tbody> <tr><td>20</td><td>2811 1017 80</td><td>ISO-7-R½</td><td>14,5</td><td>73,8</td><td>37,5</td><td>34</td><td>38,8</td><td>0,06</td></tr> <tr><td>20</td><td>2811 1117 80</td><td>ISO-7-R¾</td><td>16,3</td><td>73,8</td><td>37,5</td><td>34</td><td>38,8</td><td>0,06</td></tr> <tr><td>25</td><td>2811 2117 80</td><td>ISO-7-R1</td><td>15,8</td><td>86</td><td>43,5</td><td>39</td><td>44</td><td>0,09</td></tr> <tr><td>25</td><td>2811 2217 80</td><td>ISO-7-R1</td><td>19,1</td><td>86</td><td>43,5</td><td>39</td><td>44</td><td>0,09</td></tr> <tr><td>40</td><td>2811 4317 80</td><td>ISO-7-R1½</td><td>21,4</td><td>127,4</td><td>67,8</td><td>45</td><td>63</td><td>0,27</td></tr> <tr><td>40</td><td>2811 4417 80</td><td>ISO-7-R1½</td><td>21,4</td><td>127,4</td><td>67,8</td><td>45</td><td>63</td><td>0,27</td></tr> <tr><td>50</td><td>2811 5417 80</td><td>ISO-7-R2</td><td>25,7</td><td>141</td><td>83,9</td><td>55</td><td>78</td><td>0,47</td></tr> <tr><td>50</td><td>2811 5517 80</td><td>ISO-7-R2</td><td>25,7</td><td>141</td><td>83,9</td><td>55</td><td>78</td><td>0,46</td></tr> <tr><td>63</td><td>2811 6517 80*</td><td>ISO-7-R2½</td><td>26</td><td>127,4</td><td>89</td><td>96</td><td>78</td><td>0,69</td></tr> <tr><td>63</td><td>2811 6617 80*</td><td>ISO-7-R2½</td><td>30</td><td>127</td><td>89</td><td>96</td><td>78</td><td>0,68</td></tr> <tr><td>80</td><td>2811 7617 80*</td><td>ISO-7-R3</td><td>30</td><td>131</td><td>113</td><td>97</td><td>97</td><td>0,90</td></tr> <tr><td>80</td><td>2811 7717 80*</td><td>ISO-7-R3</td><td>33</td><td>134</td><td>113</td><td>97</td><td>97</td><td>0,92</td></tr> </tbody> </table> <p>(*) Refer Fig. B for dimensions.</p>	D1	Part Number	ISO-7-R	Th	L	W	N	S	Kg.	20	2811 1017 80	ISO-7-R½	14,5	73,8	37,5	34	38,8	0,06	20	2811 1117 80	ISO-7-R¾	16,3	73,8	37,5	34	38,8	0,06	25	2811 2117 80	ISO-7-R1	15,8	86	43,5	39	44	0,09	25	2811 2217 80	ISO-7-R1	19,1	86	43,5	39	44	0,09	40	2811 4317 80	ISO-7-R1½	21,4	127,4	67,8	45	63	0,27	40	2811 4417 80	ISO-7-R1½	21,4	127,4	67,8	45	63	0,27	50	2811 5417 80	ISO-7-R2	25,7	141	83,9	55	78	0,47	50	2811 5517 80	ISO-7-R2	25,7	141	83,9	55	78	0,46	63	2811 6517 80*	ISO-7-R2½	26	127,4	89	96	78	0,69	63	2811 6617 80*	ISO-7-R2½	30	127	89	96	78	0,68	80	2811 7617 80*	ISO-7-R3	30	131	113	97	97	0,90	80	2811 7717 80*	ISO-7-R3	33	134	113	97	97	0,92	<table border="1"> <thead> <tr> <th>D1</th> <th>Part Number</th> <th>G</th> <th>Th</th> <th>L</th> <th>W</th> <th>N</th> <th>S</th> <th>ib</th> </tr> </thead> <tbody> <tr><td>¾</td><td>2811 1017 80</td><td>ISO-7-R½</td><td>0,57</td><td>2,90</td><td>1,47</td><td>1,33</td><td>1,52</td><td>0,13</td></tr> <tr><td>¾</td><td>2811 1117 80</td><td>ISO-7-R¾</td><td>0,64</td><td>2,90</td><td>1,47</td><td>1,33</td><td>1,52</td><td>0,13</td></tr> <tr><td>1</td><td>2811 2117 80</td><td>ISO-7-R1</td><td>0,62</td><td>3,38</td><td>1,71</td><td>1,53</td><td>1,73</td><td>0,21</td></tr> <tr><td>1</td><td>2811 2217 80</td><td>ISO-7-R1</td><td>0,75</td><td>3,38</td><td>1,71</td><td>1,53</td><td>1,73</td><td>0,21</td></tr> <tr><td>1½</td><td>2811 4317 80</td><td>ISO-7-R1½</td><td>0,84</td><td>5,02</td><td>2,67</td><td>1,77</td><td>2,48</td><td>0,70</td></tr> <tr><td>1½</td><td>2811 4417 80</td><td>ISO-7-R1½</td><td>0,84</td><td>5,02</td><td>2,67</td><td>1,77</td><td>2,48</td><td>0,60</td></tr> <tr><td>2</td><td>2811 5417 80</td><td>ISO-7-R2</td><td>1,01</td><td>5,55</td><td>3,3</td><td>2,17</td><td>3,07</td><td>1,02</td></tr> <tr><td>2</td><td>2811 5517 80</td><td>ISO-7-R2</td><td>1,04</td><td>5,55</td><td>3,3</td><td>2,17</td><td>3,07</td><td>1,02</td></tr> <tr><td>2½</td><td>2811 6517 80*</td><td>ISO-7-R2½</td><td>1,02</td><td>4,84</td><td>3,5</td><td>3,77</td><td>3,07</td><td>1,51</td></tr> <tr><td>2½</td><td>2811 6617 80*</td><td>ISO-7-R2½</td><td>1,18</td><td>5</td><td>3,5</td><td>3,77</td><td>3,07</td><td>1,49</td></tr> <tr><td>3</td><td>2811 7617 80*</td><td>ISO-7-R3</td><td>1,18</td><td>5,15</td><td>4,4</td><td>3,81</td><td>3,81</td><td>2,00</td></tr> <tr><td>3</td><td>2811 7717 80*</td><td>ISO-7-R3</td><td>1,29</td><td>5,27</td><td>4,4</td><td>3,81</td><td>3,81</td><td>2,03</td></tr> </tbody> </table> <p>(*) Refer Fig. B for dimensions.</p>	D1	Part Number	G	Th	L	W	N	S	ib	¾	2811 1017 80	ISO-7-R½	0,57	2,90	1,47	1,33	1,52	0,13	¾	2811 1117 80	ISO-7-R¾	0,64	2,90	1,47	1,33	1,52	0,13	1	2811 2117 80	ISO-7-R1	0,62	3,38	1,71	1,53	1,73	0,21	1	2811 2217 80	ISO-7-R1	0,75	3,38	1,71	1,53	1,73	0,21	1½	2811 4317 80	ISO-7-R1½	0,84	5,02	2,67	1,77	2,48	0,70	1½	2811 4417 80	ISO-7-R1½	0,84	5,02	2,67	1,77	2,48	0,60	2	2811 5417 80	ISO-7-R2	1,01	5,55	3,3	2,17	3,07	1,02	2	2811 5517 80	ISO-7-R2	1,04	5,55	3,3	2,17	3,07	1,02	2½	2811 6517 80*	ISO-7-R2½	1,02	4,84	3,5	3,77	3,07	1,51	2½	2811 6617 80*	ISO-7-R2½	1,18	5	3,5	3,77	3,07	1,49	3	2811 7617 80*	ISO-7-R3	1,18	5,15	4,4	3,81	3,81	2,00	3	2811 7717 80*	ISO-7-R3	1,29	5,27	4,4	3,81	3,81	2,03
D1	Part Number	ISO-7-R	Th	L	W	N	S	Kg.																																																																																																																																																																																																																																					
20	2811 1017 80	ISO-7-R½	14,5	73,8	37,5	34	38,8	0,06																																																																																																																																																																																																																																					
20	2811 1117 80	ISO-7-R¾	16,3	73,8	37,5	34	38,8	0,06																																																																																																																																																																																																																																					
25	2811 2117 80	ISO-7-R1	15,8	86	43,5	39	44	0,09																																																																																																																																																																																																																																					
25	2811 2217 80	ISO-7-R1	19,1	86	43,5	39	44	0,09																																																																																																																																																																																																																																					
40	2811 4317 80	ISO-7-R1½	21,4	127,4	67,8	45	63	0,27																																																																																																																																																																																																																																					
40	2811 4417 80	ISO-7-R1½	21,4	127,4	67,8	45	63	0,27																																																																																																																																																																																																																																					
50	2811 5417 80	ISO-7-R2	25,7	141	83,9	55	78	0,47																																																																																																																																																																																																																																					
50	2811 5517 80	ISO-7-R2	25,7	141	83,9	55	78	0,46																																																																																																																																																																																																																																					
63	2811 6517 80*	ISO-7-R2½	26	127,4	89	96	78	0,69																																																																																																																																																																																																																																					
63	2811 6617 80*	ISO-7-R2½	30	127	89	96	78	0,68																																																																																																																																																																																																																																					
80	2811 7617 80*	ISO-7-R3	30	131	113	97	97	0,90																																																																																																																																																																																																																																					
80	2811 7717 80*	ISO-7-R3	33	134	113	97	97	0,92																																																																																																																																																																																																																																					
D1	Part Number	G	Th	L	W	N	S	ib																																																																																																																																																																																																																																					
¾	2811 1017 80	ISO-7-R½	0,57	2,90	1,47	1,33	1,52	0,13																																																																																																																																																																																																																																					
¾	2811 1117 80	ISO-7-R¾	0,64	2,90	1,47	1,33	1,52	0,13																																																																																																																																																																																																																																					
1	2811 2117 80	ISO-7-R1	0,62	3,38	1,71	1,53	1,73	0,21																																																																																																																																																																																																																																					
1	2811 2217 80	ISO-7-R1	0,75	3,38	1,71	1,53	1,73	0,21																																																																																																																																																																																																																																					
1½	2811 4317 80	ISO-7-R1½	0,84	5,02	2,67	1,77	2,48	0,70																																																																																																																																																																																																																																					
1½	2811 4417 80	ISO-7-R1½	0,84	5,02	2,67	1,77	2,48	0,60																																																																																																																																																																																																																																					
2	2811 5417 80	ISO-7-R2	1,01	5,55	3,3	2,17	3,07	1,02																																																																																																																																																																																																																																					
2	2811 5517 80	ISO-7-R2	1,04	5,55	3,3	2,17	3,07	1,02																																																																																																																																																																																																																																					
2½	2811 6517 80*	ISO-7-R2½	1,02	4,84	3,5	3,77	3,07	1,51																																																																																																																																																																																																																																					
2½	2811 6617 80*	ISO-7-R2½	1,18	5	3,5	3,77	3,07	1,49																																																																																																																																																																																																																																					
3	2811 7617 80*	ISO-7-R3	1,18	5,15	4,4	3,81	3,81	2,00																																																																																																																																																																																																																																					
3	2811 7717 80*	ISO-7-R3	1,29	5,27	4,4	3,81	3,81	2,03																																																																																																																																																																																																																																					
<p>18</p> <p>NIPPLE SOCKET ALU THREADED MALE NPT</p>		<table border="1"> <thead> <tr> <th>D1</th> <th>Part Number</th> <th>NPT</th> <th>Th</th> <th>L</th> <th>W</th> <th>N</th> <th>S</th> <th>Kg.</th> </tr> </thead> <tbody> <tr><td>20</td><td>2811 1018 80</td><td>NPT¾</td><td>15,4</td><td>73,8</td><td>37,5</td><td>34</td><td>38,8</td><td>0,06</td></tr> <tr><td>20</td><td>2811 1118 80</td><td>NPT¾</td><td>20,2</td><td>73,8</td><td>37,5</td><td>34</td><td>38,8</td><td>0,06</td></tr> <tr><td>25</td><td>2811 2118 80</td><td>NPT1</td><td>19,7</td><td>86</td><td>43,5</td><td>39</td><td>44</td><td>0,09</td></tr> <tr><td>25</td><td>2811 2218 80</td><td>NPT1</td><td>25</td><td>86</td><td>43,5</td><td>39</td><td>44</td><td>0,09</td></tr> <tr><td>40</td><td>2811 4318 80</td><td>NPT1½</td><td>26</td><td>127,4</td><td>67,8</td><td>45</td><td>63</td><td>0,27</td></tr> <tr><td>40</td><td>2811 4418 80</td><td>NPT1½</td><td>26</td><td>127,4</td><td>67,8</td><td>45</td><td>63</td><td>0,27</td></tr> <tr><td>50</td><td>2811 5418 80</td><td>NPT2</td><td>26</td><td>141</td><td>83,9</td><td>55</td><td>78</td><td>0,46</td></tr> <tr><td>50</td><td>2811 5518 80</td><td>NPT2</td><td>26,4</td><td>141</td><td>83,9</td><td>55</td><td>78</td><td>0,46</td></tr> <tr><td>63</td><td>2811 6518 80*</td><td>NPT2½</td><td>26</td><td>127,4</td><td>89</td><td>96</td><td>78</td><td>0,69</td></tr> <tr><td>63</td><td>2811 6618 80*</td><td>NPT2½</td><td>30</td><td>127</td><td>89</td><td>96</td><td>78</td><td>0,64</td></tr> <tr><td>80</td><td>2811 7618 80*</td><td>NPT3</td><td>30</td><td>131</td><td>113</td><td>97</td><td>97</td><td>0,90</td></tr> <tr><td>80</td><td>2811 7718 80*</td><td>NPT3</td><td>33</td><td>134</td><td>113</td><td>97</td><td>97</td><td>0,91</td></tr> </tbody> </table> <p>(*) Refer Fig. B for dimensions.</p>	D1	Part Number	NPT	Th	L	W	N	S	Kg.	20	2811 1018 80	NPT¾	15,4	73,8	37,5	34	38,8	0,06	20	2811 1118 80	NPT¾	20,2	73,8	37,5	34	38,8	0,06	25	2811 2118 80	NPT1	19,7	86	43,5	39	44	0,09	25	2811 2218 80	NPT1	25	86	43,5	39	44	0,09	40	2811 4318 80	NPT1½	26	127,4	67,8	45	63	0,27	40	2811 4418 80	NPT1½	26	127,4	67,8	45	63	0,27	50	2811 5418 80	NPT2	26	141	83,9	55	78	0,46	50	2811 5518 80	NPT2	26,4	141	83,9	55	78	0,46	63	2811 6518 80*	NPT2½	26	127,4	89	96	78	0,69	63	2811 6618 80*	NPT2½	30	127	89	96	78	0,64	80	2811 7618 80*	NPT3	30	131	113	97	97	0,90	80	2811 7718 80*	NPT3	33	134	113	97	97	0,91	<table border="1"> <thead> <tr> <th>D1</th> <th>Part Number</th> <th>NPT</th> <th>Th</th> <th>L</th> <th>W</th> <th>N</th> <th>S</th> <th>ib</th> </tr> </thead> <tbody> <tr><td>¾</td><td>2811 1018 80</td><td>NPT¾</td><td>0,76</td><td>2,90</td><td>1,47</td><td>1,33</td><td>1,52</td><td>0,13</td></tr> <tr><td>¾</td><td>2811 1118 80</td><td>NPT¾</td><td>0,79</td><td>2,90</td><td>1,47</td><td>1,33</td><td>1,52</td><td>0,13</td></tr> <tr><td>1</td><td>2811 2118 80</td><td>NPT1</td><td>0,77</td><td>3,38</td><td>1,71</td><td>1,53</td><td>1,73</td><td>0,20</td></tr> <tr><td>1</td><td>2811 2218 80</td><td>NPT1</td><td>0,98</td><td>3,38</td><td>1,71</td><td>1,53</td><td>1,73</td><td>0,20</td></tr> <tr><td>1½</td><td>2811 4318 80</td><td>NPT1½</td><td>1,02</td><td>5,02</td><td>2,67</td><td>1,77</td><td>2,48</td><td>0,70</td></tr> <tr><td>1½</td><td>2811 4418 80</td><td>NPT1½</td><td>1,02</td><td>5,02</td><td>2,67</td><td>1,77</td><td>2,48</td><td>0,60</td></tr> <tr><td>2</td><td>2811 5418 80</td><td>NPT2</td><td>1,02</td><td>5,55</td><td>3,3</td><td>2,17</td><td>3,07</td><td>1,02</td></tr> <tr><td>2</td><td>2811 5518 80</td><td>NPT2</td><td>1,04</td><td>5,55</td><td>3,3</td><td>2,17</td><td>3,07</td><td>1,02</td></tr> <tr><td>2½</td><td>2811 6518 80*</td><td>NPT2½</td><td>1,02</td><td>4,84</td><td>3,5</td><td>3,77</td><td>3,07</td><td>1,51</td></tr> <tr><td>2½</td><td>2811 6618 80*</td><td>NPT2½</td><td>1,18</td><td>5</td><td>3,5</td><td>3,77</td><td>3,07</td><td>1,40</td></tr> <tr><td>3</td><td>2811 7618 80*</td><td>NPT3</td><td>1,18</td><td>5,15</td><td>4,4</td><td>3,81</td><td>3,81</td><td>1,98</td></tr> <tr><td>3</td><td>2811 7718 80*</td><td>NPT3</td><td>1,18</td><td>5,27</td><td>4,4</td><td>3,81</td><td>3,81</td><td>2,00</td></tr> </tbody> </table> <p>(*) Refer Fig. B for dimensions.</p>	D1	Part Number	NPT	Th	L	W	N	S	ib	¾	2811 1018 80	NPT¾	0,76	2,90	1,47	1,33	1,52	0,13	¾	2811 1118 80	NPT¾	0,79	2,90	1,47	1,33	1,52	0,13	1	2811 2118 80	NPT1	0,77	3,38	1,71	1,53	1,73	0,20	1	2811 2218 80	NPT1	0,98	3,38	1,71	1,53	1,73	0,20	1½	2811 4318 80	NPT1½	1,02	5,02	2,67	1,77	2,48	0,70	1½	2811 4418 80	NPT1½	1,02	5,02	2,67	1,77	2,48	0,60	2	2811 5418 80	NPT2	1,02	5,55	3,3	2,17	3,07	1,02	2	2811 5518 80	NPT2	1,04	5,55	3,3	2,17	3,07	1,02	2½	2811 6518 80*	NPT2½	1,02	4,84	3,5	3,77	3,07	1,51	2½	2811 6618 80*	NPT2½	1,18	5	3,5	3,77	3,07	1,40	3	2811 7618 80*	NPT3	1,18	5,15	4,4	3,81	3,81	1,98	3	2811 7718 80*	NPT3	1,18	5,27	4,4	3,81	3,81	2,00
D1	Part Number	NPT	Th	L	W	N	S	Kg.																																																																																																																																																																																																																																					
20	2811 1018 80	NPT¾	15,4	73,8	37,5	34	38,8	0,06																																																																																																																																																																																																																																					
20	2811 1118 80	NPT¾	20,2	73,8	37,5	34	38,8	0,06																																																																																																																																																																																																																																					
25	2811 2118 80	NPT1	19,7	86	43,5	39	44	0,09																																																																																																																																																																																																																																					
25	2811 2218 80	NPT1	25	86	43,5	39	44	0,09																																																																																																																																																																																																																																					
40	2811 4318 80	NPT1½	26	127,4	67,8	45	63	0,27																																																																																																																																																																																																																																					
40	2811 4418 80	NPT1½	26	127,4	67,8	45	63	0,27																																																																																																																																																																																																																																					
50	2811 5418 80	NPT2	26	141	83,9	55	78	0,46																																																																																																																																																																																																																																					
50	2811 5518 80	NPT2	26,4	141	83,9	55	78	0,46																																																																																																																																																																																																																																					
63	2811 6518 80*	NPT2½	26	127,4	89	96	78	0,69																																																																																																																																																																																																																																					
63	2811 6618 80*	NPT2½	30	127	89	96	78	0,64																																																																																																																																																																																																																																					
80	2811 7618 80*	NPT3	30	131	113	97	97	0,90																																																																																																																																																																																																																																					
80	2811 7718 80*	NPT3	33	134	113	97	97	0,91																																																																																																																																																																																																																																					
D1	Part Number	NPT	Th	L	W	N	S	ib																																																																																																																																																																																																																																					
¾	2811 1018 80	NPT¾	0,76	2,90	1,47	1,33	1,52	0,13																																																																																																																																																																																																																																					
¾	2811 1118 80	NPT¾	0,79	2,90	1,47	1,33	1,52	0,13																																																																																																																																																																																																																																					
1	2811 2118 80	NPT1	0,77	3,38	1,71	1,53	1,73	0,20																																																																																																																																																																																																																																					
1	2811 2218 80	NPT1	0,98	3,38	1,71	1,53	1,73	0,20																																																																																																																																																																																																																																					
1½	2811 4318 80	NPT1½	1,02	5,02	2,67	1,77	2,48	0,70																																																																																																																																																																																																																																					
1½	2811 4418 80	NPT1½	1,02	5,02	2,67	1,77	2,48	0,60																																																																																																																																																																																																																																					
2	2811 5418 80	NPT2	1,02	5,55	3,3	2,17	3,07	1,02																																																																																																																																																																																																																																					
2	2811 5518 80	NPT2	1,04	5,55	3,3	2,17	3,07	1,02																																																																																																																																																																																																																																					
2½	2811 6518 80*	NPT2½	1,02	4,84	3,5	3,77	3,07	1,51																																																																																																																																																																																																																																					
2½	2811 6618 80*	NPT2½	1,18	5	3,5	3,77	3,07	1,40																																																																																																																																																																																																																																					
3	2811 7618 80*	NPT3	1,18	5,15	4,4	3,81	3,81	1,98																																																																																																																																																																																																																																					
3	2811 7718 80*	NPT3	1,18	5,27	4,4	3,81	3,81	2,00																																																																																																																																																																																																																																					
<p>19</p> <p>NIPPLE SOCKET FEMALE ISO228</p>		<table border="1"> <thead> <tr> <th>D1</th> <th>Part Number</th> <th>G</th> <th>Th</th> <th>L</th> <th>W</th> <th>N</th> <th>Kg.</th> </tr> </thead> <tbody> <tr><td>63</td><td>2811 6619 80</td><td>G2½</td><td>29</td><td>112</td><td>89</td><td>86</td><td>0,55</td></tr> </tbody> </table>	D1	Part Number	G	Th	L	W	N	Kg.	63	2811 6619 80	G2½	29	112	89	86	0,55	<table border="1"> <thead> <tr> <th>D1</th> <th>Part Number</th> <th>NPT</th> <th>Th</th> <th>L</th> <th>W</th> <th>N</th> <th>ib</th> </tr> </thead> <tbody> <tr><td>2½</td><td>2810 6619 80</td><td>G2½</td><td>1,14</td><td>4,40</td><td>3,5</td><td>3,38</td><td>1,21</td></tr> </tbody> </table>	D1	Part Number	NPT	Th	L	W	N	ib	2½	2810 6619 80	G2½	1,14	4,40	3,5	3,38	1,21																																																																																																																																																																																																										
D1	Part Number	G	Th	L	W	N	Kg.																																																																																																																																																																																																																																						
63	2811 6619 80	G2½	29	112	89	86	0,55																																																																																																																																																																																																																																						
D1	Part Number	NPT	Th	L	W	N	ib																																																																																																																																																																																																																																						
2½	2810 6619 80	G2½	1,14	4,40	3,5	3,38	1,21																																																																																																																																																																																																																																						
<p>19K1</p> <p>ADAPTER UNION KIT ISO 228</p>		<table border="1"> <thead> <tr> <th>D1</th> <th>Part Number</th> <th>G</th> <th>Th</th> <th>L1</th> <th>L2</th> <th>N1</th> <th>N2</th> <th>Kg.</th> </tr> </thead> <tbody> <tr><td>20</td><td>2811 0019 80</td><td>G½</td><td>25</td><td>17</td><td>45</td><td>36</td><td>24</td><td>0,06</td></tr> <tr><td>20</td><td>2811 1019 80</td><td>G½</td><td>25</td><td>17</td><td>45</td><td>36</td><td>24</td><td>0,05</td></tr> <tr><td>25</td><td>2811 2019 80</td><td>G1</td><td>25</td><td>17</td><td>45</td><td>41</td><td>30</td><td>0,07</td></tr> <tr><td>25</td><td>2811 2119 80</td><td>G¾</td><td>25</td><td>17</td><td>45</td><td>41</td><td>30</td><td>0,06</td></tr> <tr><td>40</td><td>2811 4219 80</td><td>G1½</td><td>35</td><td>58</td><td>23,5</td><td>61</td><td>40</td><td>0,18</td></tr> <tr><td>50</td><td>2811 5419 80</td><td>G1½</td><td>45,5</td><td>80</td><td>35</td><td>75</td><td>60</td><td>0,33</td></tr> <tr><td>50</td><td>2811 5519 80</td><td>G2</td><td>45,5</td><td>80</td><td>35</td><td>75</td><td>60</td><td>0,26</td></tr> <tr><td>63</td><td>2811 6519 80</td><td>G2</td><td>49</td><td>63</td><td>29</td><td>88</td><td>67</td><td>0,27</td></tr> <tr><td>80</td><td>2811 7619 80</td><td>G2½</td><td>48</td><td>66</td><td>25</td><td>111</td><td>86</td><td>0,52</td></tr> <tr><td>80</td><td>2811 7719 80</td><td>G3</td><td>39</td><td>73</td><td>32</td><td>111</td><td>93</td><td>0,45</td></tr> </tbody> </table>	D1	Part Number	G	Th	L1	L2	N1	N2	Kg.	20	2811 0019 80	G½	25	17	45	36	24	0,06	20	2811 1019 80	G½	25	17	45	36	24	0,05	25	2811 2019 80	G1	25	17	45	41	30	0,07	25	2811 2119 80	G¾	25	17	45	41	30	0,06	40	2811 4219 80	G1½	35	58	23,5	61	40	0,18	50	2811 5419 80	G1½	45,5	80	35	75	60	0,33	50	2811 5519 80	G2	45,5	80	35	75	60	0,26	63	2811 6519 80	G2	49	63	29	88	67	0,27	80	2811 7619 80	G2½	48	66	25	111	86	0,52	80	2811 7719 80	G3	39	73	32	111	93	0,45	<table border="1"> <thead> <tr> <th>D1</th> <th>Part Number</th> <th>G</th> <th>Th</th> <th>L1</th> <th>L2</th> <th>N1</th> <th>N2</th> <th>ib</th> </tr> </thead> <tbody> <tr><td>¾</td><td>2811 0019 80</td><td>G½</td><td>0,98</td><td>0,66</td><td>1,77</td><td>1,41</td><td>0,94</td><td>0,11</td></tr> <tr><td>¾</td><td>2811 1019 80</td><td>G½</td><td>0,98</td><td>0,66</td><td>1,77</td><td>1,41</td><td>0,94</td><td>0,11</td></tr> <tr><td>1</td><td>2811 2019 80</td><td>G1</td><td>0,98</td><td>0,66</td><td>1,77</td><td>1,61</td><td>1,18</td><td>0,16</td></tr> <tr><td>1</td><td>2811 2119 80</td><td>G¾</td><td>0,98</td><td>0,66</td><td>1,77</td><td>1,61</td><td>1,18</td><td>0,15</td></tr> <tr><td>1½</td><td>2811 4219 80</td><td>G1½</td><td>1,38</td><td>2,28</td><td>0,93</td><td>2,4</td><td>1,57</td><td>0,39</td></tr> <tr><td>2</td><td>2811 5419 80</td><td>G1½</td><td>1,79</td><td>3,15</td><td>1,38</td><td>2,95</td><td>2,36</td><td>0,73</td></tr> <tr><td>2</td><td>2811 5519 80</td><td>G2</td><td>1,19</td><td>3,15</td><td>1,38</td><td>2,95</td><td>2,36</td><td>0,78</td></tr> <tr><td>2½</td><td>2811 6519 80</td><td>G2</td><td>1,92</td><td>2,48</td><td>1,10</td><td>3,46</td><td>2,63</td><td>0,81</td></tr> <tr><td>3</td><td>2811 7619 80</td><td>G2½</td><td>1,88</td><td>2,59</td><td>0,98</td><td>4,37</td><td>3,38</td><td>1,14</td></tr> <tr><td>3</td><td>2811 7719 80</td><td>G3</td><td>1,53</td><td>2,87</td><td>1,25</td><td>4,37</td></tr></tbody></table>	D1	Part Number	G	Th	L1	L2	N1	N2	ib	¾	2811 0019 80	G½	0,98	0,66	1,77	1,41	0,94	0,11	¾	2811 1019 80	G½	0,98	0,66	1,77	1,41	0,94	0,11	1	2811 2019 80	G1	0,98	0,66	1,77	1,61	1,18	0,16	1	2811 2119 80	G¾	0,98	0,66	1,77	1,61	1,18	0,15	1½	2811 4219 80	G1½	1,38	2,28	0,93	2,4	1,57	0,39	2	2811 5419 80	G1½	1,79	3,15	1,38	2,95	2,36	0,73	2	2811 5519 80	G2	1,19	3,15	1,38	2,95	2,36	0,78	2½	2811 6519 80	G2	1,92	2,48	1,10	3,46	2,63	0,81	3	2811 7619 80	G2½	1,88	2,59	0,98	4,37	3,38	1,14	3	2811 7719 80	G3	1,53	2,87	1,25	4,37																																						
D1	Part Number	G	Th	L1	L2	N1	N2	Kg.																																																																																																																																																																																																																																					
20	2811 0019 80	G½	25	17	45	36	24	0,06																																																																																																																																																																																																																																					
20	2811 1019 80	G½	25	17	45	36	24	0,05																																																																																																																																																																																																																																					
25	2811 2019 80	G1	25	17	45	41	30	0,07																																																																																																																																																																																																																																					
25	2811 2119 80	G¾	25	17	45	41	30	0,06																																																																																																																																																																																																																																					
40	2811 4219 80	G1½	35	58	23,5	61	40	0,18																																																																																																																																																																																																																																					
50	2811 5419 80	G1½	45,5	80	35	75	60	0,33																																																																																																																																																																																																																																					
50	2811 5519 80	G2	45,5	80	35	75	60	0,26																																																																																																																																																																																																																																					
63	2811 6519 80	G2	49	63	29	88	67	0,27																																																																																																																																																																																																																																					
80	2811 7619 80	G2½	48	66	25	111	86	0,52																																																																																																																																																																																																																																					
80	2811 7719 80	G3	39	73	32	111	93	0,45																																																																																																																																																																																																																																					
D1	Part Number	G	Th	L1	L2	N1	N2	ib																																																																																																																																																																																																																																					
¾	2811 0019 80	G½	0,98	0,66	1,77	1,41	0,94	0,11																																																																																																																																																																																																																																					
¾	2811 1019 80	G½	0,98	0,66	1,77	1,41	0,94	0,11																																																																																																																																																																																																																																					
1	2811 2019 80	G1	0,98	0,66	1,77	1,61	1,18	0,16																																																																																																																																																																																																																																					
1	2811 2119 80	G¾	0,98	0,66	1,77	1,61	1,18	0,15																																																																																																																																																																																																																																					
1½	2811 4219 80	G1½	1,38	2,28	0,93	2,4	1,57	0,39																																																																																																																																																																																																																																					
2	2811 5419 80	G1½	1,79	3,15	1,38	2,95	2,36	0,73																																																																																																																																																																																																																																					
2	2811 5519 80	G2	1,19	3,15	1,38	2,95	2,36	0,78																																																																																																																																																																																																																																					
2½	2811 6519 80	G2	1,92	2,48	1,10	3,46	2,63	0,81																																																																																																																																																																																																																																					
3	2811 7619 80	G2½	1,88	2,59	0,98	4,37	3,38	1,14																																																																																																																																																																																																																																					
3	2811 7719 80	G3	1,53	2,87	1,25	4,37																																																																																																																																																																																																																																							

<p>20KIT ADAPTER UNION KIT NPT</p>		<table border="1"> <thead> <tr> <th>D1</th> <th>Part Number</th> <th>NPT</th> <th>Th</th> <th>L1</th> <th>L2</th> <th>N1</th> <th>N2</th> <th>Kg.</th> </tr> </thead> <tbody> <tr><td>20</td><td>2811 0020 80</td><td>NPT3/8</td><td>25</td><td>17</td><td>45</td><td>24</td><td>36</td><td>0,06</td></tr> <tr><td>20</td><td>2811 1020 80</td><td>NPT1/2</td><td>25</td><td>17</td><td>45</td><td>24</td><td>36</td><td>0,05</td></tr> <tr><td>25</td><td>2811 2020 80</td><td>NPT1/2</td><td>25</td><td>17</td><td>45</td><td>30</td><td>41</td><td>0,07</td></tr> <tr><td>25</td><td>2811 2120 80</td><td>NPT1/4</td><td>25</td><td>17</td><td>45</td><td>30</td><td>41</td><td>0,06</td></tr> <tr><td>40</td><td>2811 4220 80</td><td>NPT1</td><td>35</td><td>58</td><td>23,5</td><td>61</td><td>30</td><td>0,18</td></tr> <tr><td>50</td><td>2811 5420 80</td><td>NPT1 1/2</td><td>45,5</td><td>80</td><td>35</td><td>75</td><td>60</td><td>0,36</td></tr> <tr><td>50</td><td>2811 5520 80</td><td>NPT2</td><td>30</td><td>80</td><td>35</td><td>75</td><td>65</td><td>0,27</td></tr> <tr><td>63</td><td>2811 6520 80</td><td>NPT1</td><td>49</td><td>63</td><td>28</td><td>88</td><td>67</td><td>0,36</td></tr> <tr><td>80</td><td>2811 7620 80</td><td>NPT1 1/2</td><td>40</td><td>66</td><td>28</td><td>111</td><td>86</td><td>0,62</td></tr> <tr><td>85</td><td>2811 7720 80</td><td>NPT2</td><td>42</td><td>73</td><td>32</td><td>111</td><td>93</td><td>0,47</td></tr> </tbody> </table>	D1	Part Number	NPT	Th	L1	L2	N1	N2	Kg.	20	2811 0020 80	NPT3/8	25	17	45	24	36	0,06	20	2811 1020 80	NPT1/2	25	17	45	24	36	0,05	25	2811 2020 80	NPT1/2	25	17	45	30	41	0,07	25	2811 2120 80	NPT1/4	25	17	45	30	41	0,06	40	2811 4220 80	NPT1	35	58	23,5	61	30	0,18	50	2811 5420 80	NPT1 1/2	45,5	80	35	75	60	0,36	50	2811 5520 80	NPT2	30	80	35	75	65	0,27	63	2811 6520 80	NPT1	49	63	28	88	67	0,36	80	2811 7620 80	NPT1 1/2	40	66	28	111	86	0,62	85	2811 7720 80	NPT2	42	73	32	111	93	0,47	<table border="1"> <thead> <tr> <th>D1</th> <th>Part Number</th> <th>NPT</th> <th>Th</th> <th>L1</th> <th>L2</th> <th>N1</th> <th>N2</th> <th>lb</th> </tr> </thead> <tbody> <tr><td>1/4</td><td>2811 0020 80</td><td>NPT3/8</td><td>0,98</td><td>0,66</td><td>1,77</td><td>0,94</td><td>1,41</td><td>0,13</td></tr> <tr><td>1/2</td><td>2811 1020 80</td><td>NPT1/2</td><td>0,98</td><td>0,66</td><td>1,77</td><td>0,94</td><td>1,41</td><td>0,11</td></tr> <tr><td>1/2</td><td>2811 2020 80</td><td>NPT1/2</td><td>0,98</td><td>0,66</td><td>1,77</td><td>1,18</td><td>1,61</td><td>0,16</td></tr> <tr><td>1/4</td><td>2811 2120 80</td><td>NPT1/4</td><td>0,98</td><td>0,66</td><td>1,77</td><td>1,18</td><td>1,61</td><td>0,13</td></tr> <tr><td>1/2</td><td>2811 4220 80</td><td>NPT1</td><td>1,38</td><td>2,28</td><td>0,93</td><td>2,4</td><td>1,18</td><td>0,39</td></tr> <tr><td>2</td><td>2811 5420 80</td><td>NPT1 1/2</td><td>1,79</td><td>3,15</td><td>1,38</td><td>2,95</td><td>2,78</td><td>0,78</td></tr> <tr><td>2</td><td>2811 5520 80</td><td>NPT2</td><td>1,18</td><td>3,15</td><td>1,38</td><td>2,95</td><td>2,56</td><td>0,59</td></tr> <tr><td>2 1/2</td><td>2811 6520 80</td><td>NPT1</td><td>1,93</td><td>2,48</td><td>1,10</td><td>3,46</td><td>2,63</td><td>0,79</td></tr> <tr><td>3</td><td>2811 7620 80</td><td>NPT1 1/2</td><td>1,57</td><td>2,59</td><td>1</td><td>4,37</td><td>3,38</td><td>1,36</td></tr> <tr><td>3</td><td>2811 7720 80</td><td>NPT2</td><td>1,65</td><td>2,87</td><td>1,25</td><td>4,37</td><td>3,66</td><td>1,03</td></tr> </tbody> </table>	D1	Part Number	NPT	Th	L1	L2	N1	N2	lb	1/4	2811 0020 80	NPT3/8	0,98	0,66	1,77	0,94	1,41	0,13	1/2	2811 1020 80	NPT1/2	0,98	0,66	1,77	0,94	1,41	0,11	1/2	2811 2020 80	NPT1/2	0,98	0,66	1,77	1,18	1,61	0,16	1/4	2811 2120 80	NPT1/4	0,98	0,66	1,77	1,18	1,61	0,13	1/2	2811 4220 80	NPT1	1,38	2,28	0,93	2,4	1,18	0,39	2	2811 5420 80	NPT1 1/2	1,79	3,15	1,38	2,95	2,78	0,78	2	2811 5520 80	NPT2	1,18	3,15	1,38	2,95	2,56	0,59	2 1/2	2811 6520 80	NPT1	1,93	2,48	1,10	3,46	2,63	0,79	3	2811 7620 80	NPT1 1/2	1,57	2,59	1	4,37	3,38	1,36	3	2811 7720 80	NPT2	1,65	2,87	1,25	4,37	3,66	1,03
D1	Part Number	NPT	Th	L1	L2	N1	N2	Kg.																																																																																																																																																																																																	
20	2811 0020 80	NPT3/8	25	17	45	24	36	0,06																																																																																																																																																																																																	
20	2811 1020 80	NPT1/2	25	17	45	24	36	0,05																																																																																																																																																																																																	
25	2811 2020 80	NPT1/2	25	17	45	30	41	0,07																																																																																																																																																																																																	
25	2811 2120 80	NPT1/4	25	17	45	30	41	0,06																																																																																																																																																																																																	
40	2811 4220 80	NPT1	35	58	23,5	61	30	0,18																																																																																																																																																																																																	
50	2811 5420 80	NPT1 1/2	45,5	80	35	75	60	0,36																																																																																																																																																																																																	
50	2811 5520 80	NPT2	30	80	35	75	65	0,27																																																																																																																																																																																																	
63	2811 6520 80	NPT1	49	63	28	88	67	0,36																																																																																																																																																																																																	
80	2811 7620 80	NPT1 1/2	40	66	28	111	86	0,62																																																																																																																																																																																																	
85	2811 7720 80	NPT2	42	73	32	111	93	0,47																																																																																																																																																																																																	
D1	Part Number	NPT	Th	L1	L2	N1	N2	lb																																																																																																																																																																																																	
1/4	2811 0020 80	NPT3/8	0,98	0,66	1,77	0,94	1,41	0,13																																																																																																																																																																																																	
1/2	2811 1020 80	NPT1/2	0,98	0,66	1,77	0,94	1,41	0,11																																																																																																																																																																																																	
1/2	2811 2020 80	NPT1/2	0,98	0,66	1,77	1,18	1,61	0,16																																																																																																																																																																																																	
1/4	2811 2120 80	NPT1/4	0,98	0,66	1,77	1,18	1,61	0,13																																																																																																																																																																																																	
1/2	2811 4220 80	NPT1	1,38	2,28	0,93	2,4	1,18	0,39																																																																																																																																																																																																	
2	2811 5420 80	NPT1 1/2	1,79	3,15	1,38	2,95	2,78	0,78																																																																																																																																																																																																	
2	2811 5520 80	NPT2	1,18	3,15	1,38	2,95	2,56	0,59																																																																																																																																																																																																	
2 1/2	2811 6520 80	NPT1	1,93	2,48	1,10	3,46	2,63	0,79																																																																																																																																																																																																	
3	2811 7620 80	NPT1 1/2	1,57	2,59	1	4,37	3,38	1,36																																																																																																																																																																																																	
3	2811 7720 80	NPT2	1,65	2,87	1,25	4,37	3,66	1,03																																																																																																																																																																																																	
<p>21 REDUCTION SOCKET</p>		<table border="1"> <thead> <tr> <th>D1</th> <th>Part Number</th> <th>D2</th> <th>L</th> <th>W</th> <th>S1</th> <th>S2</th> <th>Kg.</th> </tr> </thead> <tbody> <tr><td>25</td><td>2811 2121 80</td><td>20</td><td>132,8</td><td>43,5</td><td>44</td><td>38,8</td><td>0,08</td></tr> <tr><td>40</td><td>2811 4221 80</td><td>25</td><td>173,8</td><td>67,8</td><td>63</td><td>44</td><td>0,20</td></tr> <tr><td>50</td><td>2811 5421 80</td><td>40</td><td>223,0</td><td>74</td><td>78</td><td>63</td><td>0,47</td></tr> <tr><td>63</td><td>2811 6521 81*</td><td>50</td><td>185</td><td>89</td><td>78</td><td>79</td><td>0,87</td></tr> <tr><td>80</td><td>2810 7621 80*</td><td>63</td><td>191</td><td>113</td><td>78</td><td>97</td><td>1,47</td></tr> <tr><td>100</td><td>2810 8211 00**</td><td>80</td><td>304</td><td>-</td><td>-</td><td>-</td><td>1,34</td></tr> <tr><td>158</td><td>2810 9821 00**</td><td>100</td><td>269</td><td>-</td><td>-</td><td>-</td><td>2,03</td></tr> </tbody> </table> <p>(*) Refer Fig. B for dimensions. (**) Refer Fig. C for dimensions.</p>	D1	Part Number	D2	L	W	S1	S2	Kg.	25	2811 2121 80	20	132,8	43,5	44	38,8	0,08	40	2811 4221 80	25	173,8	67,8	63	44	0,20	50	2811 5421 80	40	223,0	74	78	63	0,47	63	2811 6521 81*	50	185	89	78	79	0,87	80	2810 7621 80*	63	191	113	78	97	1,47	100	2810 8211 00**	80	304	-	-	-	1,34	158	2810 9821 00**	100	269	-	-	-	2,03	<table border="1"> <thead> <tr> <th>D1</th> <th>Part Number</th> <th>D2</th> <th>L</th> <th>W</th> <th>S1</th> <th>S2</th> <th>lb</th> </tr> </thead> <tbody> <tr><td>1</td><td>2811 2121 80</td><td>1/4</td><td>5,22</td><td>1,71</td><td>1,73</td><td>1,52</td><td>0,18</td></tr> <tr><td>1/2</td><td>2811 4221 80</td><td>1</td><td>6,82</td><td>2,66</td><td>2,48</td><td>1,73</td><td>0,45</td></tr> <tr><td>2</td><td>2811 5421 80</td><td>1/2</td><td>8,81</td><td>2,91</td><td>3,07</td><td>2,48</td><td>1,04</td></tr> <tr><td>2 1/2</td><td>2811 6521 81*</td><td>2</td><td>7,28</td><td>3,50</td><td>3,07</td><td>3,11</td><td>1,91</td></tr> <tr><td>3</td><td>2810 7621 80*</td><td>2 1/2</td><td>7,51</td><td>4,44</td><td>3,07</td><td>3,81</td><td>3,23</td></tr> <tr><td>4</td><td>2810 8211 00**</td><td>3</td><td>11,97</td><td>-</td><td>-</td><td>-</td><td>2,90</td></tr> <tr><td>6</td><td>2810 9821 00**</td><td>4</td><td>10,59</td><td>-</td><td>-</td><td>-</td><td>2,03</td></tr> </tbody> </table> <p>(*) Refer Fig. B for dimensions. (**) Refer Fig. C for dimensions.</p>	D1	Part Number	D2	L	W	S1	S2	lb	1	2811 2121 80	1/4	5,22	1,71	1,73	1,52	0,18	1/2	2811 4221 80	1	6,82	2,66	2,48	1,73	0,45	2	2811 5421 80	1/2	8,81	2,91	3,07	2,48	1,04	2 1/2	2811 6521 81*	2	7,28	3,50	3,07	3,11	1,91	3	2810 7621 80*	2 1/2	7,51	4,44	3,07	3,81	3,23	4	2810 8211 00**	3	11,97	-	-	-	2,90	6	2810 9821 00**	4	10,59	-	-	-	2,03																																																																						
D1	Part Number	D2	L	W	S1	S2	Kg.																																																																																																																																																																																																		
25	2811 2121 80	20	132,8	43,5	44	38,8	0,08																																																																																																																																																																																																		
40	2811 4221 80	25	173,8	67,8	63	44	0,20																																																																																																																																																																																																		
50	2811 5421 80	40	223,0	74	78	63	0,47																																																																																																																																																																																																		
63	2811 6521 81*	50	185	89	78	79	0,87																																																																																																																																																																																																		
80	2810 7621 80*	63	191	113	78	97	1,47																																																																																																																																																																																																		
100	2810 8211 00**	80	304	-	-	-	1,34																																																																																																																																																																																																		
158	2810 9821 00**	100	269	-	-	-	2,03																																																																																																																																																																																																		
D1	Part Number	D2	L	W	S1	S2	lb																																																																																																																																																																																																		
1	2811 2121 80	1/4	5,22	1,71	1,73	1,52	0,18																																																																																																																																																																																																		
1/2	2811 4221 80	1	6,82	2,66	2,48	1,73	0,45																																																																																																																																																																																																		
2	2811 5421 80	1/2	8,81	2,91	3,07	2,48	1,04																																																																																																																																																																																																		
2 1/2	2811 6521 81*	2	7,28	3,50	3,07	3,11	1,91																																																																																																																																																																																																		
3	2810 7621 80*	2 1/2	7,51	4,44	3,07	3,81	3,23																																																																																																																																																																																																		
4	2810 8211 00**	3	11,97	-	-	-	2,90																																																																																																																																																																																																		
6	2810 9821 00**	4	10,59	-	-	-	2,03																																																																																																																																																																																																		
<p>22 PIPE CLIPS</p>		<table border="1"> <thead> <tr> <th>D1</th> <th>Part Number</th> <th>L</th> <th>C</th> <th>B</th> <th>Kg.</th> <th>T</th> </tr> </thead> <tbody> <tr><td>20</td><td>2811 1022 20</td><td>37,1</td><td>35</td><td>25</td><td>0,01</td><td>M6</td></tr> <tr><td>25</td><td>2811 2022 20</td><td>59,1</td><td>35</td><td>25</td><td>0,01</td><td>M6</td></tr> <tr><td>40</td><td>2811 4022 20</td><td>88,3</td><td>50</td><td>25</td><td>0,03</td><td>M6</td></tr> <tr><td>50</td><td>2811 5022 20</td><td>94,2</td><td>50</td><td>30</td><td>0,04</td><td>M6</td></tr> <tr><td>63</td><td>2811 6022 20</td><td>120,6</td><td>70</td><td>35</td><td>0,06</td><td>M8</td></tr> <tr><td>80</td><td>2811 7022 20</td><td>135,1</td><td>70</td><td>45</td><td>0,11</td><td>M8</td></tr> <tr><td>100</td><td>2810 8122 10*</td><td>165</td><td>76</td><td>23</td><td>0,18</td><td>M10</td></tr> <tr><td>158</td><td>2810 9022 10*</td><td>222</td><td>102</td><td>23</td><td>0,26</td><td>M10</td></tr> </tbody> </table> <p>(*) Refer Fig. B for dimensions.</p>	D1	Part Number	L	C	B	Kg.	T	20	2811 1022 20	37,1	35	25	0,01	M6	25	2811 2022 20	59,1	35	25	0,01	M6	40	2811 4022 20	88,3	50	25	0,03	M6	50	2811 5022 20	94,2	50	30	0,04	M6	63	2811 6022 20	120,6	70	35	0,06	M8	80	2811 7022 20	135,1	70	45	0,11	M8	100	2810 8122 10*	165	76	23	0,18	M10	158	2810 9022 10*	222	102	23	0,26	M10	<table border="1"> <thead> <tr> <th>D1</th> <th>Part Number</th> <th>L</th> <th>C</th> <th>B</th> <th>lb</th> <th>T</th> </tr> </thead> <tbody> <tr><td>1/4</td><td>2811 1122 20</td><td>2,25</td><td>1,38</td><td>0,98</td><td>0,06</td><td>UNC1/4</td></tr> <tr><td>1</td><td>2811 2122 20</td><td>2,33</td><td>1,38</td><td>0,98</td><td>0,06</td><td>UNC1/2</td></tr> <tr><td>1/2</td><td>2811 4122 20</td><td>3,48</td><td>1,97</td><td>0,98</td><td>1,46</td><td>UNC1/2</td></tr> <tr><td>2</td><td>2811 5122 20</td><td>3,71</td><td>1,97</td><td>1,18</td><td>1,80</td><td>UNC1/2</td></tr> <tr><td>2 1/2</td><td>2811 6122 20</td><td>4,75</td><td>2,75</td><td>1,38</td><td>3,04</td><td>UNC1/2</td></tr> <tr><td>3</td><td>2811 7122 20</td><td>5,32</td><td>2,75</td><td>1,77</td><td>5,11</td><td>UNC1/2</td></tr> <tr><td>4</td><td>2810 8122 10*</td><td>6,49</td><td>2,99</td><td>0,90</td><td>0,18</td><td>UNC1/2</td></tr> <tr><td>6</td><td>2810 9122 10*</td><td>8,74</td><td>4,01</td><td>0,91</td><td>0,58</td><td>UNC1/2</td></tr> </tbody> </table> <p>(*) Refer Fig. B for dimensions.</p>	D1	Part Number	L	C	B	lb	T	1/4	2811 1122 20	2,25	1,38	0,98	0,06	UNC1/4	1	2811 2122 20	2,33	1,38	0,98	0,06	UNC1/2	1/2	2811 4122 20	3,48	1,97	0,98	1,46	UNC1/2	2	2811 5122 20	3,71	1,97	1,18	1,80	UNC1/2	2 1/2	2811 6122 20	4,75	2,75	1,38	3,04	UNC1/2	3	2811 7122 20	5,32	2,75	1,77	5,11	UNC1/2	4	2810 8122 10*	6,49	2,99	0,90	0,18	UNC1/2	6	2810 9122 10*	8,74	4,01	0,91	0,58	UNC1/2																																																																								
D1	Part Number	L	C	B	Kg.	T																																																																																																																																																																																																			
20	2811 1022 20	37,1	35	25	0,01	M6																																																																																																																																																																																																			
25	2811 2022 20	59,1	35	25	0,01	M6																																																																																																																																																																																																			
40	2811 4022 20	88,3	50	25	0,03	M6																																																																																																																																																																																																			
50	2811 5022 20	94,2	50	30	0,04	M6																																																																																																																																																																																																			
63	2811 6022 20	120,6	70	35	0,06	M8																																																																																																																																																																																																			
80	2811 7022 20	135,1	70	45	0,11	M8																																																																																																																																																																																																			
100	2810 8122 10*	165	76	23	0,18	M10																																																																																																																																																																																																			
158	2810 9022 10*	222	102	23	0,26	M10																																																																																																																																																																																																			
D1	Part Number	L	C	B	lb	T																																																																																																																																																																																																			
1/4	2811 1122 20	2,25	1,38	0,98	0,06	UNC1/4																																																																																																																																																																																																			
1	2811 2122 20	2,33	1,38	0,98	0,06	UNC1/2																																																																																																																																																																																																			
1/2	2811 4122 20	3,48	1,97	0,98	1,46	UNC1/2																																																																																																																																																																																																			
2	2811 5122 20	3,71	1,97	1,18	1,80	UNC1/2																																																																																																																																																																																																			
2 1/2	2811 6122 20	4,75	2,75	1,38	3,04	UNC1/2																																																																																																																																																																																																			
3	2811 7122 20	5,32	2,75	1,77	5,11	UNC1/2																																																																																																																																																																																																			
4	2810 8122 10*	6,49	2,99	0,90	0,18	UNC1/2																																																																																																																																																																																																			
6	2810 9122 10*	8,74	4,01	0,91	0,58	UNC1/2																																																																																																																																																																																																			
<p>23 WALLMOUNT NIPPLE ISO228</p>		<table border="1"> <thead> <tr> <th>D1</th> <th>Part Number</th> <th>D2</th> <th>H</th> <th>W</th> <th>Kg.</th> </tr> </thead> <tbody> <tr><td>20</td><td>2811 1023 80</td><td>G1/2</td><td>104,8</td><td>77</td><td>0,40</td></tr> <tr><td>25</td><td>2811 2023 80</td><td>G1/2</td><td>113,5</td><td>77</td><td>0,44</td></tr> </tbody> </table>	D1	Part Number	D2	H	W	Kg.	20	2811 1023 80	G1/2	104,8	77	0,40	25	2811 2023 80	G1/2	113,5	77	0,44	<table border="1"> <thead> <tr> <th>D1</th> <th>Part Number</th> <th>D2</th> <th>H</th> <th>W</th> <th>lb</th> </tr> </thead> <tbody> <tr><td>1/2</td><td>2811 1023 80</td><td>G1/2</td><td>4,12</td><td>3,03</td><td>0,88</td></tr> <tr><td>1</td><td>2811 2023 80</td><td>G1/2</td><td>4,46</td><td>3,03</td><td>0,96</td></tr> </tbody> </table>	D1	Part Number	D2	H	W	lb	1/2	2811 1023 80	G1/2	4,12	3,03	0,88	1	2811 2023 80	G1/2	4,46	3,03	0,96																																																																																																																																																																		
D1	Part Number	D2	H	W	Kg.																																																																																																																																																																																																				
20	2811 1023 80	G1/2	104,8	77	0,40																																																																																																																																																																																																				
25	2811 2023 80	G1/2	113,5	77	0,44																																																																																																																																																																																																				
D1	Part Number	D2	H	W	lb																																																																																																																																																																																																				
1/2	2811 1023 80	G1/2	4,12	3,03	0,88																																																																																																																																																																																																				
1	2811 2023 80	G1/2	4,46	3,03	0,96																																																																																																																																																																																																				
<p>24 WALLMOUNT NIPPLE NPT</p>		<table border="1"> <thead> <tr> <th>D1</th> <th>Part Number</th> <th>D2</th> <th>H</th> <th>W</th> <th>Kg.</th> </tr> </thead> <tbody> <tr><td>20</td><td>2811 1024 80</td><td>NPT1/2</td><td>104,8</td><td>77</td><td>0,40</td></tr> <tr><td>25</td><td>2811 2024 80</td><td>NPT1/2</td><td>113,5</td><td>77</td><td>0,44</td></tr> </tbody> </table>	D1	Part Number	D2	H	W	Kg.	20	2811 1024 80	NPT1/2	104,8	77	0,40	25	2811 2024 80	NPT1/2	113,5	77	0,44	<table border="1"> <thead> <tr> <th>D1</th> <th>Part Number</th> <th>D2</th> <th>H</th> <th>W</th> <th>lb</th> </tr> </thead> <tbody> <tr><td>1/2</td><td>2811 1024 80</td><td>NPT1/2</td><td>4,12</td><td>3,03</td><td>0,88</td></tr> <tr><td>1</td><td>2811 2024 80</td><td>NPT1/2</td><td>4,46</td><td>3,03</td><td>0,96</td></tr> </tbody> </table>	D1	Part Number	D2	H	W	lb	1/2	2811 1024 80	NPT1/2	4,12	3,03	0,88	1	2811 2024 80	NPT1/2	4,46	3,03	0,96																																																																																																																																																																		
D1	Part Number	D2	H	W	Kg.																																																																																																																																																																																																				
20	2811 1024 80	NPT1/2	104,8	77	0,40																																																																																																																																																																																																				
25	2811 2024 80	NPT1/2	113,5	77	0,44																																																																																																																																																																																																				
D1	Part Number	D2	H	W	lb																																																																																																																																																																																																				
1/2	2811 1024 80	NPT1/2	4,12	3,03	0,88																																																																																																																																																																																																				
1	2811 2024 80	NPT1/2	4,46	3,03	0,96																																																																																																																																																																																																				
<p>25 WALLMOUNT NIPPLE THREADED</p>		<table border="1"> <thead> <tr> <th>D1</th> <th>Part Number</th> <th>D2</th> <th>Th</th> <th>W</th> <th>H</th> <th>Kg.</th> </tr> </thead> <tbody> <tr><td>ISO 7-R 1/2</td><td>2811 0025 00</td><td>G1/2</td><td>16,7</td><td>-</td><td>77,5</td><td>0,35</td></tr> <tr><td>ISO 7-R 1/4</td><td>2811 1025 00</td><td>G1/2</td><td>16,4</td><td>-</td><td>77,5</td><td>0,35</td></tr> </tbody> </table>	D1	Part Number	D2	Th	W	H	Kg.	ISO 7-R 1/2	2811 0025 00	G1/2	16,7	-	77,5	0,35	ISO 7-R 1/4	2811 1025 00	G1/2	16,4	-	77,5	0,35	<table border="1"> <thead> <tr> <th>D1</th> <th>Part Number</th> <th>D2</th> <th>Th</th> <th>W</th> <th>H</th> <th>lb</th> </tr> </thead> <tbody> <tr><td>ISO 7-R 1/2</td><td>2811 0025 00</td><td>G1/2</td><td>0,65</td><td>-</td><td>3,05</td><td>0,78</td></tr> <tr><td>ISO 7-R 1/4</td><td>2811 1025 00</td><td>G1/2</td><td>0,64</td><td>-</td><td>3,05</td><td>0,78</td></tr> </tbody> </table>	D1	Part Number	D2	Th	W	H	lb	ISO 7-R 1/2	2811 0025 00	G1/2	0,65	-	3,05	0,78	ISO 7-R 1/4	2811 1025 00	G1/2	0,64	-	3,05	0,78																																																																																																																																																												
D1	Part Number	D2	Th	W	H	Kg.																																																																																																																																																																																																			
ISO 7-R 1/2	2811 0025 00	G1/2	16,7	-	77,5	0,35																																																																																																																																																																																																			
ISO 7-R 1/4	2811 1025 00	G1/2	16,4	-	77,5	0,35																																																																																																																																																																																																			
D1	Part Number	D2	Th	W	H	lb																																																																																																																																																																																																			
ISO 7-R 1/2	2811 0025 00	G1/2	0,65	-	3,05	0,78																																																																																																																																																																																																			
ISO 7-R 1/4	2811 1025 00	G1/2	0,64	-	3,05	0,78																																																																																																																																																																																																			
<p>26 WALLMOUNT NIPPLE THREADED NPT</p>		<table border="1"> <thead> <tr> <th>D1</th> <th>Part Number</th> <th>D2</th> <th>Th</th> <th>W</th> <th>H</th> <th>Kg.</th> </tr> </thead> <tbody> <tr><td>NPT1/2</td><td>2811 0026 00</td><td>NPT1/2</td><td>20</td><td>-</td><td>81,5</td><td>0,37</td></tr> <tr><td>NPT1/4</td><td>2811 0026 00</td><td>NPT1/2</td><td>20,2</td><td>-</td><td>81,5</td><td>0,36</td></tr> </tbody> </table>	D1	Part Number	D2	Th	W	H	Kg.	NPT1/2	2811 0026 00	NPT1/2	20	-	81,5	0,37	NPT1/4	2811 0026 00	NPT1/2	20,2	-	81,5	0,36	<table border="1"> <thead> <tr> <th>D1</th> <th>Part Number</th> <th>D2</th> <th>Th</th> <th>W</th> <th>H</th> <th>lb</th> </tr> </thead> <tbody> <tr><td>NPT1/2</td><td>2811 0026 00</td><td>NPT1/2</td><td>0,78</td><td>-</td><td>3,20</td><td>0,81</td></tr> <tr><td>NPT1/4</td><td>2811 0026 00</td><td>NPT1/2</td><td>0,79</td><td>-</td><td>3,20</td><td>0,8</td></tr> </tbody> </table>	D1	Part Number	D2	Th	W	H	lb	NPT1/2	2811 0026 00	NPT1/2	0,78	-	3,20	0,81	NPT1/4	2811 0026 00	NPT1/2	0,79	-	3,20	0,8																																																																																																																																																												
D1	Part Number	D2	Th	W	H	Kg.																																																																																																																																																																																																			
NPT1/2	2811 0026 00	NPT1/2	20	-	81,5	0,37																																																																																																																																																																																																			
NPT1/4	2811 0026 00	NPT1/2	20,2	-	81,5	0,36																																																																																																																																																																																																			
D1	Part Number	D2	Th	W	H	lb																																																																																																																																																																																																			
NPT1/2	2811 0026 00	NPT1/2	0,78	-	3,20	0,81																																																																																																																																																																																																			
NPT1/4	2811 0026 00	NPT1/2	0,79	-	3,20	0,8																																																																																																																																																																																																			

<p>27</p> <p>PIPE CLIP SPACER</p>		<table border="1"> <thead> <tr> <th>D1</th> <th>Part Number</th> <th>L</th> <th>B</th> <th>H</th> <th>Kg.</th> </tr> </thead> <tbody> <tr> <td>20-25</td> <td>2811 0027 10</td> <td>21</td> <td>34,8</td> <td>15</td> <td>0,01</td> </tr> <tr> <td>40-50-63</td> <td>2811 0327 10</td> <td>27</td> <td>61,4</td> <td>20</td> <td>0,02</td> </tr> <tr> <td>80</td> <td>2811 0227 10</td> <td>30</td> <td>61,4</td> <td>37</td> <td>0,03</td> </tr> <tr> <td>80</td> <td>2810 0227 10*</td> <td>94</td> <td>40</td> <td>25</td> <td>0,26</td> </tr> <tr> <td>100</td> <td>2810 0327 10*</td> <td>40</td> <td>40</td> <td>49,5</td> <td>0,13</td> </tr> </tbody> </table> <p>(*)Refer Fig. B for dimensions.</p>	D1	Part Number	L	B	H	Kg.	20-25	2811 0027 10	21	34,8	15	0,01	40-50-63	2811 0327 10	27	61,4	20	0,02	80	2811 0227 10	30	61,4	37	0,03	80	2810 0227 10*	94	40	25	0,26	100	2810 0327 10*	40	40	49,5	0,13	<table border="1"> <thead> <tr> <th>D1</th> <th>Part Number</th> <th>L</th> <th>B</th> <th>H</th> <th>lb</th> </tr> </thead> <tbody> <tr> <td>¼ - 1</td> <td>2811 0027 10</td> <td>0,83</td> <td>1,37</td> <td>0,59</td> <td>0,02</td> </tr> <tr> <td>1½ - 2 - 2½</td> <td>2811 0327 10</td> <td>1,06</td> <td>2,41</td> <td>0,79</td> <td>0,04</td> </tr> <tr> <td>3</td> <td>2811 0227 10</td> <td>1,18</td> <td>2,42</td> <td>1,46</td> <td>0,06</td> </tr> <tr> <td>3</td> <td>2810 0227 10*</td> <td>3,7</td> <td>1,57</td> <td>1,95</td> <td>4,90</td> </tr> <tr> <td>4</td> <td>2810 0327 10*</td> <td>1,57</td> <td>1,57</td> <td>1,95</td> <td>4,90</td> </tr> </tbody> </table> <p>(*)Refer Fig. B for dimensions.</p>	D1	Part Number	L	B	H	lb	¼ - 1	2811 0027 10	0,83	1,37	0,59	0,02	1½ - 2 - 2½	2811 0327 10	1,06	2,41	0,79	0,04	3	2811 0227 10	1,18	2,42	1,46	0,06	3	2810 0227 10*	3,7	1,57	1,95	4,90	4	2810 0327 10*	1,57	1,57	1,95	4,90
D1	Part Number	L	B	H	Kg.																																																																						
20-25	2811 0027 10	21	34,8	15	0,01																																																																						
40-50-63	2811 0327 10	27	61,4	20	0,02																																																																						
80	2811 0227 10	30	61,4	37	0,03																																																																						
80	2810 0227 10*	94	40	25	0,26																																																																						
100	2810 0327 10*	40	40	49,5	0,13																																																																						
D1	Part Number	L	B	H	lb																																																																						
¼ - 1	2811 0027 10	0,83	1,37	0,59	0,02																																																																						
1½ - 2 - 2½	2811 0327 10	1,06	2,41	0,79	0,04																																																																						
3	2811 0227 10	1,18	2,42	1,46	0,06																																																																						
3	2810 0227 10*	3,7	1,57	1,95	4,90																																																																						
4	2810 0327 10*	1,57	1,57	1,95	4,90																																																																						
<p>30</p> <p>PROFILE CHANNEL</p>		<table border="1"> <thead> <tr> <th>Part Number</th> <th>L</th> <th>W</th> <th>H</th> <th>Thickness</th> <th>Kg.</th> </tr> </thead> <tbody> <tr> <td>2810 0030 05</td> <td>2000</td> <td>30</td> <td>27</td> <td>1,5</td> <td>0,27</td> </tr> </tbody> </table>	Part Number	L	W	H	Thickness	Kg.	2810 0030 05	2000	30	27	1,5	0,27	<table border="1"> <thead> <tr> <th>Part Number</th> <th>L</th> <th>W</th> <th>H</th> <th>Thickness</th> <th>lb</th> </tr> </thead> <tbody> <tr> <td>2810 0030 05</td> <td>78,74</td> <td>1,18</td> <td>1,06</td> <td>0,06</td> <td>0,58</td> </tr> </tbody> </table>	Part Number	L	W	H	Thickness	lb	2810 0030 05	78,74	1,18	1,06	0,06	0,58																																																
Part Number	L	W	H	Thickness	Kg.																																																																						
2810 0030 05	2000	30	27	1,5	0,27																																																																						
Part Number	L	W	H	Thickness	lb																																																																						
2810 0030 05	78,74	1,18	1,06	0,06	0,58																																																																						
<p>31</p> <p>WALL BRACKET</p>		<table border="1"> <thead> <tr> <th>Part Number</th> <th>L</th> <th>L1</th> <th>W</th> <th>W1</th> <th>H</th> <th>H1</th> <th>Thickness</th> <th>Kg.</th> </tr> </thead> <tbody> <tr> <td>2810 0031 05</td> <td>36</td> <td>50</td> <td>71</td> <td>5</td> <td>20</td> <td>114</td> <td>5</td> <td>0,07</td> </tr> </tbody> </table>	Part Number	L	L1	W	W1	H	H1	Thickness	Kg.	2810 0031 05	36	50	71	5	20	114	5	0,07	<table border="1"> <thead> <tr> <th>Part Number</th> <th>L</th> <th>L1</th> <th>W</th> <th>W1</th> <th>H</th> <th>H1</th> <th>Thickness</th> <th>lb</th> </tr> </thead> <tbody> <tr> <td>2810 0031 05</td> <td>1,42</td> <td>1,97</td> <td>2,8</td> <td>0,2</td> <td>0,79</td> <td>4,49</td> <td>0,2</td> <td>0,16</td> </tr> </tbody> </table>	Part Number	L	L1	W	W1	H	H1	Thickness	lb	2810 0031 05	1,42	1,97	2,8	0,2	0,79	4,49	0,2	0,16																																				
Part Number	L	L1	W	W1	H	H1	Thickness	Kg.																																																																			
2810 0031 05	36	50	71	5	20	114	5	0,07																																																																			
Part Number	L	L1	W	W1	H	H1	Thickness	lb																																																																			
2810 0031 05	1,42	1,97	2,8	0,2	0,79	4,49	0,2	0,16																																																																			
<p>32</p> <p>CANTILEVER ARM</p>		<table border="1"> <thead> <tr> <th>Part Number</th> <th>L</th> <th>L1</th> <th>W</th> <th>W1</th> <th>H</th> <th>H1</th> <th>Thickness</th> <th>Kg.</th> </tr> </thead> <tbody> <tr> <td>2810 0032 05</td> <td>27</td> <td>40</td> <td>30</td> <td>120</td> <td>300</td> <td>6</td> <td>1,5</td> <td>0,07</td> </tr> <tr> <td>2810 0132 00</td> <td>27</td> <td>40</td> <td>30</td> <td>120</td> <td>534</td> <td>6</td> <td>1,5</td> <td>0,10</td> </tr> </tbody> </table>	Part Number	L	L1	W	W1	H	H1	Thickness	Kg.	2810 0032 05	27	40	30	120	300	6	1,5	0,07	2810 0132 00	27	40	30	120	534	6	1,5	0,10	<table border="1"> <thead> <tr> <th>Part Number</th> <th>L</th> <th>L1</th> <th>W</th> <th>W1</th> <th>H</th> <th>H1</th> <th>Thickness</th> <th>lb</th> </tr> </thead> <tbody> <tr> <td>2810 0032 05</td> <td>1,06</td> <td>1,57</td> <td>1,18</td> <td>4,72</td> <td>11,81</td> <td>0,25</td> <td>0,06</td> <td>0,15</td> </tr> <tr> <td>2810 0132 00</td> <td>1,06</td> <td>1,57</td> <td>1,18</td> <td>4,72</td> <td>21</td> <td>0,25</td> <td>0,06</td> <td>0,22</td> </tr> </tbody> </table>	Part Number	L	L1	W	W1	H	H1	Thickness	lb	2810 0032 05	1,06	1,57	1,18	4,72	11,81	0,25	0,06	0,15	2810 0132 00	1,06	1,57	1,18	4,72	21	0,25	0,06	0,22																		
Part Number	L	L1	W	W1	H	H1	Thickness	Kg.																																																																			
2810 0032 05	27	40	30	120	300	6	1,5	0,07																																																																			
2810 0132 00	27	40	30	120	534	6	1,5	0,10																																																																			
Part Number	L	L1	W	W1	H	H1	Thickness	lb																																																																			
2810 0032 05	1,06	1,57	1,18	4,72	11,81	0,25	0,06	0,15																																																																			
2810 0132 00	1,06	1,57	1,18	4,72	21	0,25	0,06	0,22																																																																			
<p>33</p> <p>T-BOLTS</p>		<table border="1"> <thead> <tr> <th>Part Number</th> <th>D</th> <th>L</th> <th>T</th> <th>W1</th> <th>W2</th> <th>Kg.</th> </tr> </thead> <tbody> <tr> <td>2810 0033 00</td> <td>M8</td> <td>30</td> <td>4</td> <td>25</td> <td>14</td> <td>0,02</td> </tr> <tr> <td>2810 0133 00</td> <td>M8</td> <td>40</td> <td>4</td> <td>25</td> <td>14</td> <td>0,22</td> </tr> <tr> <td>2810 0233 00</td> <td>M8</td> <td>60</td> <td>4</td> <td>25</td> <td>14</td> <td>0,03</td> </tr> <tr> <td>2810 0333 00</td> <td>M8</td> <td>80</td> <td>4</td> <td>25</td> <td>14</td> <td>0,04</td> </tr> <tr> <td>2810 1033 00*</td> <td>M6</td> <td>-</td> <td>4</td> <td>25</td> <td>14</td> <td>0,03</td> </tr> </tbody> </table> <p>Refer Fig. B for dimensions.</p>	Part Number	D	L	T	W1	W2	Kg.	2810 0033 00	M8	30	4	25	14	0,02	2810 0133 00	M8	40	4	25	14	0,22	2810 0233 00	M8	60	4	25	14	0,03	2810 0333 00	M8	80	4	25	14	0,04	2810 1033 00*	M6	-	4	25	14	0,03	<p>Only for metric</p>																														
Part Number	D	L	T	W1	W2	Kg.																																																																					
2810 0033 00	M8	30	4	25	14	0,02																																																																					
2810 0133 00	M8	40	4	25	14	0,22																																																																					
2810 0233 00	M8	60	4	25	14	0,03																																																																					
2810 0333 00	M8	80	4	25	14	0,04																																																																					
2810 1033 00*	M6	-	4	25	14	0,03																																																																					
<p>34</p> <p>PROTECTION CAP</p>		<table border="1"> <thead> <tr> <th>Part Number</th> <th>D</th> <th>L</th> <th>T</th> <th>W1</th> <th>Kg.</th> </tr> </thead> <tbody> <tr> <td>2810 0034 10</td> <td>29</td> <td>18,5</td> <td>5</td> <td>30</td> <td>0,01</td> </tr> </tbody> </table>	Part Number	D	L	T	W1	Kg.	2810 0034 10	29	18,5	5	30	0,01	<p>Only for metric</p>																																																												
Part Number	D	L	T	W1	Kg.																																																																						
2810 0034 10	29	18,5	5	30	0,01																																																																						
<p>35</p> <p>BEAM CLAMP</p>		<table border="1"> <thead> <tr> <th>Part Number</th> <th>D</th> <th>Beam thickness</th> <th>Kg.</th> </tr> </thead> <tbody> <tr> <td>2810 0035 10</td> <td>M8</td> <td>2-3</td> <td>0,03</td> </tr> <tr> <td>2810 0135 10</td> <td>M8</td> <td>3-4</td> <td>0,03</td> </tr> <tr> <td>2810 0235 10</td> <td>M8</td> <td>8-14</td> <td>0,03</td> </tr> <tr> <td>2810 0335 10</td> <td>M8</td> <td>14-20</td> <td>0,03</td> </tr> <tr> <td>2810 1035 10</td> <td>M6</td> <td>2-3</td> <td>0,03</td> </tr> <tr> <td>2810 1135 10</td> <td>M6</td> <td>3-8</td> <td>0,03</td> </tr> <tr> <td>2810 1235 10</td> <td>M6</td> <td>8-14</td> <td>0,03</td> </tr> <tr> <td>2810 1335 10</td> <td>M6</td> <td>14-20</td> <td>0,03</td> </tr> </tbody> </table>	Part Number	D	Beam thickness	Kg.	2810 0035 10	M8	2-3	0,03	2810 0135 10	M8	3-4	0,03	2810 0235 10	M8	8-14	0,03	2810 0335 10	M8	14-20	0,03	2810 1035 10	M6	2-3	0,03	2810 1135 10	M6	3-8	0,03	2810 1235 10	M6	8-14	0,03	2810 1335 10	M6	14-20	0,03	<p>Only for metric</p>																																				
Part Number	D	Beam thickness	Kg.																																																																								
2810 0035 10	M8	2-3	0,03																																																																								
2810 0135 10	M8	3-4	0,03																																																																								
2810 0235 10	M8	8-14	0,03																																																																								
2810 0335 10	M8	14-20	0,03																																																																								
2810 1035 10	M6	2-3	0,03																																																																								
2810 1135 10	M6	3-8	0,03																																																																								
2810 1235 10	M6	8-14	0,03																																																																								
2810 1335 10	M6	14-20	0,03																																																																								
<p>36</p> <p>SCREW BEAM CLAMP</p>		<table border="1"> <thead> <tr> <th>Part Number</th> <th>D</th> <th>Kg.</th> </tr> </thead> <tbody> <tr> <td>2810 0036 10</td> <td>M8</td> <td>0,11</td> </tr> <tr> <td>2810 0136 10</td> <td>M6</td> <td>0,15</td> </tr> </tbody> </table>	Part Number	D	Kg.	2810 0036 10	M8	0,11	2810 0136 10	M6	0,15	<p>Only for metric</p>																																																															
Part Number	D	Kg.																																																																									
2810 0036 10	M8	0,11																																																																									
2810 0136 10	M6	0,15																																																																									
<p>37</p> <p>U-BOLT CLAMP</p>		<table border="1"> <thead> <tr> <th>Part Number</th> <th>H</th> <th>H1</th> <th>W</th> <th>W1</th> <th>T</th> <th>Kg.</th> </tr> </thead> <tbody> <tr> <td>2810 0037 10</td> <td>76</td> <td>20</td> <td>60</td> <td>41</td> <td>4</td> <td>0,17</td> </tr> </tbody> </table>	Part Number	H	H1	W	W1	T	Kg.	2810 0037 10	76	20	60	41	4	0,17	<p>Only for metric</p>																																																										
Part Number	H	H1	W	W1	T	Kg.																																																																					
2810 0037 10	76	20	60	41	4	0,17																																																																					

<p>38</p> <p>HANG CLAMP</p>		<table border="1"> <thead> <tr> <th>Part Number</th> <th>D</th> <th>Beam Thickness</th> <th>Kg.</th> </tr> </thead> <tbody> <tr> <td>2810 0018 10</td> <td>M8</td> <td>1.5-4</td> <td>0,02</td> </tr> <tr> <td>2810 0018 10</td> <td>M8</td> <td>4-6,5</td> <td>0,02</td> </tr> <tr> <td>2810 1018 10</td> <td>M6</td> <td>1.5-4</td> <td>0,02</td> </tr> <tr> <td>2810 1118 10</td> <td>M6</td> <td>4-6,5</td> <td>0,02</td> </tr> </tbody> </table>	Part Number	D	Beam Thickness	Kg.	2810 0018 10	M8	1.5-4	0,02	2810 0018 10	M8	4-6,5	0,02	2810 1018 10	M6	1.5-4	0,02	2810 1118 10	M6	4-6,5	0,02	<p>Only for metric</p>																																																																																																																												
Part Number	D	Beam Thickness	Kg.																																																																																																																																																
2810 0018 10	M8	1.5-4	0,02																																																																																																																																																
2810 0018 10	M8	4-6,5	0,02																																																																																																																																																
2810 1018 10	M6	1.5-4	0,02																																																																																																																																																
2810 1118 10	M6	4-6,5	0,02																																																																																																																																																
<p>39</p> <p>ROOF CLAMP</p>		<table border="1"> <thead> <tr> <th>Part Number</th> <th>D</th> <th>Thickness</th> <th>Kg.</th> </tr> </thead> <tbody> <tr> <td>2810 0039 10</td> <td>M8</td> <td>0,8-3</td> <td>0,02</td> </tr> <tr> <td>2810 1039 10</td> <td>M6</td> <td>0,8-3</td> <td>0,02</td> </tr> </tbody> </table>	Part Number	D	Thickness	Kg.	2810 0039 10	M8	0,8-3	0,02	2810 1039 10	M6	0,8-3	0,02	<p>Only for metric</p>																																																																																																																																				
Part Number	D	Thickness	Kg.																																																																																																																																																
2810 0039 10	M8	0,8-3	0,02																																																																																																																																																
2810 1039 10	M6	0,8-3	0,02																																																																																																																																																
<p>50</p> <p>CANALIS HANGER</p>		<table border="1"> <thead> <tr> <th>Part Number</th> <th>D</th> <th>L</th> <th>L1</th> <th>H</th> <th>W</th> <th>Thickness</th> <th>Kg.</th> </tr> </thead> <tbody> <tr> <td>2810 0250 05</td> <td>M6</td> <td>61</td> <td>47</td> <td>192</td> <td>30</td> <td>2</td> <td>0,169</td> </tr> </tbody> </table>	Part Number	D	L	L1	H	W	Thickness	Kg.	2810 0250 05	M6	61	47	192	30	2	0,169	<p>Only for metric</p>																																																																																																																																
Part Number	D	L	L1	H	W	Thickness	Kg.																																																																																																																																												
2810 0250 05	M6	61	47	192	30	2	0,169																																																																																																																																												
<p>51</p> <p>VALVES</p>		<table border="1"> <thead> <tr> <th>D1</th> <th>Part Number</th> <th>L</th> <th>L1</th> <th>H</th> <th>B</th> <th>C</th> <th>Kg.</th> </tr> </thead> <tbody> <tr> <td>20</td> <td>2811 1051 81</td> <td>131</td> <td>120</td> <td>73</td> <td>53</td> <td>35*</td> <td>0,55</td> </tr> <tr> <td>25</td> <td>2811 2051 81</td> <td>150</td> <td>120</td> <td>83</td> <td>62</td> <td>35*</td> <td>0,79</td> </tr> <tr> <td>40</td> <td>2811 4051 81</td> <td>236</td> <td>158</td> <td>156</td> <td>75</td> <td>70,3</td> <td>3,09</td> </tr> <tr> <td>50</td> <td>2811 5051 81</td> <td>236</td> <td>158</td> <td>156</td> <td>77</td> <td>70,3</td> <td>3,09</td> </tr> <tr> <td>63</td> <td>2811 6051 80**</td> <td>216</td> <td>212</td> <td>325,5</td> <td>59</td> <td>92,5</td> <td>8,71</td> </tr> <tr> <td>80</td> <td>2811 7051 80**</td> <td>247</td> <td>212</td> <td>339</td> <td>54</td> <td>100</td> <td>8,39</td> </tr> <tr> <td>100</td> <td>1606 4551 00***</td> <td>323</td> <td>-</td> <td>389</td> <td>-</td> <td>-</td> <td>7,90</td> </tr> <tr> <td>150</td> <td>2810 9051 80***</td> <td>62</td> <td>-</td> <td>451</td> <td>-</td> <td>-</td> <td>6,40</td> </tr> </tbody> </table> <p>(*)Center-to-wall distance with valve Spacers always included. (**)Refer Fig. B for dimensions. (***)Refer Fig. C for dimensions.</p>	D1	Part Number	L	L1	H	B	C	Kg.	20	2811 1051 81	131	120	73	53	35*	0,55	25	2811 2051 81	150	120	83	62	35*	0,79	40	2811 4051 81	236	158	156	75	70,3	3,09	50	2811 5051 81	236	158	156	77	70,3	3,09	63	2811 6051 80**	216	212	325,5	59	92,5	8,71	80	2811 7051 80**	247	212	339	54	100	8,39	100	1606 4551 00***	323	-	389	-	-	7,90	150	2810 9051 80***	62	-	451	-	-	6,40	<table border="1"> <thead> <tr> <th>D1</th> <th>Part Number</th> <th>L</th> <th>L1</th> <th>H</th> <th>B</th> <th>C</th> <th>B</th> </tr> </thead> <tbody> <tr> <td>3/4</td> <td>2811 1051 81</td> <td>5,15</td> <td>4,72</td> <td>2,87</td> <td>2,08</td> <td>1,37*</td> <td>1,739</td> </tr> <tr> <td>1</td> <td>2811 2051 81</td> <td>5,09</td> <td>4,72</td> <td>3,26</td> <td>2,43</td> <td>1,37*</td> <td>1,21</td> </tr> <tr> <td>1 1/2</td> <td>2811 4051 81</td> <td>9,29</td> <td>6,22</td> <td>6,14</td> <td>2,95</td> <td>2,76</td> <td>6,81</td> </tr> <tr> <td>2</td> <td>2811 5051 81</td> <td>9,29</td> <td>6,22</td> <td>6,14</td> <td>3,03</td> <td>2,76</td> <td>6,81</td> </tr> <tr> <td>2 1/2</td> <td>2811 6051 80**</td> <td>8,50</td> <td>8,34</td> <td>12,81</td> <td>2,32</td> <td>3,64</td> <td>19,16</td> </tr> <tr> <td>3</td> <td>2811 7051 80**</td> <td>9,72</td> <td>8,34</td> <td>13,34</td> <td>2,12</td> <td>3,93</td> <td>18,45</td> </tr> <tr> <td>4</td> <td>1606 4551 00***</td> <td>2,06</td> <td>-</td> <td>19,56</td> <td>-</td> <td>-</td> <td>17,89</td> </tr> <tr> <td>6</td> <td>2810 9051 80***</td> <td>2,44</td> <td>-</td> <td>17,75</td> <td>-</td> <td>-</td> <td>18,51</td> </tr> </tbody> </table> <p>(*)Center-to-wall distance with valve Spacers always included. (**)Refer Fig. B for dimensions. (***)Refer Fig. C for dimensions.</p>	D1	Part Number	L	L1	H	B	C	B	3/4	2811 1051 81	5,15	4,72	2,87	2,08	1,37*	1,739	1	2811 2051 81	5,09	4,72	3,26	2,43	1,37*	1,21	1 1/2	2811 4051 81	9,29	6,22	6,14	2,95	2,76	6,81	2	2811 5051 81	9,29	6,22	6,14	3,03	2,76	6,81	2 1/2	2811 6051 80**	8,50	8,34	12,81	2,32	3,64	19,16	3	2811 7051 80**	9,72	8,34	13,34	2,12	3,93	18,45	4	1606 4551 00***	2,06	-	19,56	-	-	17,89	6	2810 9051 80***	2,44	-	17,75	-	-	18,51
D1	Part Number	L	L1	H	B	C	Kg.																																																																																																																																												
20	2811 1051 81	131	120	73	53	35*	0,55																																																																																																																																												
25	2811 2051 81	150	120	83	62	35*	0,79																																																																																																																																												
40	2811 4051 81	236	158	156	75	70,3	3,09																																																																																																																																												
50	2811 5051 81	236	158	156	77	70,3	3,09																																																																																																																																												
63	2811 6051 80**	216	212	325,5	59	92,5	8,71																																																																																																																																												
80	2811 7051 80**	247	212	339	54	100	8,39																																																																																																																																												
100	1606 4551 00***	323	-	389	-	-	7,90																																																																																																																																												
150	2810 9051 80***	62	-	451	-	-	6,40																																																																																																																																												
D1	Part Number	L	L1	H	B	C	B																																																																																																																																												
3/4	2811 1051 81	5,15	4,72	2,87	2,08	1,37*	1,739																																																																																																																																												
1	2811 2051 81	5,09	4,72	3,26	2,43	1,37*	1,21																																																																																																																																												
1 1/2	2811 4051 81	9,29	6,22	6,14	2,95	2,76	6,81																																																																																																																																												
2	2811 5051 81	9,29	6,22	6,14	3,03	2,76	6,81																																																																																																																																												
2 1/2	2811 6051 80**	8,50	8,34	12,81	2,32	3,64	19,16																																																																																																																																												
3	2811 7051 80**	9,72	8,34	13,34	2,12	3,93	18,45																																																																																																																																												
4	1606 4551 00***	2,06	-	19,56	-	-	17,89																																																																																																																																												
6	2810 9051 80***	2,44	-	17,75	-	-	18,51																																																																																																																																												
<p>52</p> <p>VALVES THREADED ISO 228</p>		<table border="1"> <thead> <tr> <th>D1</th> <th>Part Number</th> <th>G</th> <th>L</th> <th>L1</th> <th>H</th> <th>Th</th> <th>C</th> <th>Kg.</th> </tr> </thead> <tbody> <tr> <td>20</td> <td>2811 1152 81</td> <td>G 3/4</td> <td>92,8</td> <td>120</td> <td>86,7</td> <td>15</td> <td>35*</td> <td>0,52</td> </tr> <tr> <td>25</td> <td>2811 2252 81</td> <td>G 1</td> <td>111,9</td> <td>120</td> <td>88,7</td> <td>18,5</td> <td>35*</td> <td>0,76</td> </tr> <tr> <td>40</td> <td>2811 4452 81</td> <td>G 1 1/2</td> <td>204</td> <td>158</td> <td>148,5</td> <td>-</td> <td>70,3</td> <td>1,96</td> </tr> <tr> <td>50</td> <td>2811 5552 81</td> <td>G 2</td> <td>176,2</td> <td>158</td> <td>156</td> <td>26</td> <td>70,3</td> <td>2,70</td> </tr> <tr> <td>63</td> <td>2811 6652 80**</td> <td>G 2 1/2</td> <td>170</td> <td>212</td> <td>325</td> <td>20</td> <td>92,5</td> <td>11,29</td> </tr> <tr> <td>80</td> <td>2811 7752 80**</td> <td>G 3</td> <td>188</td> <td>212</td> <td>339</td> <td>34</td> <td>100</td> <td>10,39</td> </tr> </tbody> </table> <p>(*)Center-to-wall distance with valve Spacers always included. (**)Refer Fig. B for dimensions.</p>	D1	Part Number	G	L	L1	H	Th	C	Kg.	20	2811 1152 81	G 3/4	92,8	120	86,7	15	35*	0,52	25	2811 2252 81	G 1	111,9	120	88,7	18,5	35*	0,76	40	2811 4452 81	G 1 1/2	204	158	148,5	-	70,3	1,96	50	2811 5552 81	G 2	176,2	158	156	26	70,3	2,70	63	2811 6652 80**	G 2 1/2	170	212	325	20	92,5	11,29	80	2811 7752 80**	G 3	188	212	339	34	100	10,39	<table border="1"> <thead> <tr> <th>D1</th> <th>Part Number</th> <th>G</th> <th>L</th> <th>L1</th> <th>H</th> <th>Th</th> <th>C</th> <th>B</th> </tr> </thead> <tbody> <tr> <td>3/4</td> <td>2811 1152 81</td> <td>G 3/4</td> <td>3,65</td> <td>4,72</td> <td>3,33</td> <td>0,59</td> <td>1,37*</td> <td>1,58</td> </tr> <tr> <td>1</td> <td>2811 2252 81</td> <td>G 1</td> <td>4,40</td> <td>4,72</td> <td>3,49</td> <td>0,72</td> <td>1,37*</td> <td>2,33</td> </tr> <tr> <td>1 1/2</td> <td>2811 4452 81</td> <td>G 1 1/2</td> <td>8,03</td> <td>6,22</td> <td>5,85</td> <td>-</td> <td>2,77</td> <td>4,32</td> </tr> <tr> <td>2</td> <td>2811 5552 81</td> <td>G 2</td> <td>6,94</td> <td>6,22</td> <td>6,14</td> <td>1,02</td> <td>2,77</td> <td>6,15</td> </tr> <tr> <td>2 1/2</td> <td>2811 6652 80**</td> <td>G 2 1/2</td> <td>6,69</td> <td>8,34</td> <td>12,79</td> <td>1,18</td> <td>3,64</td> <td>24,87</td> </tr> <tr> <td>3</td> <td>2811 7752 80**</td> <td>G 3</td> <td>7,40</td> <td>8,34</td> <td>13,34</td> <td>1,33</td> <td>3,93</td> <td>23,73</td> </tr> </tbody> </table> <p>(*)Center-to-wall distance with valve Spacers always included. (**)Refer Fig. B for dimensions.</p>	D1	Part Number	G	L	L1	H	Th	C	B	3/4	2811 1152 81	G 3/4	3,65	4,72	3,33	0,59	1,37*	1,58	1	2811 2252 81	G 1	4,40	4,72	3,49	0,72	1,37*	2,33	1 1/2	2811 4452 81	G 1 1/2	8,03	6,22	5,85	-	2,77	4,32	2	2811 5552 81	G 2	6,94	6,22	6,14	1,02	2,77	6,15	2 1/2	2811 6652 80**	G 2 1/2	6,69	8,34	12,79	1,18	3,64	24,87	3	2811 7752 80**	G 3	7,40	8,34	13,34	1,33	3,93	23,73																		
D1	Part Number	G	L	L1	H	Th	C	Kg.																																																																																																																																											
20	2811 1152 81	G 3/4	92,8	120	86,7	15	35*	0,52																																																																																																																																											
25	2811 2252 81	G 1	111,9	120	88,7	18,5	35*	0,76																																																																																																																																											
40	2811 4452 81	G 1 1/2	204	158	148,5	-	70,3	1,96																																																																																																																																											
50	2811 5552 81	G 2	176,2	158	156	26	70,3	2,70																																																																																																																																											
63	2811 6652 80**	G 2 1/2	170	212	325	20	92,5	11,29																																																																																																																																											
80	2811 7752 80**	G 3	188	212	339	34	100	10,39																																																																																																																																											
D1	Part Number	G	L	L1	H	Th	C	B																																																																																																																																											
3/4	2811 1152 81	G 3/4	3,65	4,72	3,33	0,59	1,37*	1,58																																																																																																																																											
1	2811 2252 81	G 1	4,40	4,72	3,49	0,72	1,37*	2,33																																																																																																																																											
1 1/2	2811 4452 81	G 1 1/2	8,03	6,22	5,85	-	2,77	4,32																																																																																																																																											
2	2811 5552 81	G 2	6,94	6,22	6,14	1,02	2,77	6,15																																																																																																																																											
2 1/2	2811 6652 80**	G 2 1/2	6,69	8,34	12,79	1,18	3,64	24,87																																																																																																																																											
3	2811 7752 80**	G 3	7,40	8,34	13,34	1,33	3,93	23,73																																																																																																																																											
<p>53</p> <p>VALVES THREADED NPT</p>		<table border="1"> <thead> <tr> <th>D1</th> <th>Part Number</th> <th>NPT</th> <th>Th</th> <th>L</th> <th>L1</th> <th>H</th> <th>C</th> <th>Kg.</th> </tr> </thead> <tbody> <tr> <td>20</td> <td>2811 1253 81</td> <td>NPT 3/4</td> <td>16,6</td> <td>92,8</td> <td>120</td> <td>86,7</td> <td>35*</td> <td>0,52</td> </tr> <tr> <td>25</td> <td>2811 2253 81</td> <td>NPT 1</td> <td>21</td> <td>111,9</td> <td>120</td> <td>88,7</td> <td>35*</td> <td>0,76</td> </tr> <tr> <td>40</td> <td>2811 4453 81</td> <td>NPT 1 1/2</td> <td>23</td> <td>151,3</td> <td>158</td> <td>114</td> <td>70</td> <td>1,77</td> </tr> <tr> <td>50</td> <td>2811 5553 81</td> <td>NPT 2</td> <td>26,5</td> <td>176,2</td> <td>158</td> <td>130</td> <td>70</td> <td>3,03</td> </tr> <tr> <td>63</td> <td>2811 6653 80**</td> <td>NPT 2 1/2</td> <td>29</td> <td>170</td> <td>212</td> <td>326</td> <td>92,5</td> <td>11,17</td> </tr> <tr> <td>80</td> <td>2811 7753 80**</td> <td>NPT 3</td> <td>31</td> <td>190</td> <td>212</td> <td>339</td> <td>100</td> <td>11,11</td> </tr> </tbody> </table> <p>(*)Center-to-wall distance with valve Spacers always included. (**)Refer Fig. B for dimensions.</p>	D1	Part Number	NPT	Th	L	L1	H	C	Kg.	20	2811 1253 81	NPT 3/4	16,6	92,8	120	86,7	35*	0,52	25	2811 2253 81	NPT 1	21	111,9	120	88,7	35*	0,76	40	2811 4453 81	NPT 1 1/2	23	151,3	158	114	70	1,77	50	2811 5553 81	NPT 2	26,5	176,2	158	130	70	3,03	63	2811 6653 80**	NPT 2 1/2	29	170	212	326	92,5	11,17	80	2811 7753 80**	NPT 3	31	190	212	339	100	11,11	<table border="1"> <thead> <tr> <th>D1</th> <th>Part Number</th> <th>NPT</th> <th>Th</th> <th>L</th> <th>L1</th> <th>H</th> <th>C</th> <th>B</th> </tr> </thead> <tbody> <tr> <td>3/4</td> <td>2811 1253 81</td> <td>NPT 3/4</td> <td>0,265</td> <td>3,65</td> <td>4,72</td> <td>3,33</td> <td>1,37*</td> <td>1,58</td> </tr> <tr> <td>1</td> <td>2811 2253 81</td> <td>NPT 1</td> <td>0,82</td> <td>4,40</td> <td>4,72</td> <td>3,49</td> <td>1,37*</td> <td>2,33</td> </tr> <tr> <td>1 1/2</td> <td>2811 4453 81</td> <td>NPT 1 1/2</td> <td>0,91</td> <td>6</td> <td>6,22</td> <td>4,5</td> <td>2,75</td> <td>3,9</td> </tr> <tr> <td>2</td> <td>2811 5553 81</td> <td>NPT 2</td> <td>1,04</td> <td>7</td> <td>6,22</td> <td>5,12</td> <td>2,75</td> <td>6,68</td> </tr> <tr> <td>2 1/2</td> <td>2811 6653 80**</td> <td>NPT 2 1/2</td> <td>1,14</td> <td>6,69</td> <td>8,34</td> <td>12,83</td> <td>3,64</td> <td>24,87</td> </tr> <tr> <td>3</td> <td>2811 7753 80**</td> <td>NPT 3</td> <td>1,22</td> <td>7,48</td> <td>8,34</td> <td>13,34</td> <td>3,93</td> <td>24,44</td> </tr> </tbody> </table> <p>(*)Center-to-wall distance with valve Spacers always included. (**)Refer Fig. B for dimensions.</p>	D1	Part Number	NPT	Th	L	L1	H	C	B	3/4	2811 1253 81	NPT 3/4	0,265	3,65	4,72	3,33	1,37*	1,58	1	2811 2253 81	NPT 1	0,82	4,40	4,72	3,49	1,37*	2,33	1 1/2	2811 4453 81	NPT 1 1/2	0,91	6	6,22	4,5	2,75	3,9	2	2811 5553 81	NPT 2	1,04	7	6,22	5,12	2,75	6,68	2 1/2	2811 6653 80**	NPT 2 1/2	1,14	6,69	8,34	12,83	3,64	24,87	3	2811 7753 80**	NPT 3	1,22	7,48	8,34	13,34	3,93	24,44																		
D1	Part Number	NPT	Th	L	L1	H	C	Kg.																																																																																																																																											
20	2811 1253 81	NPT 3/4	16,6	92,8	120	86,7	35*	0,52																																																																																																																																											
25	2811 2253 81	NPT 1	21	111,9	120	88,7	35*	0,76																																																																																																																																											
40	2811 4453 81	NPT 1 1/2	23	151,3	158	114	70	1,77																																																																																																																																											
50	2811 5553 81	NPT 2	26,5	176,2	158	130	70	3,03																																																																																																																																											
63	2811 6653 80**	NPT 2 1/2	29	170	212	326	92,5	11,17																																																																																																																																											
80	2811 7753 80**	NPT 3	31	190	212	339	100	11,11																																																																																																																																											
D1	Part Number	NPT	Th	L	L1	H	C	B																																																																																																																																											
3/4	2811 1253 81	NPT 3/4	0,265	3,65	4,72	3,33	1,37*	1,58																																																																																																																																											
1	2811 2253 81	NPT 1	0,82	4,40	4,72	3,49	1,37*	2,33																																																																																																																																											
1 1/2	2811 4453 81	NPT 1 1/2	0,91	6	6,22	4,5	2,75	3,9																																																																																																																																											
2	2811 5553 81	NPT 2	1,04	7	6,22	5,12	2,75	6,68																																																																																																																																											
2 1/2	2811 6653 80**	NPT 2 1/2	1,14	6,69	8,34	12,83	3,64	24,87																																																																																																																																											
3	2811 7753 80**	NPT 3	1,22	7,48	8,34	13,34	3,93	24,44																																																																																																																																											
<p>54</p> <p>FLANGES</p>		<table border="1"> <thead> <tr> <th>D1</th> <th>Part Number</th> <th>D2</th> <th>L</th> <th>W</th> <th>Kg.</th> </tr> </thead> <tbody> <tr> <td>63 DIN</td> <td>2811 6054 80</td> <td>146</td> <td>82</td> <td>180</td> <td>1,04</td> </tr> <tr> <td>63 ANSI</td> <td>2811 6154 80</td> <td>139,7</td> <td>127</td> <td>180</td> <td>4,14</td> </tr> <tr> <td>80 DIN</td> <td>2811 7054 80</td> <td>160</td> <td>101</td> <td>200</td> <td>1,57</td> </tr> <tr> <td>80 ANSI</td> <td>2811 7154 80</td> <td>152,4</td> <td>134</td> <td>190</td> <td>5,2</td> </tr> <tr> <td>100 DIN</td> <td>2810 8154 00*</td> <td>180</td> <td>132</td> <td>220</td> <td>2,57</td> </tr> <tr> <td>100 ANSI</td> <td>2810 8254 00*</td> <td>190,5</td> <td>133</td> <td>226,6</td> <td>2,74</td> </tr> <tr> <td>150 DIN/ANSI</td> <td>2810 9154 00*</td> <td>240</td> <td>132</td> <td>285</td> <td>5,34</td> </tr> </tbody> </table> <p>(**)Refer Fig. B for dimensions.</p>	D1	Part Number	D2	L	W	Kg.	63 DIN	2811 6054 80	146	82	180	1,04	63 ANSI	2811 6154 80	139,7	127	180	4,14	80 DIN	2811 7054 80	160	101	200	1,57	80 ANSI	2811 7154 80	152,4	134	190	5,2	100 DIN	2810 8154 00*	180	132	220	2,57	100 ANSI	2810 8254 00*	190,5	133	226,6	2,74	150 DIN/ANSI	2810 9154 00*	240	132	285	5,34	<table border="1"> <thead> <tr> <th>D1</th> <th>Part Number</th> <th>D2</th> <th>L</th> <th>W</th> <th>B</th> </tr> </thead> <tbody> <tr> <td>2 1/2" DIN</td> <td>2811 6054 80</td> <td>5,70</td> <td>3,22</td> <td>7,28</td> <td>2,28</td> </tr> <tr> <td>2 1/2" ANSI</td> <td>2811 6154 80</td> <td>5,5</td> <td>5</td> <td>7,08</td> <td>9,55</td> </tr> <tr> <td>3" DIN</td> <td>2811 7054 80</td> <td>6,3</td> <td>3,97</td> <td>7,87</td> <td>2,45</td> </tr> <tr> <td>3" ANSI</td> <td>2811 7154 80</td> <td>6</td> <td>5,27</td> <td>7,48</td> <td>11,44</td> </tr> <tr> <td>4" DIN</td> <td>2810 8154 00*</td> <td>7,08</td> <td>5,19</td> <td>8,66</td> <td>5,65</td> </tr> <tr> <td>4" ANSI</td> <td>2810 8254 00*</td> <td>7,5</td> <td>5,19</td> <td>9</td> <td>6,05</td> </tr> <tr> <td>6" DIN/ANSI</td> <td>2810 9154 00*</td> <td>9,44</td> <td>5,19</td> <td>11,22</td> <td>11,78</td> </tr> </tbody> </table> <p>(**)Refer Fig. B for dimensions.</p>	D1	Part Number	D2	L	W	B	2 1/2" DIN	2811 6054 80	5,70	3,22	7,28	2,28	2 1/2" ANSI	2811 6154 80	5,5	5	7,08	9,55	3" DIN	2811 7054 80	6,3	3,97	7,87	2,45	3" ANSI	2811 7154 80	6	5,27	7,48	11,44	4" DIN	2810 8154 00*	7,08	5,19	8,66	5,65	4" ANSI	2810 8254 00*	7,5	5,19	9	6,05	6" DIN/ANSI	2810 9154 00*	9,44	5,19	11,22	11,78																																																
D1	Part Number	D2	L	W	Kg.																																																																																																																																														
63 DIN	2811 6054 80	146	82	180	1,04																																																																																																																																														
63 ANSI	2811 6154 80	139,7	127	180	4,14																																																																																																																																														
80 DIN	2811 7054 80	160	101	200	1,57																																																																																																																																														
80 ANSI	2811 7154 80	152,4	134	190	5,2																																																																																																																																														
100 DIN	2810 8154 00*	180	132	220	2,57																																																																																																																																														
100 ANSI	2810 8254 00*	190,5	133	226,6	2,74																																																																																																																																														
150 DIN/ANSI	2810 9154 00*	240	132	285	5,34																																																																																																																																														
D1	Part Number	D2	L	W	B																																																																																																																																														
2 1/2" DIN	2811 6054 80	5,70	3,22	7,28	2,28																																																																																																																																														
2 1/2" ANSI	2811 6154 80	5,5	5	7,08	9,55																																																																																																																																														
3" DIN	2811 7054 80	6,3	3,97	7,87	2,45																																																																																																																																														
3" ANSI	2811 7154 80	6	5,27	7,48	11,44																																																																																																																																														
4" DIN	2810 8154 00*	7,08	5,19	8,66	5,65																																																																																																																																														
4" ANSI	2810 8254 00*	7,5	5,19	9	6,05																																																																																																																																														
6" DIN/ANSI	2810 9154 00*	9,44	5,19	11,22	11,78																																																																																																																																														

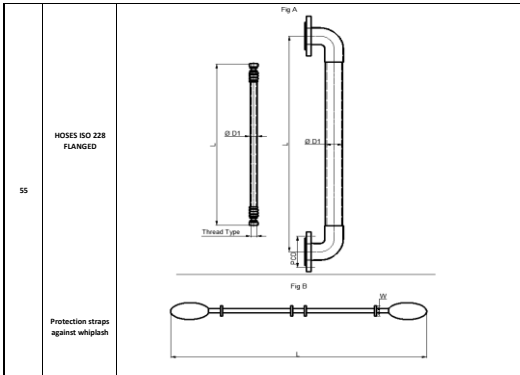

D1	Part Number	L	Angularity	Connection Type	Thread/Dia	Kg.
20	2810 1055 00	750	Straight	Threaded	G 3/4	0,06
20	2810 1155 00	1500	Straight	Threaded	G 3/4	0,06
25	2810 2055 00	750	Straight	Threaded	G 1	0,43
25	2810 2155 00	1500	Straight	Threaded	G 1	0,81
40	2810 4055 00	1000	U-shaped	Threaded	G 1 1/2	0,95
40	2810 4155 00	1500	Straight	Threaded	G 1 1/2	1,33
50	2810 5055 00	1000	U-shaped	Threaded	G 2	1,24
50	2810 5155 00	1500	Straight	Threaded	G 2	1,69
63	2810 6055 00	1000	U-shaped	Flanged	145	2,12
63	2810 6155 00	1500	Straight	Flanged	145	2,77
80	2810 7055 00	1000	U-shaped	Flanged	160	2,86
80	2810 7155 00	1500	Straight	Flanged	160	3,23

Refer Fig. A for dimensions

D1	Part Number	L	W	Kg.
20-25	2810 0055 01	55	18,3	0,08
40-50-63-80	2810 0055 01	100	27,9	0,46

Refer Fig. B for dimensions

D1	Part Number	L	Angularity	Connection Type	Thread/Dia	lb
1/2	2810 1055 00	29,5	Straight	Threaded	G 1/2	0,14
1/2	2810 1155 00	59	Straight	Threaded	G 1/2	0,14
1	2810 2055 00	29,5	Straight	Threaded	G 1	0,94
1	2810 2155 00	59	Straight	Threaded	G 1	1,77
1 1/2	2810 4055 00	39,37	U-shaped	Threaded	G 1 1/2	2,09
1 1/2	2810 4155 00	59	Straight	Threaded	G 1 1/2	2,92
2	2810 5055 00	39,37	U-shaped	Threaded	G 2	2,22
2	2810 5155 00	59	Straight	Threaded	G 2	3,71
2 1/2	2810 6055 00	39,37	U-shaped	Flanged	5,71	4,67
2 1/2	2810 6155 00	59	Straight	Flanged	5,71	6,11
3 1/2	2810 7055 00	39,37	U-shaped	Flanged	6,3	6,3
3 1/2	2810 7155 00	59	Straight	Flanged	6,3	7,12

Refer Fig. A for dimensions

D1	Part Number	L	W	lb.
1/2-1	2810 0055 00	2,16	0,72	0,17
1 1/2-2-2 1/2-3 1/2	2810 0055 01	3,93	1,09	1,01

Refer Fig. B for dimensions

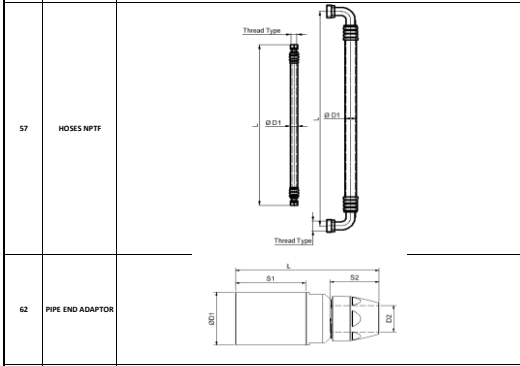

D1	Part Number	L	Angularity	Connection Type	Thread/TPI	Kg.
20	2810 1057 00	750	Straight	Threaded	NPTF 1/4-14	0,06
20	2810 1157 00	1500	Straight	Threaded	NPTF 1/4-14	0,06
25	2810 2057 00	750	Straight	Threaded	NPTF 1-11,5	0,43
25	2810 2157 00	1500	Straight	Threaded	NPTF 1-11,5	0,81
40	2810 4057 00	1000	U-Shaped	Threaded	NPTF 1 1/2-11,5	0,95
40	2810 4157 00	1500	Straight	Threaded	NPTF 1 1/2-11,5	1,33
50	2810 5057 00	1000	U-Shaped	Threaded	NPTF 2-11,5	1,24
50	2810 5157 00	1500	Straight	Threaded	NPTF 2-11,5	1,69

D1	Part Number	S1	D2	S2	L	Kg.
63	2811 6462 80	78,5	63	169,5	0,42	
80	2811 7462 80	96,8	40	63	198,1	0,87
80	2811 7562 80	96,8	50	78,1	202,2	0,84

D1	Part Number	L	Angularity	Connection Type	Thread/TPI	lb
1/2	2810 1057 00	29,5	Straight	Threaded	NPTF 1/4-14	0,14
1/2	2810 1157 00	59	Straight	Threaded	NPTF 1/4-14	0,14
1	2810 2057 00	29,5	Straight	Threaded	NPTF 1-11,5	0,94
1	2810 2157 00	59	Straight	Threaded	NPTF 1-11,5	1,77
1 1/2	2810 4057 00	39,37	U-Shaped	Threaded	NPTF 1 1/2-11,5	2,09
1 1/2	2810 4157 00	59	Straight	Threaded	NPTF 1 1/2-11,5	2,92
2	2810 5057 00	39,37	U-Shaped	Threaded	NPTF 2-11,5	2,22
2	2810 5157 00	59	Straight	Threaded	NPTF 2-11,5	3,71

D1	Part Number	S1	D2	S2	L	lb
2 1/2	2811 6462 80	3,09	1 1/2	2,48	6,67	0,93
3	2811 7462 80	3,81	1 1/2	2,48	7,80	1,92
3	2811 7562 80	3,81	2	3,07	8,00	1,85

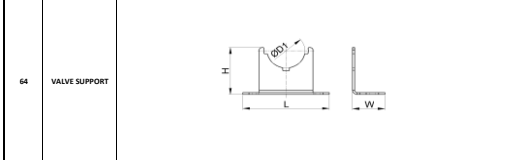

D1	Part Number	QTY	L	H	W	Kg.
20	2810 0001 39	1	96	45	47,5	0,11
25	2810 0002 39	1	97	47	49,6	0,12
40	2811 4064 00	1	126	75	47	0,21
50	2811 5064 00	1	138	76,5	47	0,23
63	2810 0006 38	1	150	95	60	0,62
80	2810 0007 38	1	160	90	60	0,62
100	2810 0008 00	1	225	140	60	1,03
158	2810 9064 00	1	220	150	70	1,09

D1	Part Number	QTY	L	H	W	lb
1/2	2810 0001 39	1	3,77	1,77	1,87	0,24
1	2810 0002 39	1	3,81	1,85	1,94	0,25
1 1/2	2811 4064 00	1	5	3	1,85	0,47
2 1/2	2811 5064 00	1	5,5	3	1,85	0,51
3	2810 0006 38	1	5,91	3,75	2,36	1,36
4	2810 0007 38	1	6,3	3,54	2,36	1,36
6	2810 0008 00	1	8,86	5,5	2,36	2,27
6	2810 9064 00	1	8,66	5,9	2,75	2,39

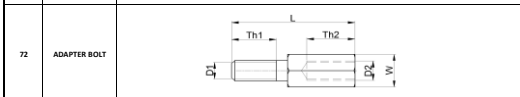

Part Number	D1	QTY	Th1	D2	Th2	L	W	Kg.
2811 0072 00	M6	1	15	M8	17,5	45	16	0,04
2811 0172 00	1/4" UNC	1	15	3/8" UNC	21,5	50	16	0,05
2811 0272 00	5/16" UNC	1	15	3/8" UNC	21,5	50	16	0,05
2811 0372 00	M10	1	20	3/8" UNC	21,5	50	16	0,06

Part Number	D1	QTY	Th1	D2	Th2	L	W	lb
2811 0072 00	M6	1	0,59	M8	0,68	1,77	0,62	0,09
2811 0172 00	1/4" UNC	1	0,59	3/8" UNC	0,84	1,96	0,62	0,11
2811 0272 00	5/16" UNC	1	0,59	3/8" UNC	0,84	1,96	0,62	0,11
2811 0372 00	M10	1	0,78	3/8" UNC	0,84	2,16	0,62	0,13

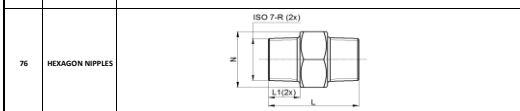

ISO 7-R	Part Number	QTY	L	L1	N	Kg.
1/2	2811 0076 00	1	44	18	27	0,68
3/4	2811 1176 00	1	47	16,3	32	0,11
1	2811 2276 00	1	53	19	41	0,23
1 1/2	2811 4476 00	1	59	25	55	0,30
2	2811 5576 00	1	68	25,7	70	0,64

ISO 7-R	Part Number	QTY	L	L1	N	lb
1/2	2811 0076 00	1	1,73	0,70	1,06	0,17
3/4	2811 1176 00	1	1,85	0,64	1,25	0,24
1	2811 2276 00	1	2,08	0,74	1,61	0,51
1 1/2	2811 4476 00	1	2,32	0,98	2,16	0,67
2	2811 5576 00	1	2,67	1,01	2,75	1,41

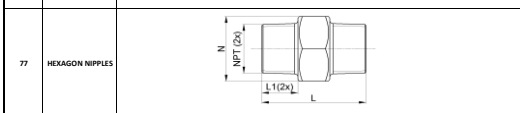

NPT	Part Number	QTY	L	L1	N	Kg
1/2	2811 0077 00	1	48	20	27	0,07
3/4	2811 1177 00	1	50	16	30	0,14
1	2811 2277 00	1	58	21,5	35	0,20
1 1/2	2811 4477 00	1	68	18	50	0,37
2	2811 5577 00	1	71	19	62	0,58

ISO 7-R	Part Number	QTY	L	L1	N	lb
1/2	2811 0076 00	1	1,88	0,78	1,06	0,15
3/4	2811 1176 00	1	1,96	0,62	1,25	0,21
1	2811 2276 00	1	2,28	0,84	1,37	0,44
1 1/2	2811 4476 00	1	2,67	0,70	1,96	0,81
2	2811 5576 00	1	2,79	0,74	2,44	1,28

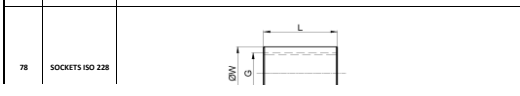

G	Part Number	QTY	L	W	Kg
1/2	2811 0078 00	1	34	27	0,09
3/4	2811 1178 00	1	36	35	0,15
1	2811 2278 00	1	43	40,5	0,20
1 1/2	2811 3378 00	1	48	48,5	0,26

G	Part Number	QTY	L	W	lb
1/2	2811 0078 00	1	1,33	1,06	0,19
3/4	2811 1178 00	1	1,44	1,37	0,34
1	2811 2278 00	1	1,69	1,59	0,45
1 1/2	2811 3378 00	1	1,88	1,90	0,58



1%	2811 4478 00	1	48	54,5	0,30
2	2811 5578 00	1	56	66,5	0,44

1%	2811 4478 00	1	1,88	2,14	0,66
2	2811 5578 00	1	2,20	2,61	0,98

79	SOCKETS NPT		<table border="1"> <thead> <tr> <th>NPT</th> <th>Part Number</th> <th>QTY</th> <th>Th</th> <th>L</th> <th>W</th> <th>Kg</th> </tr> </thead> <tbody> <tr> <td>1/2</td> <td>2811 0079 00</td> <td>1</td> <td>16</td> <td>36</td> <td>27</td> <td>0,09</td> </tr> <tr> <td>3/4</td> <td>2811 1179 00</td> <td>1</td> <td>20,2</td> <td>44,5</td> <td>32</td> <td>0,13</td> </tr> <tr> <td>1</td> <td>2811 2279 00</td> <td>1</td> <td>25</td> <td>54</td> <td>39,5</td> <td>0,22</td> </tr> <tr> <td>1 1/4</td> <td>2811 3379 00</td> <td>1</td> <td>35,6</td> <td>68,5</td> <td>55,5</td> <td>0,29</td> </tr> <tr> <td>1 1/2</td> <td>2811 4479 00</td> <td>1</td> <td>26</td> <td>54,5</td> <td>56</td> <td>0,34</td> </tr> <tr> <td>2</td> <td>2811 5579 00</td> <td>1</td> <td>26,9</td> <td>58</td> <td>66,5</td> <td>0,43</td> </tr> </tbody> </table>	NPT	Part Number	QTY	Th	L	W	Kg	1/2	2811 0079 00	1	16	36	27	0,09	3/4	2811 1179 00	1	20,2	44,5	32	0,13	1	2811 2279 00	1	25	54	39,5	0,22	1 1/4	2811 3379 00	1	35,6	68,5	55,5	0,29	1 1/2	2811 4479 00	1	26	54,5	56	0,34	2	2811 5579 00	1	26,9	58	66,5	0,43	<table border="1"> <thead> <tr> <th>NPT</th> <th>Part Number</th> <th>QTY</th> <th>Th</th> <th>L</th> <th>W</th> <th>lb</th> </tr> </thead> <tbody> <tr> <td>1/2</td> <td>2811 0079 00</td> <td>1</td> <td>0,62</td> <td>1,41</td> <td>1,06</td> <td>0,19</td> </tr> <tr> <td>3/4</td> <td>2811 1179 00</td> <td>1</td> <td>0,79</td> <td>1,75</td> <td>1,25</td> <td>0,28</td> </tr> <tr> <td>1</td> <td>2811 2279 00</td> <td>1</td> <td>0,98</td> <td>2,12</td> <td>1,55</td> <td>0,49</td> </tr> <tr> <td>1 1/4</td> <td>2811 3379 00</td> <td>1</td> <td>1,00</td> <td>1,90</td> <td>2,18</td> <td>0,65</td> </tr> <tr> <td>1 1/2</td> <td>2811 4479 00</td> <td>1</td> <td>1,02</td> <td>2,14</td> <td>2,20</td> <td>0,74</td> </tr> <tr> <td>2</td> <td>2811 5579 00</td> <td>1</td> <td>1,05</td> <td>2,28</td> <td>2,61</td> <td>0,95</td> </tr> </tbody> </table>	NPT	Part Number	QTY	Th	L	W	lb	1/2	2811 0079 00	1	0,62	1,41	1,06	0,19	3/4	2811 1179 00	1	0,79	1,75	1,25	0,28	1	2811 2279 00	1	0,98	2,12	1,55	0,49	1 1/4	2811 3379 00	1	1,00	1,90	2,18	0,65	1 1/2	2811 4479 00	1	1,02	2,14	2,20	0,74	2	2811 5579 00	1	1,05	2,28	2,61	0,95
NPT	Part Number	QTY	Th	L	W	Kg																																																																																																
1/2	2811 0079 00	1	16	36	27	0,09																																																																																																
3/4	2811 1179 00	1	20,2	44,5	32	0,13																																																																																																
1	2811 2279 00	1	25	54	39,5	0,22																																																																																																
1 1/4	2811 3379 00	1	35,6	68,5	55,5	0,29																																																																																																
1 1/2	2811 4479 00	1	26	54,5	56	0,34																																																																																																
2	2811 5579 00	1	26,9	58	66,5	0,43																																																																																																
NPT	Part Number	QTY	Th	L	W	lb																																																																																																
1/2	2811 0079 00	1	0,62	1,41	1,06	0,19																																																																																																
3/4	2811 1179 00	1	0,79	1,75	1,25	0,28																																																																																																
1	2811 2279 00	1	0,98	2,12	1,55	0,49																																																																																																
1 1/4	2811 3379 00	1	1,00	1,90	2,18	0,65																																																																																																
1 1/2	2811 4479 00	1	1,02	2,14	2,20	0,74																																																																																																
2	2811 5579 00	1	1,05	2,28	2,61	0,95																																																																																																
90	CONDUCTIVITY STRIPS		<table border="1"> <thead> <tr> <th>Part Number</th> <th>D1</th> <th>Fitting Type</th> <th>Fig</th> <th>Kg</th> </tr> </thead> <tbody> <tr> <td>2811 1002 90</td> <td>20/25</td> <td>Equal Socket</td> <td>10 x A</td> <td>0,02</td> </tr> <tr> <td>2811 1003 90</td> <td>20</td> <td>Elbow 90°</td> <td>5 x C</td> <td>0,01</td> </tr> <tr> <td>2811 1004 90</td> <td>20</td> <td>Elbow 45°</td> <td>5 x D</td> <td>0,01</td> </tr> <tr> <td>2811 1005 90</td> <td>20</td> <td>Tee</td> <td>10 x C + 5 x A</td> <td>0,03</td> </tr> <tr> <td>2811 2003 90</td> <td>25</td> <td>Elbow 90°</td> <td>5 x A</td> <td>0,01</td> </tr> <tr> <td>2811 2004 90</td> <td>25</td> <td>Elbow 45°</td> <td>5 x C</td> <td>0,01</td> </tr> <tr> <td>2811 2005 90</td> <td>25</td> <td>Tee</td> <td>5 x D</td> <td>0,01</td> </tr> </tbody> </table>	Part Number	D1	Fitting Type	Fig	Kg	2811 1002 90	20/25	Equal Socket	10 x A	0,02	2811 1003 90	20	Elbow 90°	5 x C	0,01	2811 1004 90	20	Elbow 45°	5 x D	0,01	2811 1005 90	20	Tee	10 x C + 5 x A	0,03	2811 2003 90	25	Elbow 90°	5 x A	0,01	2811 2004 90	25	Elbow 45°	5 x C	0,01	2811 2005 90	25	Tee	5 x D	0,01	<table border="1"> <thead> <tr> <th>Part Number</th> <th>D1</th> <th>Fitting Type</th> <th>Fig</th> <th>lb</th> </tr> </thead> <tbody> <tr> <td>2811 1002 90</td> <td>20/25</td> <td>Equal Socket</td> <td>10 x A</td> <td>0,044</td> </tr> <tr> <td>2811 1003 90</td> <td>20</td> <td>Elbow 90°</td> <td>5 x C</td> <td>0,022</td> </tr> <tr> <td>2811 1004 90</td> <td>20</td> <td>Elbow 45°</td> <td>5 x D</td> <td>0,022</td> </tr> <tr> <td>2811 1005 90</td> <td>20</td> <td>Tee</td> <td>10 x C + 5 x A</td> <td>0,066</td> </tr> <tr> <td>2811 2003 90</td> <td>25</td> <td>Elbow 90°</td> <td>5 x A</td> <td>0,022</td> </tr> <tr> <td>2811 2004 90</td> <td>25</td> <td>Elbow 45°</td> <td>5 x C</td> <td>0,022</td> </tr> <tr> <td>2811 2005 90</td> <td>25</td> <td>Tee</td> <td>5 x D</td> <td>0,022</td> </tr> </tbody> </table>	Part Number	D1	Fitting Type	Fig	lb	2811 1002 90	20/25	Equal Socket	10 x A	0,044	2811 1003 90	20	Elbow 90°	5 x C	0,022	2811 1004 90	20	Elbow 45°	5 x D	0,022	2811 1005 90	20	Tee	10 x C + 5 x A	0,066	2811 2003 90	25	Elbow 90°	5 x A	0,022	2811 2004 90	25	Elbow 45°	5 x C	0,022	2811 2005 90	25	Tee	5 x D	0,022																		
Part Number	D1	Fitting Type	Fig	Kg																																																																																																		
2811 1002 90	20/25	Equal Socket	10 x A	0,02																																																																																																		
2811 1003 90	20	Elbow 90°	5 x C	0,01																																																																																																		
2811 1004 90	20	Elbow 45°	5 x D	0,01																																																																																																		
2811 1005 90	20	Tee	10 x C + 5 x A	0,03																																																																																																		
2811 2003 90	25	Elbow 90°	5 x A	0,01																																																																																																		
2811 2004 90	25	Elbow 45°	5 x C	0,01																																																																																																		
2811 2005 90	25	Tee	5 x D	0,01																																																																																																		
Part Number	D1	Fitting Type	Fig	lb																																																																																																		
2811 1002 90	20/25	Equal Socket	10 x A	0,044																																																																																																		
2811 1003 90	20	Elbow 90°	5 x C	0,022																																																																																																		
2811 1004 90	20	Elbow 45°	5 x D	0,022																																																																																																		
2811 1005 90	20	Tee	10 x C + 5 x A	0,066																																																																																																		
2811 2003 90	25	Elbow 90°	5 x A	0,022																																																																																																		
2811 2004 90	25	Elbow 45°	5 x C	0,022																																																																																																		
2811 2005 90	25	Tee	5 x D	0,022																																																																																																		
90	CONDUCTIVITY STRIPS		<table border="1"> <thead> <tr> <th>Part Number</th> <th>D1</th> <th>Fitting Type</th> <th>Fig</th> <th>Kg</th> </tr> </thead> <tbody> <tr> <td>2811 4002 90</td> <td>40</td> <td>Equal Socket</td> <td>10 x A</td> <td>0,03</td> </tr> <tr> <td>2811 4003 90</td> <td>40</td> <td>Elbow 90°</td> <td>5 x C</td> <td>0,01</td> </tr> <tr> <td>2811 4004 90</td> <td>40</td> <td>Elbow 45°</td> <td>5 x D</td> <td>0,01</td> </tr> <tr> <td>2811 4005 90</td> <td>40</td> <td>Tee</td> <td>10 x C + 5 x B</td> <td>0,035</td> </tr> <tr> <td>2811 5002 90</td> <td>50</td> <td>Equal Socket</td> <td>10 x A</td> <td>0,03</td> </tr> <tr> <td>2811 5003 90</td> <td>50</td> <td>Elbow 90°</td> <td>5 x C</td> <td>0,015</td> </tr> <tr> <td>2811 5004 90</td> <td>50</td> <td>Elbow 45°</td> <td>5 x D</td> <td>0,015</td> </tr> <tr> <td>2811 5005 90</td> <td>50</td> <td>Tee</td> <td>10 x C + 5 x B</td> <td>0,045</td> </tr> </tbody> </table>	Part Number	D1	Fitting Type	Fig	Kg	2811 4002 90	40	Equal Socket	10 x A	0,03	2811 4003 90	40	Elbow 90°	5 x C	0,01	2811 4004 90	40	Elbow 45°	5 x D	0,01	2811 4005 90	40	Tee	10 x C + 5 x B	0,035	2811 5002 90	50	Equal Socket	10 x A	0,03	2811 5003 90	50	Elbow 90°	5 x C	0,015	2811 5004 90	50	Elbow 45°	5 x D	0,015	2811 5005 90	50	Tee	10 x C + 5 x B	0,045	<table border="1"> <thead> <tr> <th>Part Number</th> <th>D1</th> <th>Fitting Type</th> <th>Fig</th> <th>lb</th> </tr> </thead> <tbody> <tr> <td>2811 4002 90</td> <td>40</td> <td>Equal Socket</td> <td>10 x A</td> <td>0,066</td> </tr> <tr> <td>2811 4003 90</td> <td>40</td> <td>Elbow 90°</td> <td>5 x C</td> <td>0,022</td> </tr> <tr> <td>2811 4004 90</td> <td>40</td> <td>Elbow 45°</td> <td>5 x D</td> <td>0,022</td> </tr> <tr> <td>2811 4005 90</td> <td>40</td> <td>Tee</td> <td>10 x C + 5 x B</td> <td>0,077</td> </tr> <tr> <td>2811 5002 90</td> <td>50</td> <td>Equal Socket</td> <td>10 x A</td> <td>0,066</td> </tr> <tr> <td>2811 5003 90</td> <td>50</td> <td>Elbow 90°</td> <td>5 x C</td> <td>0,033</td> </tr> <tr> <td>2811 5004 90</td> <td>50</td> <td>Elbow 45°</td> <td>5 x D</td> <td>0,033</td> </tr> <tr> <td>2811 5005 90</td> <td>50</td> <td>Tee</td> <td>10 x C + 5 x B</td> <td>0,099</td> </tr> </tbody> </table>	Part Number	D1	Fitting Type	Fig	lb	2811 4002 90	40	Equal Socket	10 x A	0,066	2811 4003 90	40	Elbow 90°	5 x C	0,022	2811 4004 90	40	Elbow 45°	5 x D	0,022	2811 4005 90	40	Tee	10 x C + 5 x B	0,077	2811 5002 90	50	Equal Socket	10 x A	0,066	2811 5003 90	50	Elbow 90°	5 x C	0,033	2811 5004 90	50	Elbow 45°	5 x D	0,033	2811 5005 90	50	Tee	10 x C + 5 x B	0,099								
Part Number	D1	Fitting Type	Fig	Kg																																																																																																		
2811 4002 90	40	Equal Socket	10 x A	0,03																																																																																																		
2811 4003 90	40	Elbow 90°	5 x C	0,01																																																																																																		
2811 4004 90	40	Elbow 45°	5 x D	0,01																																																																																																		
2811 4005 90	40	Tee	10 x C + 5 x B	0,035																																																																																																		
2811 5002 90	50	Equal Socket	10 x A	0,03																																																																																																		
2811 5003 90	50	Elbow 90°	5 x C	0,015																																																																																																		
2811 5004 90	50	Elbow 45°	5 x D	0,015																																																																																																		
2811 5005 90	50	Tee	10 x C + 5 x B	0,045																																																																																																		
Part Number	D1	Fitting Type	Fig	lb																																																																																																		
2811 4002 90	40	Equal Socket	10 x A	0,066																																																																																																		
2811 4003 90	40	Elbow 90°	5 x C	0,022																																																																																																		
2811 4004 90	40	Elbow 45°	5 x D	0,022																																																																																																		
2811 4005 90	40	Tee	10 x C + 5 x B	0,077																																																																																																		
2811 5002 90	50	Equal Socket	10 x A	0,066																																																																																																		
2811 5003 90	50	Elbow 90°	5 x C	0,033																																																																																																		
2811 5004 90	50	Elbow 45°	5 x D	0,033																																																																																																		
2811 5005 90	50	Tee	10 x C + 5 x B	0,099																																																																																																		
91	CONDUCTIVITY STRIPS		<table border="1"> <thead> <tr> <th>Part Number</th> <th>D1</th> <th>Kg</th> </tr> </thead> <tbody> <tr> <td>2810 0191 00</td> <td>20-150</td> <td>0,009</td> </tr> </tbody> </table>	Part Number	D1	Kg	2810 0191 00	20-150	0,009	<table border="1"> <thead> <tr> <th>Part Number</th> <th>D1</th> <th>lb</th> </tr> </thead> <tbody> <tr> <td>2810 0191 00</td> <td>4,4</td> <td>0,19</td> </tr> </tbody> </table>	Part Number	D1	lb	2810 0191 00	4,4	0,19																																																																																						
Part Number	D1	Kg																																																																																																				
2810 0191 00	20-150	0,009																																																																																																				
Part Number	D1	lb																																																																																																				
2810 0191 00	4,4	0,19																																																																																																				